

REVISIONS	
A	CO-73751 S A V 16 OCT 92
B	C080111 J A K 21 MAR 95
C	PR23547 J A S 6 AUG 98
D	C095297 G J W 7 JUL 99

MICRO SWITCH
a Honeywell Division
FED. MFG. CODE 91929

SWITCH — ENCLOSED

CATALOG LISTING
11CX 12CX
SERIES CHART 1

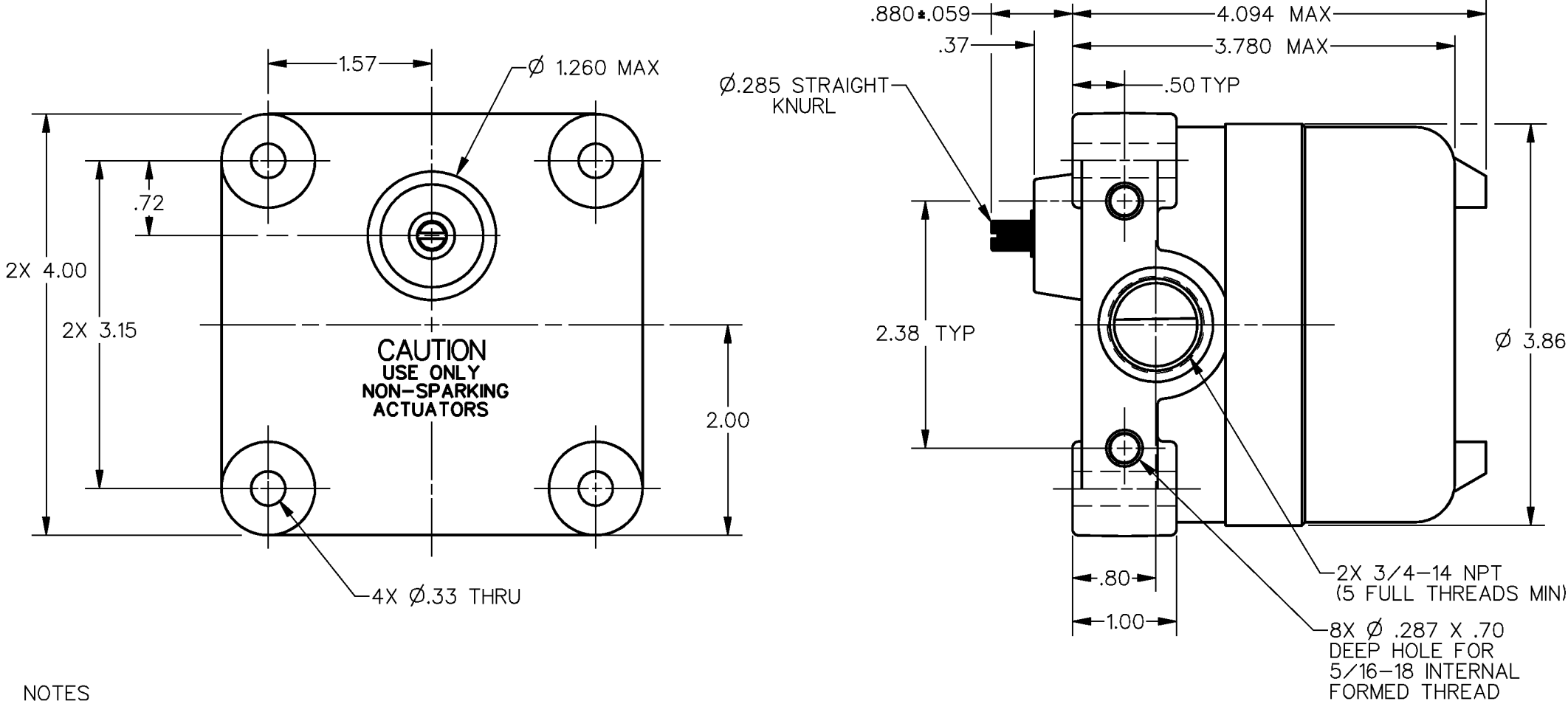

- NOTES
- 1 — EXPLOSION PROOF—UNDERWRITERS LAB INC LISTING FOR HAZARDOUS LOCATIONS CLASS 1, GROUPS C AND D; CLASS 2, GROUPS E, F, AND G
 - 2 — ALUMINIUM ENCLOSURE FINISHED WITH BLUE AND BLACK EPOXY PAINT
 - 3 — 6-32 UNC X (.312) PAN HEAD TERMINAL SCREW AND LOCKWASHER (SEMS TERMI-LOX) (3 PER BASIC)
 - 4 — CAMS MAY BE REPOSITIONED IN 7°20' INCREMENTS
 - 5 — FOR USE IN TEMPERATURES UP TO 85°C
 - 6 — SEE 7CX CHARTS 1 AND 2 (M DRAWING) FOR LEVER ACTUATORS

ANSI Y14.5M-1982 APPLIES

THIS DRAWING COVERS A PROPRIETARY ITEM AND IS THE PROPERTY OF MICRO SWITCH, A DIVISION OF HONEYWELL. THIS DRAWING IS NOT TO BE COPIED OR USED WITHOUT THE APPROVAL OF MICRO SWITCH		THIRD ANGLE PROJECTION	
CHARACTERISTICS	ELECTRICAL DATA	SCALE .75:1	DO NOT SCALE PRINT
OPERATING FORCE — — — .922 LB FT MAX	CONTACT ARRANGEMENT S P D T (EACH BASIC)	UNLESS OTHERWISE SPECIFIED TOLERANCES ARE	
RELEASE FORCE — — — .083 LB FT MIN		ONE PLACE (.0) ±.030	
PRETRAVEL — — — — — 15° MAX		TWO PLACE (.00) ±.015	
DIFFERENTIAL TRAVEL — — — 10° MAX		THREE PLACE (.000) ±.005	
OVERTRAVEL — — — — — 90° MIN		ANGLES ±	
		WEIGHT 2.49 LB APPROX	

CONVERSION CHART	
7,25	.285
7,29	.287
7,92	.312
8,5	.33
9,4	.37
12,7	.50
17,8	.70
18,3	.72
20,3	.80
22,3±1,5	.880±.050
25,4	1.00
32,00 MAX	1.260 MAX
40,0	1.57
50,8	2.00
60,4	2.38
80,0	3.15
96,00 MAX	3.780 MAX
98,0	3.86
101,6	4.00
104,00 MAX	4.094 MAX
1,25 Nm	.922 PF
0,113 Nm	.083 PF
1,13 Kg	2.49 LB

CATALOG LISTING	DESCRIPTION	ELECTRICAL DATA
11CX1	1 BASIC; OPERATES CLOCKWISE & COUNTER CLOCKWISE	L96 15A 125, 250 OR 480 VAC 1/8HP 125 VAC, 1/4HP 250 VAC 1/2A 125 VDC, 1/4A 250 VDC UL CE
11CX1C	1 BASIC; OPERATES CLOCKWISE & COUNTER CLOCKWISE	
11CX2	2 BASICS; EACH OPERATES CLOCKWISE & COUNTER CLOCKWISE	
1172CX-2	2 BASICS; EACH OPERATES CLOCKWISE & COUNTER CLOCKWISE	L22 1A 125 VAC UL CE
12CX1	1 BASIC; OPERATES CLOCKWISE & COUNTER CLOCKWISE	L23 20A 125, 250 OR 480 VAC 10A 125 VAC "L" 1HP 125 VAC, 2HP 250 VAC 1/2A 125 VDC, 1/4A 250 VDC UL CE
12CX2	2 BASICS; EACH OPERATES CLOCKWISE & COUNTER CLOCKWISE	
12CX5	2 BASICS; 1 OPERATES CLOCKWISE ONLY; 1 OPERATES COUNTER CLOCKWISE ONLY	

Mouser Electronics

Authorized Distributor

Click to View Pricing, Inventory, Delivery & Lifecycle Information:

[Honeywell:](#)

[11CX1](#) [11CX1C](#) [11CX2](#) [12CX1](#) [12CX2](#) [12CX5](#)