

DRAWING FOR REFERENCE: This is subject to change without notice
05/31/2013

CABLE ASSEMBLY TOOL

FOR SOLDERING : HRM-200/SO-MD

FOR PRESS FITTING : HRM-200-JBN/CV-MD

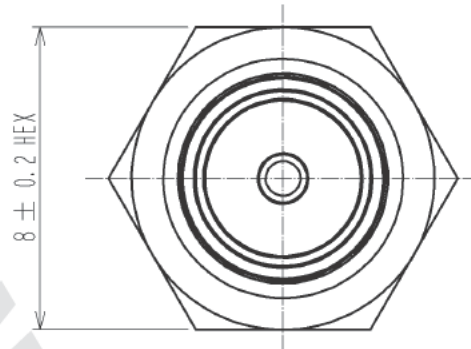

1/4-36UNS-2A

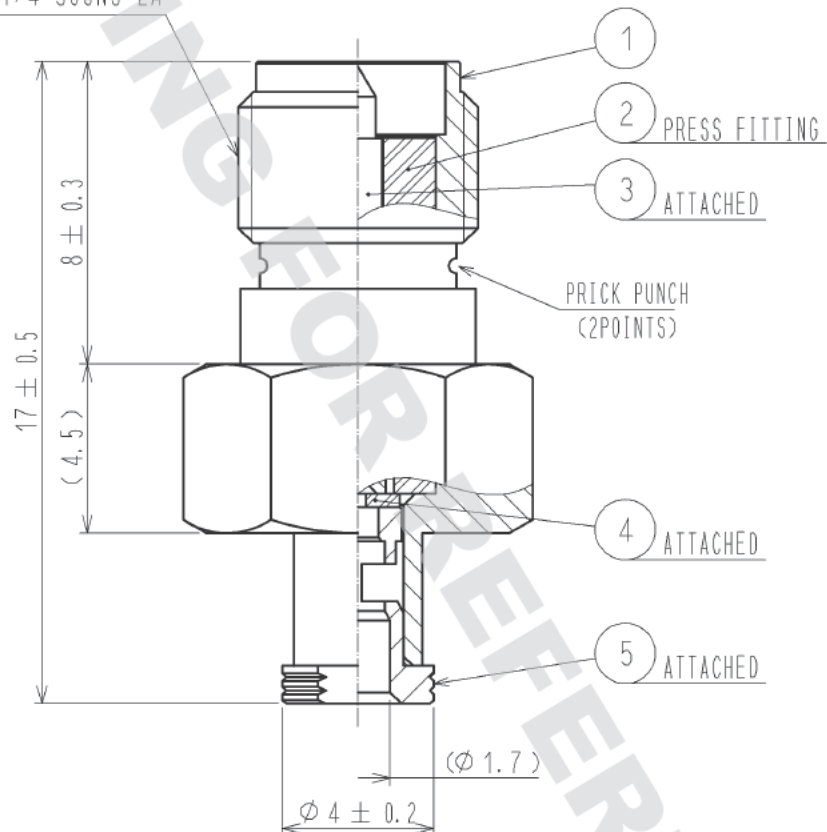

RoHS COMPLIANT

| | | | | | |
|---------------------------------|----------|--------------------------|------------|--------------------------|-----------------------------|
| 3 | BRASS | GOLD PLATING | | | |
| 2 | PTFE | | 5 | BRASS | GOLD PLATING |
| 1 | BRASS | NICKEL PLATING | 4 | PTFE | |
| NO. | MATERIAL | FINISH . REMARKS | NO. | MATERIAL | FINISH . REMARKS |
| UNITS mm | | SCALE 5 : 1 | COUNT | DESCRIPTION OF REVISIONS | DESIGNED CHECKED DATE |
| HIROSE ELECTRIC CO., LTD. | | APPROVED : TS. NOBE | 12. 05. 28 | DRAWING NO. | EDC4-319784-00 |
| | | CHECKED : NK. NINOMIYA | 12. 05. 20 | PART NO. | SMA(R)-200-088JBN |
| | | DESIGNED : MS. MATSUMOTO | 12. 01. 30 | CODE NO. | CL323-0904-0-00 |
| | | DRAWN : MS. MATSUMOTO | 12. 01. 30 | | |

Mouser Electronics

Authorized Distributor

Click to View Pricing, Inventory, Delivery & Lifecycle Information:

[Hirose Electric:](#)

[SMA\(R\)-200-088JBN](#)