

Sep.1.2021 Copyright 2021 HIROSE ELECTRIC CO., LTD. All Rights Reserved.  
In case of consideration for using Automotive equipment / device which demand high reliability, kindly contact our sales window correspondents.

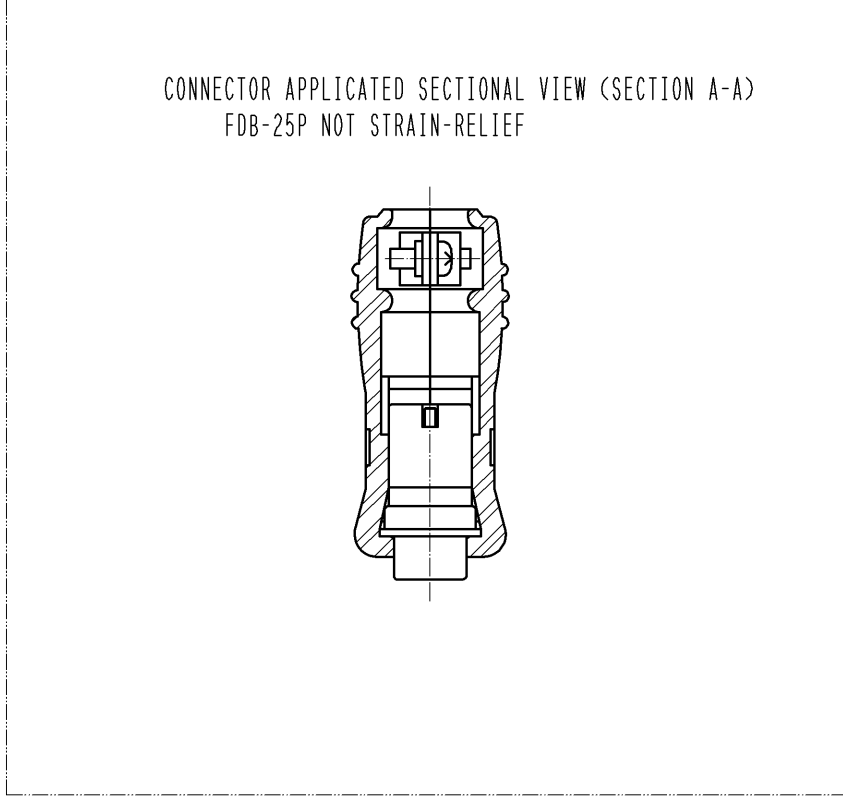
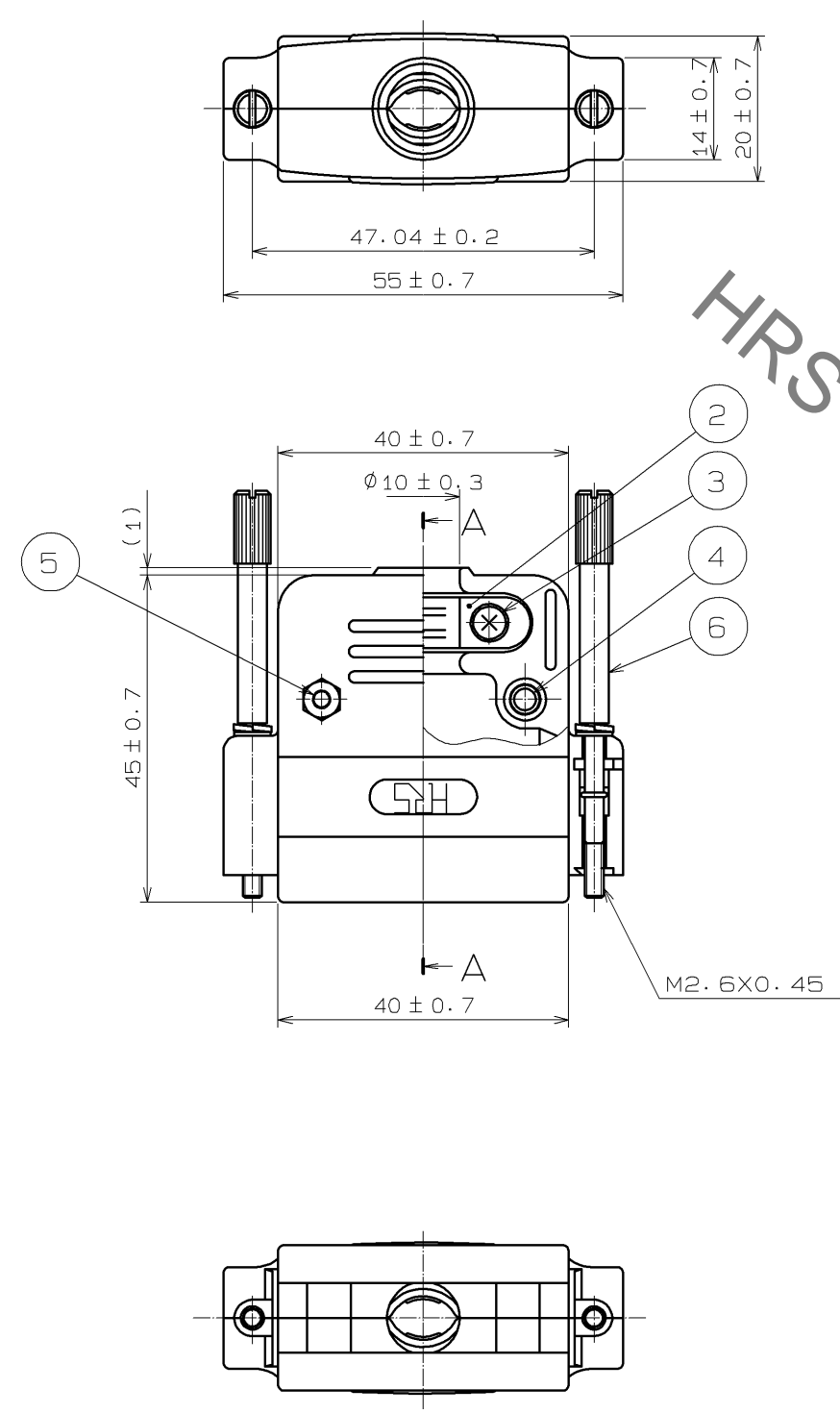

3	STEEL	SURFACE PLATING : NICKEL 0.8μm min. UNDER PLATING : COPPER 2μm min.	6	STEEL	SURFACE PLATING : NICKEL 0.8μm min. UNDER PLATING : COPPER 2μm min.		
2	STEEL	SURFACE PLATING : NICKEL 3μm min. UNDER PLATING : COPPER 2μm min.	5	STEEL	SURFACE PLATING : NICKEL 0.8μm min. UNDER PLATING : COPPER 2μm min.		
1	ABS	(2.5 PB 6.0/2.0)UL94HB	4	STEEL	SURFACE PLATING : NICKEL 0.8μm min. UNDER PLATING : COPPER 2μm min.		
NO.	MATERIAL	FINISH , REMARKS	NO.	MATERIAL	FINISH , REMARKS		
UNITS mm		SCALE 1 : 1	COUNT 	DESCRIPTION OF REVISIONS	DESIGNED	CHECKED	DATE
HIROSE ELECTRIC CO., LTD.		APPROVED : YH. ENAMI	09.01.29	DRAWING NO. EDC3-008874-01			
		CHECKED : HO. MIWA	09.01.29	PART NO. HDB-CTF1(50)			
		DESIGNED : YH. MAMADA	09.01.28	CODE NO. CL211-0166-3-50			
		DRAWN : YH. MAMADA	09.01.28	1/1			

# Mouser Electronics

Authorized Distributor

Click to View Pricing, Inventory, Delivery & Lifecycle Information:

[Hirose Electric:](#)

[HDB-CTF1\(50\)](#)