

Customer Information Sheet

DRAWING No.: SOX-46

SHEET 2 OF 2

IF IN DOUBT - ASK

©

NOT TO SCALE

THIRD ANGLE PROJECTION

ALL DIMENSIONS IN mm

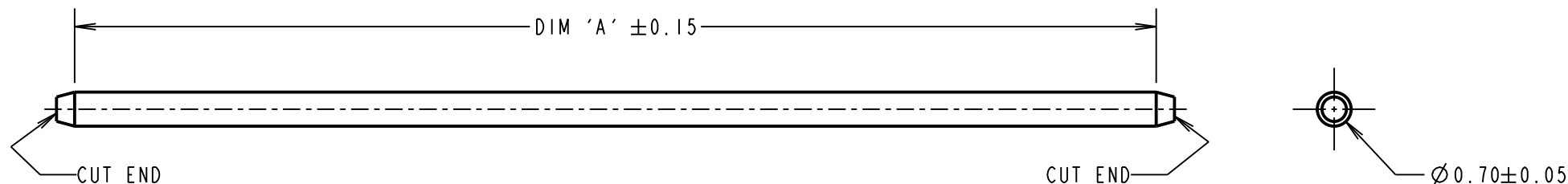
**NOTES:**

1. THIS PRODUCT IS RECOMMENDED FOR USE WITH S8071-46R AND S8081-46R SMT CLIPS.
3. MAXIMUM BURR ON CUTTING AREA = 0.05mm.
4. ALL PRODUCT IS RoHS AND REACH COMPLIANT.
5. PACKAGING = 100 COMPONENTS PER BAG.
6. CURRENT RATING IS DEPENDANT ON USAGE. SEE TEST REPORT HT055XX (LATEST ISSUE) FOR MORE INFORMATION ON CURRENT RATING.

SPECIFICATIONS:

MATERIAL = PHOSPHOR BRONZE
FINISH = 2-6 μ TIN OVER 1-4 μ NICKEL

ELECTRICAL:

CURRENT RATING = 3A - 13A
(SEE NOTE 6)

VOLTAGE RATING = 250V AC/DC
CONTACT RESISTANCE = 20m Ω MAX

ENVIRONMENTAL:

OPERATING TEMPERATURE = -40°C TO +85°C

PART No.	DIM 'A'
S07-46	23.00
S08-46	15.00

ORDER CODE:**SOX-46****PIN LENGTH:**

7 = 23.00
8 = 15.00

FINISH:

46 = 2-6 μ TIN OVER
1-4 μ NICKEL

MSP	4	19.04.17	20428
NAME	ISS.	DATE	C/NOTE
APPROVED: M.PERREN			
CHECKED: S.BENNETT			
DRAWN: S.BENNETT			
CUSTOMER REF.:			
ASSEMBLY DRG:			

HARWIN

www.harwin.com
technical@harwin.com

THIS DRAWING AND ANY
INFORMATION OR DESCRIPTIVE
MATTER SET OUT HEREON ARE
CONFIDENTIAL AND COPYRIGHT
PROPERTY OF THE HARWIN
GROUP AND MUST NOT BE
DISCLOSED, LOANED, COPIED
OR USED FOR MANUFACTURING,
TENDERING OR FOR ANY
OTHER PURPOSE WITHOUT
THEIR WRITTEN PERMISSION.

TOLERANCES

X. = ± 1 mm
X.X = ± 0.50 mm
X.XX = ± 0.10 mm
X.XXX = ± 0.01 mm

ANGLES = $\pm 5^\circ$
UNLESS STATED

MATERIAL:

SEE ABOVE

FINISH: SEE ABOVE**S/AREA:**mm²**TITLE:**

BRIDGE PIN

DRAWING NUMBER:**SOX-46**

SHT
2
OF
2

Mouser Electronics

Authorized Distributor

Click to View Pricing, Inventory, Delivery & Lifecycle Information:

Harwin:

[S07-46](#) [S08-46](#)