

Customer Information Sheet

DRAWING No.: M80-836XXXX

IF IN DOUBT - ASK

©

NOT TO SCALE

THIRD ANGLE PROJECTION

ALL DIMENSIONS IN mm

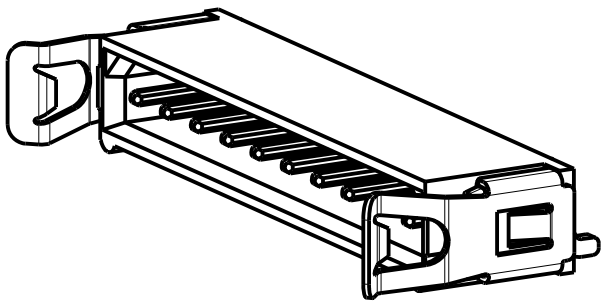
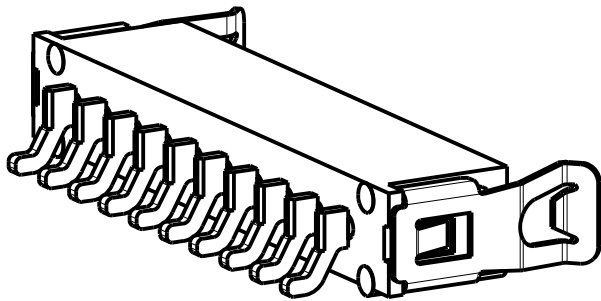
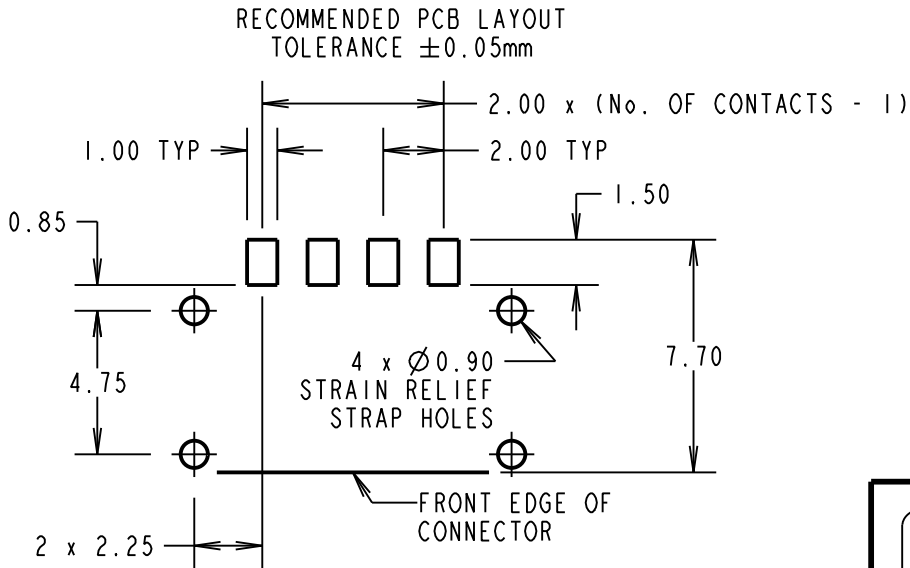
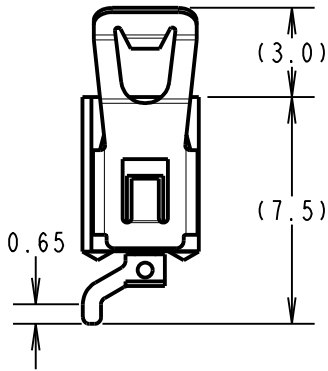
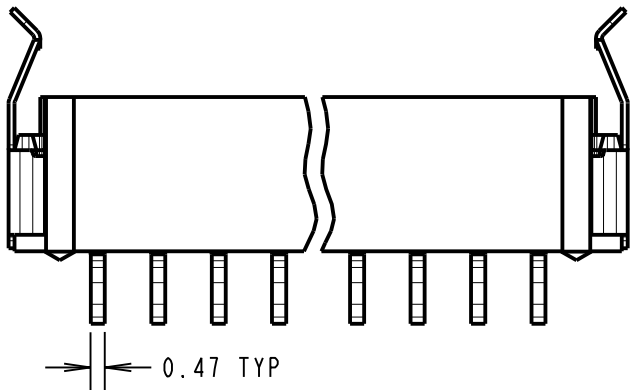
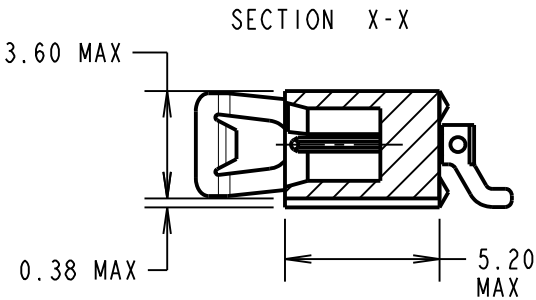
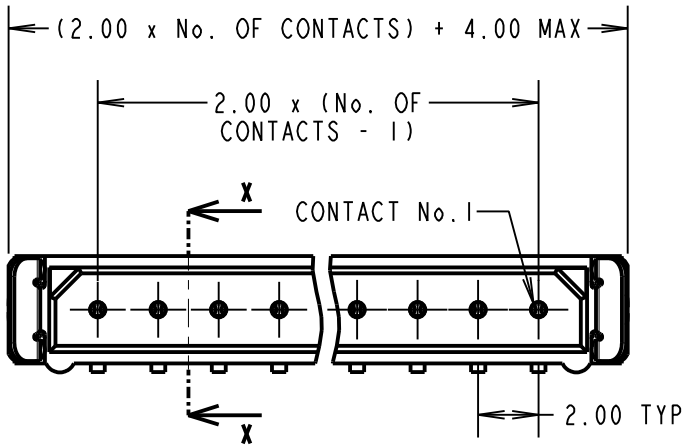

SPECIFICATIONS:

MATERIAL:

MOULDING = GLASS-FILLED PPS, UL94V-0, BLACK

CONTACT = BRASS

LATCH = COPPER ALLOY

FINISH:

CONTACT:

22 = $0.75\mu\text{m}$ GOLD ON CONTACT AREA,
 $0.3\mu\text{m}$ 90/10 TIN/LEAD ON TAILS

42 = $0.75\mu\text{m}$ GOLD ON CONTACT AREA,
 $0.3\mu\text{m}$ 100% TIN OVER NICKEL ON TAILS

45 = $0.75\mu\text{m}$ GOLD

LATCH = NICKEL

ELECTRICAL:

CURRENT RATING AT 25°C = 3.0A MAX

CURRENT RATING AT 85°C = 2.2A MAX

WORKING VOLTAGE = 800V AC/DC

VOLTAGE PROOF = 1200V AC/DC

CONTACT RESISTANCE = $25\text{m}\Omega$ MAX

INSULATION RESISTANCE = $100\text{M}\Omega$ MIN

MECHANICAL:

DURABILITY = 500 OPERATIONS

ENVIRONMENTAL:

TEMPERATURE RANGE = -55°C TO $+125^{\circ}\text{C}$

PACKING:

TUBE, 2-OFF M80-0030006 STRAIN RELIEF STRAPS
PER CONNECTOR IN BAG

FOR COMPLETE SPECIFICATION, SEE COMPONENT
SPECIFICATION C005XX (LATEST ISSUE).

ORDER CODE:
M80-836XXXX

No. OF CONTACTS
02 - 07, 17, 22

FINISH
22 - GOLD, 90/10 TIN/LEAD
42 - GOLD, 100% TIN OVER NICKEL
45 - GOLD

MGP	5	21.07.21	30679
NAME	ISS.	DATE	CN/CO
APPROVED: MGP			
CHECKED: RTP			
DRAWN: R.ADDE			
CUSTOMER REF.:			
ASSEMBLY DRG:			

HARWIN

www.harwin.com
technical@harwin.com

THIS DRAWING AND ANY INFORMATION OR DESCRIPTIVE MATTER SET OUT HEREON ARE CONFIDENTIAL AND COPYRIGHT PROPERTY OF THE HARWIN GROUP AND MUST NOT BE DISCLOSED, LOANED, COPIED OR USED FOR MANUFACTURING, TENDERING OR FOR ANY OTHER PURPOSE WITHOUT THEIR WRITTEN PERMISSION.

TOLERANCES

X. = $\pm 1\text{mm}$

X.X = $\pm 0.50\text{mm}$

X.XX = $\pm 0.20\text{mm}$

X.XXX = $\pm 0.01\text{mm}$

ANGLES = $\pm 5^{\circ}$

UNLESS STATED

MATERIAL:

SEE ABOVE

FINISH:

SEE ABOVE

S/AREA:

mm²

TITLE: DATAMATE L-TEK
MALE SIL HORIZONTAL SMT
ASSEMBLY (LATCHED)

DRAWING NUMBER:

M80-836XXXX

SHT
2 OF 2

Mouser Electronics

Authorized Distributor

Click to View Pricing, Inventory, Delivery & Lifecycle Information:

Harwin:

[M80-8360222](#) [M80-8360442](#) [M80-8360422](#) [M80-8360445](#) [M80-8360242](#)