

Customer Information Sheet

DRAWING No.: M50-312XX45R

IF IN DOUBT - ASK

©

NOT TO SCALE

THIRD ANGLE PROJECTION

ALL DIMENSIONS IN mm

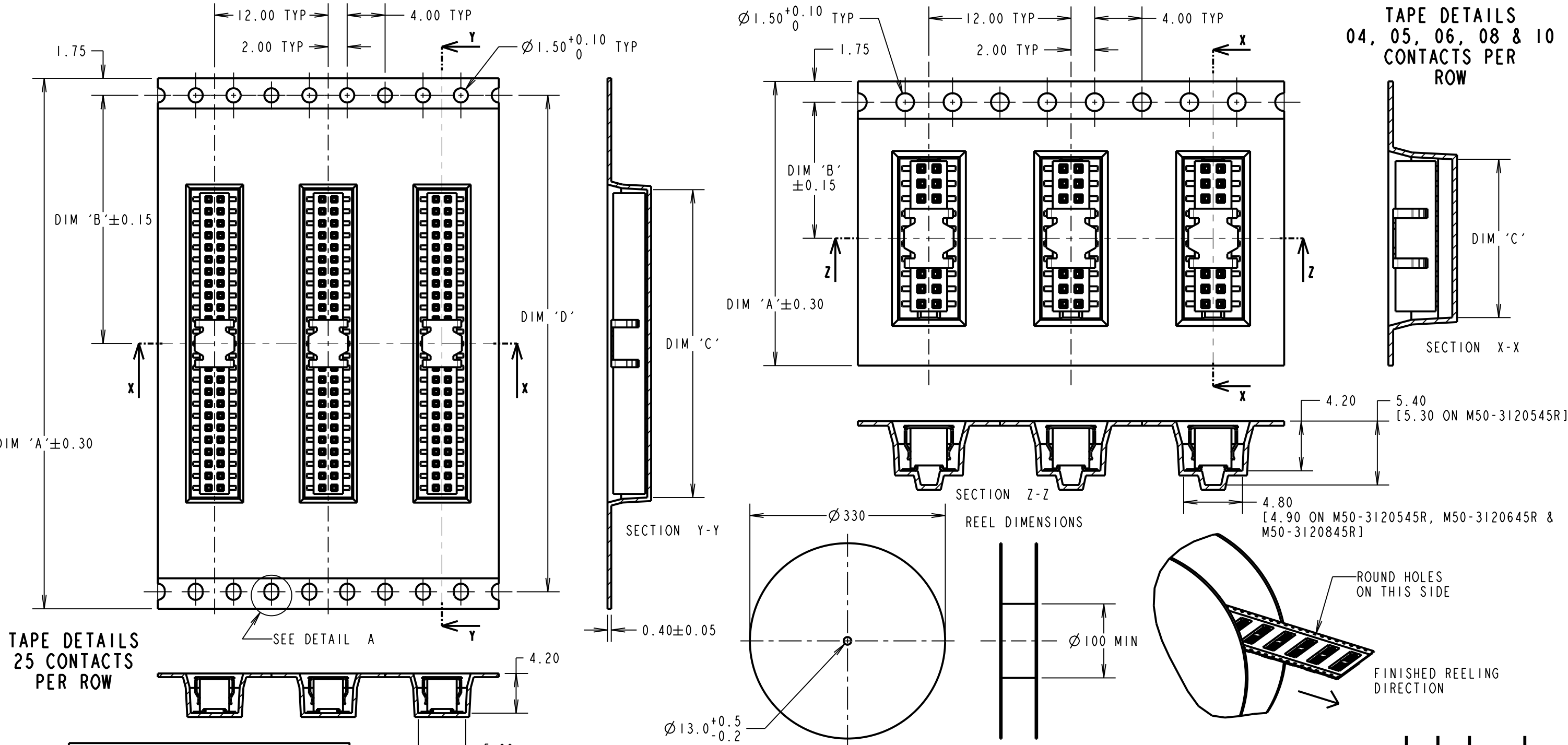

ORDER CODE:

M50-312XX45R

No. OF CONTACTS PER ROW:
04, 05, 06, 08, 10, 25

FINISH:
GOLD FLASH OVER NICKEL

OBSOLETE
All other size/finish
combinations not
listed

**Active
products:**

M50-3120445R
M50-3120545R
M50-3120645R
M50-3120845R
M50-3121045R

REELED PART No.	DIM 'A'	DIM 'B'	DIM 'C'	DIM 'D'
M50-3120445R	16.00±0.30	7.50	5.80±0.15	
M50-3120545R			7.50	
M50-3120645R	24.00±0.30	11.50	8.45	
M50-3120845R			10.90	
M50-3121045R			16.70	
M50-3122545R	56.00±0.30	26.2±0.15	32.50±0.15	52.40

THIS DRAWING AND ANY
INFORMATION OR DESCRIPTIVE
MATTER SET OUT HEREON ARE
CONFIDENTIAL AND COPYRIGHT
PROPERTY OF THE HARWIN
GROUP AND MUST NOT BE
DISCLOSED, LOANED, COPIED
OR USED FOR MANUFACTURING,
TENDERING OR FOR ANY
OTHER PURPOSE WITHOUT
THEIR WRITTEN PERMISSION.

TOLERANCES
X. = ±1mm
X.X = ±0.50mm
X.XX = ±0.20mm
X.XXX = ±0.01mm
ANGLES = ±5°
UNLESS STATED

MATERIAL:
SEE ABOVE

FINISH:
SEE ABOVE

S/AREA:
mm²

TITLE:
1.27mm PITCH
VERTICAL SMT SOCKET ASSY
(T&R WITH P/PLACE CAP)

DRAWING NUMBER:
M50-312XX45R

SHT
3 OF 4

NOTES:

- TAPE & REELING IS IN ACCORDANCE WITH EIA-481 (ELECTRONIC INDUSTRIES ASSOCIATION).
- CUMULATIVE TOLERANCE OVER 10 PITCHES = ±0.20mm.
- QUANTITY PER Ø330mm REEL = 1000 PIECES.
- FOR CONNECTOR DETAILS, SEE SHEET 4.
- M50-3120545R AND M50-3120845R HAVE VISUAL DIFFERENCES IN TAPE POCKET TO THOSE DETAILED ON THIS DRAWING.

HARWIN

www.harwin.com
technical@harwin.com

Customer Information Sheet

DRAWING No.: M50-312XX45R IF IN DOUBT - ASK © NOT TO SCALE THIRD ANGLE PROJECTION ALL DIMENSIONS IN mm

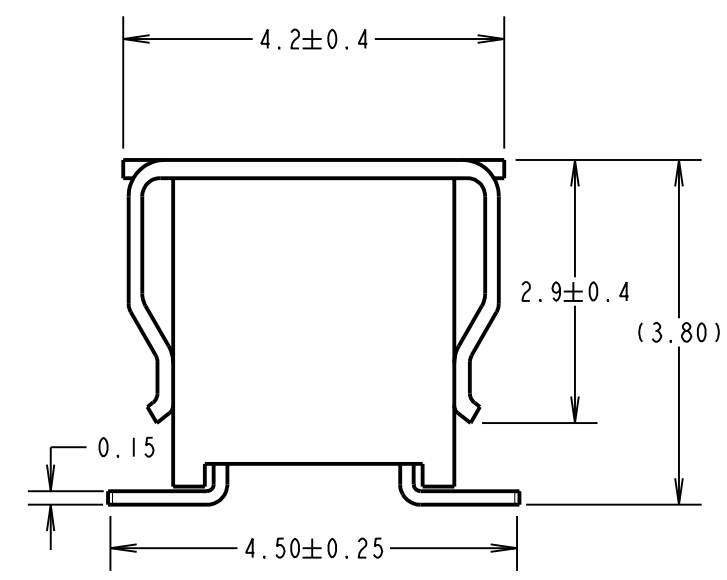
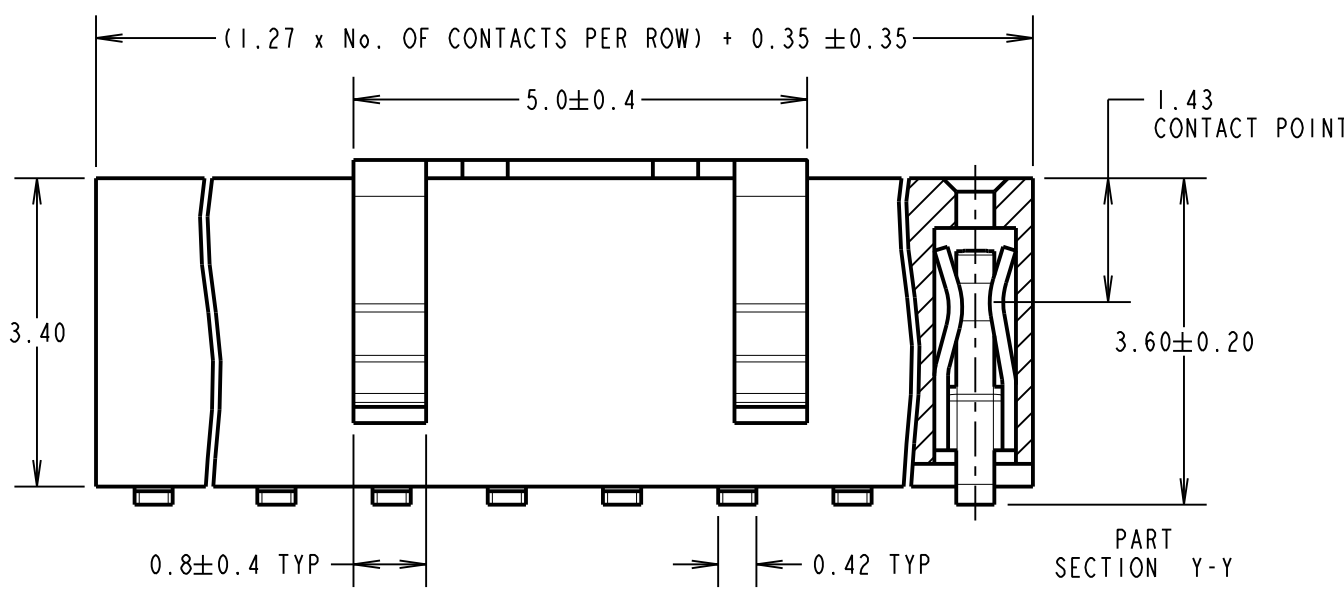
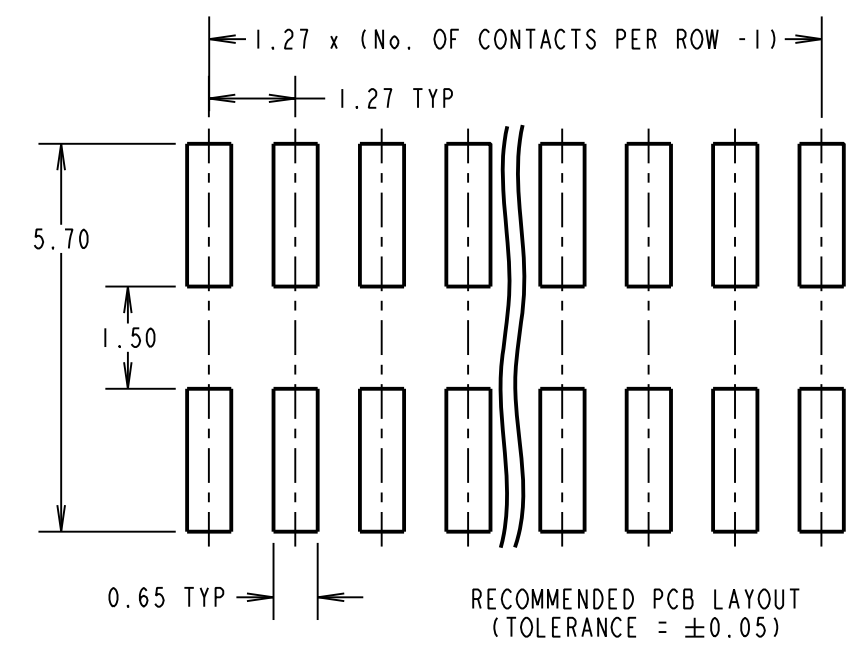
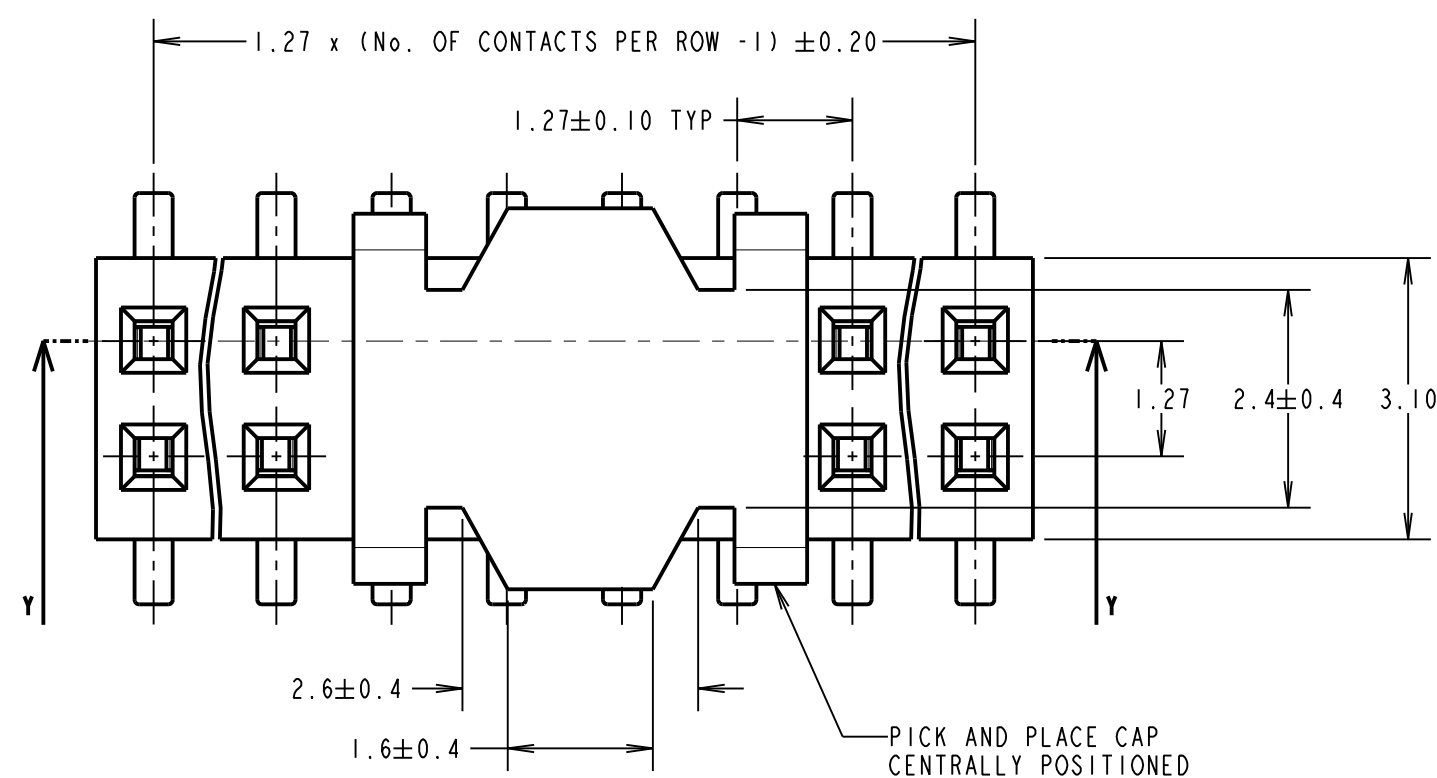

SPECIFICATIONS:
MATERIAL:
MOULDING = LCP, UL94V-0, BLACK
CONTACT = PHOSPHOR BRONZE
FINISH:
CONTACT = GOLD FLASH OVER NICKEL
ELECTRICAL:
CURRENT RATING = 1A
VOLTAGE PROOF = 300V AC, 500V DC FOR ONE MINUTE
CONTACT RESISTANCE = $30\text{m}\Omega$ MAX
INSULATION RESISTANCE = $1000\text{M}\Omega$ MIN
MECHANICAL:
DURABILITY = 100 CYCLES MIN
INSERTION FORCE = 2N MAX PER CONTACT
WITHDRAWAL FORCE = 0.15N MIN PER CONTACT
ENVIRONMENTAL:
OPERATING TEMPERATURE = -40°C TO $+105^{\circ}\text{C}$
PACKING:
TUBE
FOR COMPLETE SPECIFICATION, SEE COMPONENT SPECIFICATION C029XX (LATEST ISSUE)

ORDER CODE:
M50-312XX45R
No. OF CONTACTS PER ROW: 04, 05, 06, 08, 10, 25
FINISH: GOLD FLASH OVER NICKEL

NOTES:
1. FOR TAPE & REEL DETAILS, SEE SHEET 3.
2. FOR DETAILS OF STANDARD COMPONENT, SEE DRAWING M50-312XX45.
3. ALL TOLERANCES ARE ± 0.15 , UNLESS OTHERWISE STATED.

HARWIN www.harwin.com technical@harwin.com	THIS DRAWING AND ANY INFORMATION OR DESCRIPTIVE MATTER SET OUT HEREON ARE CONFIDENTIAL AND COPYRIGHT PROPERTY OF THE HARWIN GROUP AND MUST NOT BE DISCLOSED, LOANED, COPIED OR USED FOR MANUFACTURING, TENDERING OR FOR ANY OTHER PURPOSE WITHOUT THEIR WRITTEN PERMISSION.	TOLERANCES X = $\pm 1\text{mm}$ X.X = $\pm 0.50\text{mm}$ X.XX = $\pm 0.20\text{mm}$ X.XXX = $\pm 0.01\text{mm}$ ANGLES = $\pm 5^{\circ}$ UNLESS STATED	MATERIAL: SEE ABOVE	TITLE: 1.27mm PITCH VERTICAL SMT SOCKET ASSY (T&R WITH P/PLACE CAP)
			FINISH: SEE ABOVE	DRAWING NUMBER: M50-312XX45R
			S/AREA: mm ²	SHT 4 OF 4

MGP	11	23.11.21	31219
NAME	ISS.	DATE	CN/CO
APPROVED: MGP			
CHECKED: RTP			
DRAWN: JM BROOKES			
CUSTOMER REF.:			
ASSEMBLY DRG:			

Mouser Electronics

Authorized Distributor

Click to View Pricing, Inventory, Delivery & Lifecycle Information:

[Harwin:](#)

[M50-3121045R](#) [M50-3120845R](#) [M50-3120545R](#) [M50-3120445R](#)