

NOTES:

1. MATERIALS AND FINISHES:
BODY - BERYLLIUM COPPER, GOLD PLATING
REAR BODY - BRASS, GOLD PLATING
CONTACT - BERYLLIUM COPPER, GOLD PLATING
CAP - PHOSPHOR BRONZE, NICKEL PLATING
INSULATOR - PTFE, NATURAL
2. ELECTRICAL:
A. IMPEDANCE: 50 OHM
B. FREQUENCY RANGE: DC-26.5 GHz
C. VSWR(RETURN LOSS): 1.08 (28.3 dB) MAX. @ DC - 3 GHz
1.20 (21.0 dB) MAX. @ 3 - 26.5 GHz
3. MECHANICAL:
A. DURABILITY: 100 CYCLES MIN. MATED WITH FULL DETENT JACK
500 CYCLES MIN. MATED WITH LIMITED DETENT JACK
1000 CYCLES MIN. MATED WITH SMOOTH BORE JACK
B. TEMPERATURE RANGE: -65°C TO +165°C
4. PACKAGING:
A. QUANTITY: SINGLE PACK
B. MARKING: PACKAGING TO BE MARKED
"AMPHENOL RF, SMP-FS-T2, DATE CODE"

THIRD ANGLE PROJ.

REVISIONS				
REV	DESCRIPTION	DATE	ECN	APPR
A	RELEASE TO MFG.	17-Jan-20	14221	EH

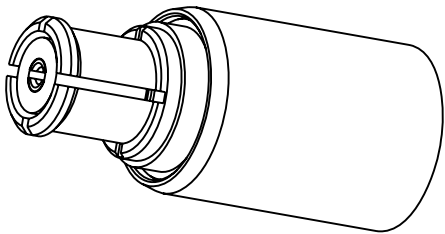

SCALE 5.000

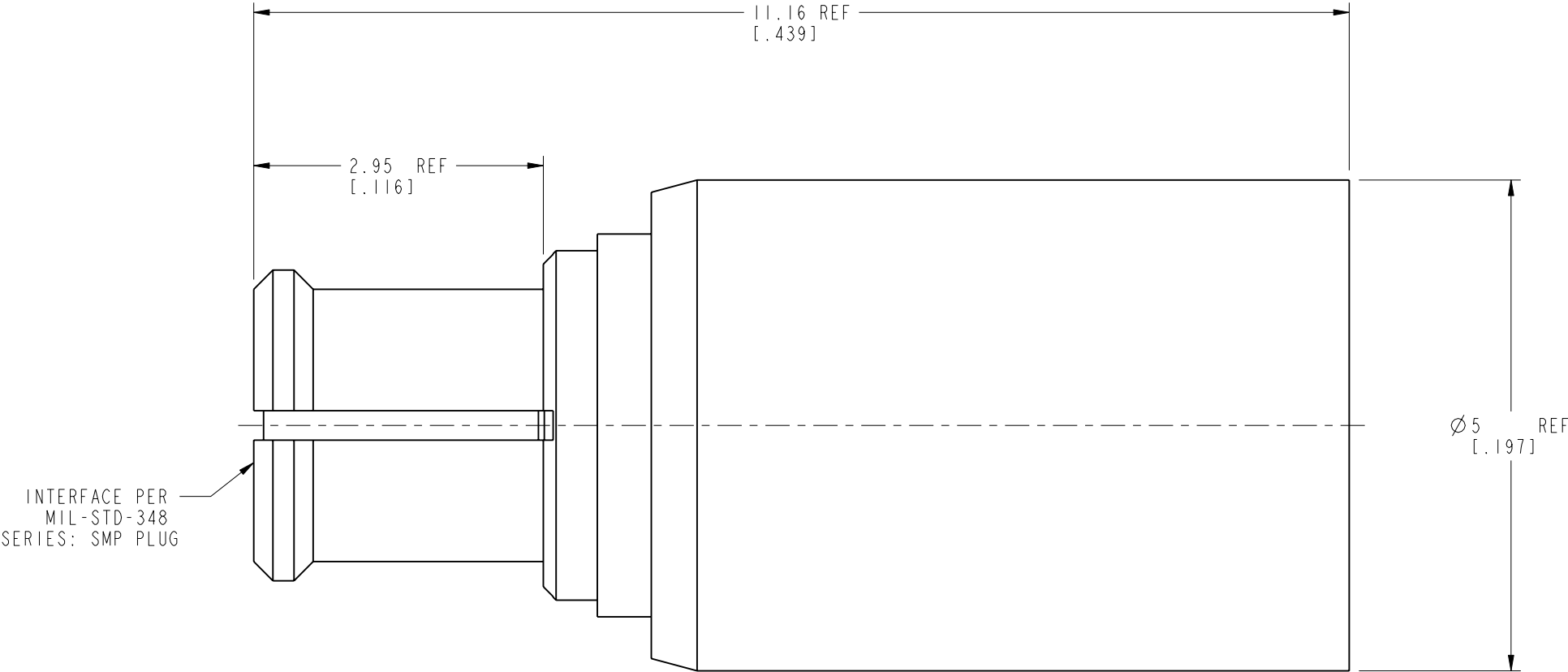

CUSTOMER OUTLINE DRAWING
ALL OTHER SHEETS ARE FOR INTERNAL USE ONLY

UNLESS OTHERWISE SPECIFIED, DIMENSIONS ARE IN METRIC AND TOLERANCES ARE: <0.5mm 0.5 - 6mm 6 - 30mm 30 - 120mm ANGLES ± 0.05mm ±0.1mm ±0.2mm ± 0.3mm ±1° NOTICE - These drawings, specifications, or other data (1) are, and remain the property of Amphenol corp. (2) must be returned upon request; and (3) are confidential and not to be disclosed to any person other than those to whom they are given by Amphenol Corp. the furnishing of these drawings, specifications, or other data by Amphenol Corp., or to any other person to anyone for any purpose is not to be regarded by implication or otherwise in any manner licensing, granting rights to permitting such holder or any other person to manufacture, use or sell any product, process or design, patented or otherwise, that may in any way be related to or disclosed by said drawings, specifications, or other data.	MATERIAL	DRAWN	DATE	TITLE SMP PLUG 2 WATT TERMINATION		Amphenol RF www.amphenolrf.com	
	SEE NOTES	WIKI	26-Feb-20				
	REFERENCE	ENGINEER	DATE				
	EAR# 9238	STAR	26-Feb-20	SCALE: 16.0:1.0		SHEET 2 OF 2	
	REF: ---	APPROVED	DATE	DWG SIZE B		REV A	
CONFIGURATION LEVEL: In Work		S.HSIEH	3-Mar-20				
FINISH		CAD FILE				DRAWING NO. SMP-FS-T2	
						ITEM NO. SMP-FS-T2	
						PART NO. SMP-FS-T2	

Mouser Electronics

Authorized Distributor

Click to View Pricing, Inventory, Delivery & Lifecycle Information:

[Amphenol:](#)

[SMP-FS-T2](#)