

| ZONE | REV | SCR NUMBER | DESCRIPTION | BY | DATE | APPROVED |
|-------------------------|-----|--------------------|---|-----------|----------|------------|
| ALL | A | DMAN-8W TLCB.VER01 | NEW RELEASE | D.MALOON | 08/03/12 | D.McNAMARA |
| SHT 1 SHT 3 SHT 4 | B | MCHH-9UPNUP.VER01 | ADDED NOTE 11. ADDED HOLES NOT NECESSARY TO NOTE 4. REMOVED A DRILLED HOLE ON PAD AND VIA LAYOUTS | M.CHARETH | 03/17/15 | D.McNAMARA |

TABLE 1

| PART NUMBER ① | DESCRIPTION |
|---------------|--|
| 380-5392-X00 | RECEPTACLE ASSY. 6 PAIR, 20 MM HIGH, 18 WAFERS, 100 OHMS, W/LOSSY |
| 380-5492-X00 | RECEPTACLE ASSY. 6 PAIR, 20 MM HIGH, 18 WAFERS, 85 OHMS, W/LOSSY |
| 380-5592-X00 | RECEPTACLE ASSY. 6 PAIR, 20 MM HIGH, 18 WAFERS, 100 OHMS, NO LOSSY |
| 380-5692-X00 | RECEPTACLE ASSY. 6 PAIR, 20 MM HIGH, 18 WAFERS, 85 OHMS, NO LOSSY |

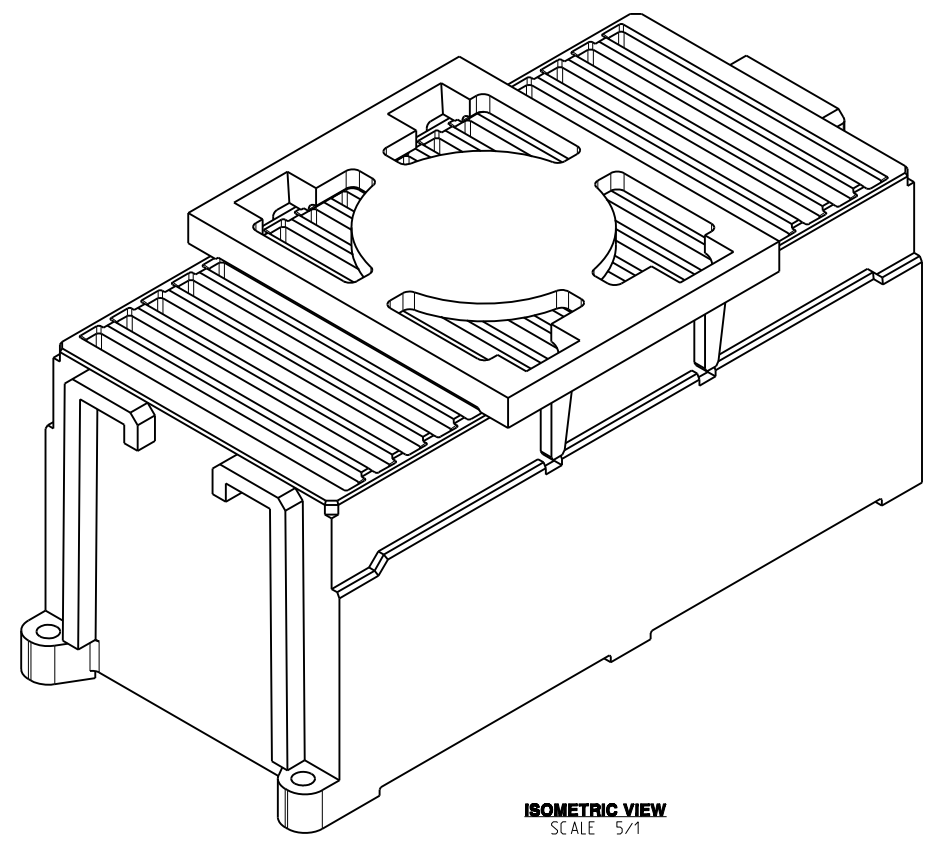

ISOMETRIC VIEW
SCALE 5/1

NOTES:

- ① ASSEMBLY PART NUMBER VARIES WITH PLATING OPTION AS FOLLOWS:
FOR NI SULFAMATE UNDERPLATE, 8TH DIGIT OF P/N IS 2.
FOR NANO NI UNDERPLATE, 8TH DIGIT OF P/N IS 4.
- 2. MAT'L:
HOUSING/WAFERS/VACUUM CAP - LCP.
CONTACTS - HIGH PERFORMANCE COPPER ALLOY, PER MTS-506.
- 3. 0.71 DIA SOLDER SPHERES WILL NOT BE PERFECTLY SPHERICAL AFTER REFLOW ATTACHMENT.
- ④ HOLES RECOMMENDED FOR VISUAL INSPECTION OF CONNECTOR ALIGNMENT AFTER PLACEMENT AND BEFORE REFLOW. HOLES NOT NECESSARY.
- ⑤ SOLDER BALL PROTRUSION BELOW HOUSING.
- ⑥ SEE TECHNICAL BULLETIN TB-2241 FOR DETAILED SMT PROCESSING AND PCB FOOT PRINT RECOMMENDATIONS.
- ⑦ MAXIMUM CO-PLANARITY OF THE BALL FIELD.
- ⑧ MAXIMUM RADIAL TRUE POSITION OF ANY SOLDER BALL IN RELATION TO AN IDEAL BEST FIT GRID.
- 9. TOLERANCES DO NOT APPLY TO REFERENCE DIMENSIONS SHOWN IN "Ø" OR BASIC DIMENSIONS SHOWN IN "□".
- 10. REFER TO FILE 380-5X92-XX0.STP FOR SIMPLIFIED 3D MODEL OF ASSEMBLY.
- ⑪ TOOLING HOLES USED FOR INTERNAL PROCESS ALIGNMENT AND NOT REQUIRED FOR SMT PROCESS ALIGNMENT. QUANTITY OF TOOLING HOLES IS OPTIONAL, AT MANUFACTURERS DISCRETION.

| TOLERANCES | DESIGN | 11/11/10 D.MALOON |
|------------|--------|------------------------|
| 0.0 ±0.25 | DRAWN | 07/11/11 D.MALOON |
| 0.00 ±0.13 | CHK | 08/03/12 D.McNAMARA |
| 0.000 ± - | APVD | 08/03/12 D.McNAMARA |
| ANGLES ± - | | |

Amphenol TCS
A Division of Amphenol Corporation
200 Innovative Way, Nashua, NH 03082 603.878.3000

TITLE
RECEPTACLE ASSEMBLY, 18 WAFERS
Infinix 6 PAIR 20 MM HIGH

PART NO. SEE TABLE 1
REV N/A

DRAWING NO. C-380-5392-500
REV B

PART 0155-RECEP-ASSY-6X20X18-VCP
DRAWING C-380-5392-500
0.0
A.9

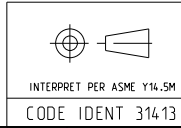

CUSTOMER USE
DRAWING

SIZE D SCALE 5/1 SHEET 1 OF 4

DRW NO. C-380-5392-500

SH 1
REV B

8

7

6

5

4

3

DRW NO. C-380-5392-500 SH 2 REV B

| ZONE | REV | SCR NUMBER | DESCRIPTION | BY | DATE | APPROVED |
|------|-----|------------|-------------|----|------|----------|
| | | | SEE SHEET 1 | | | |

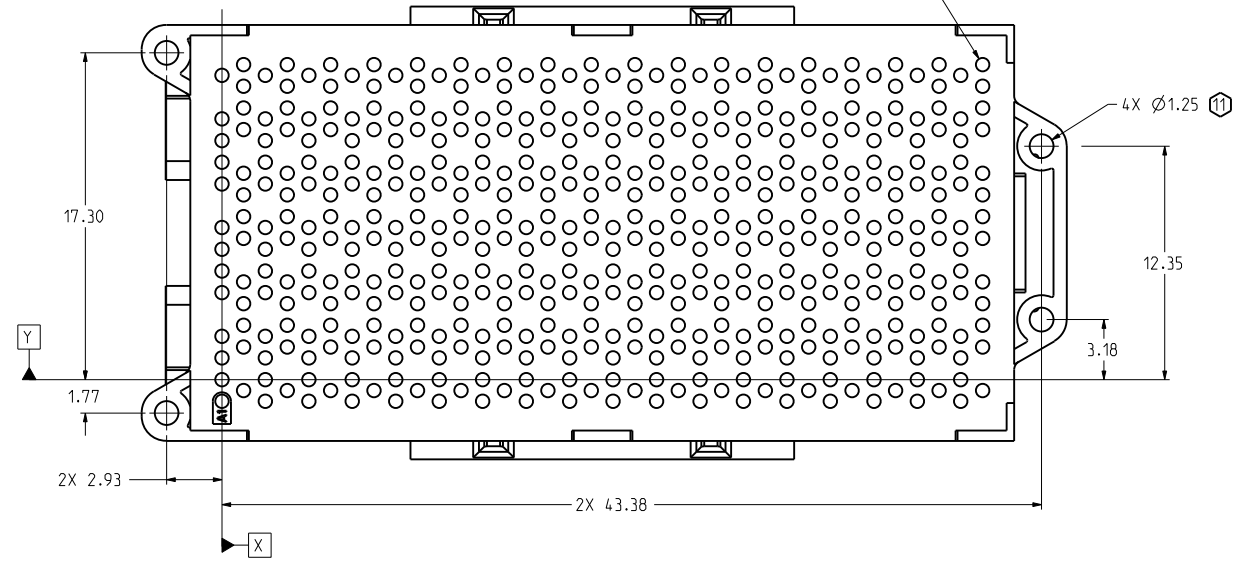
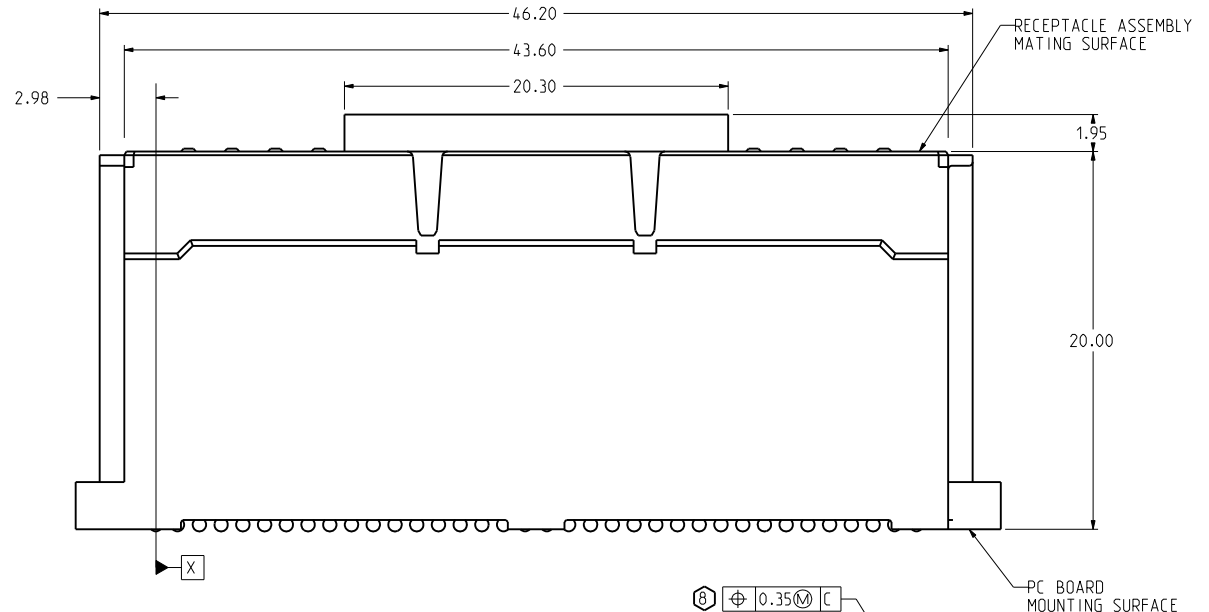
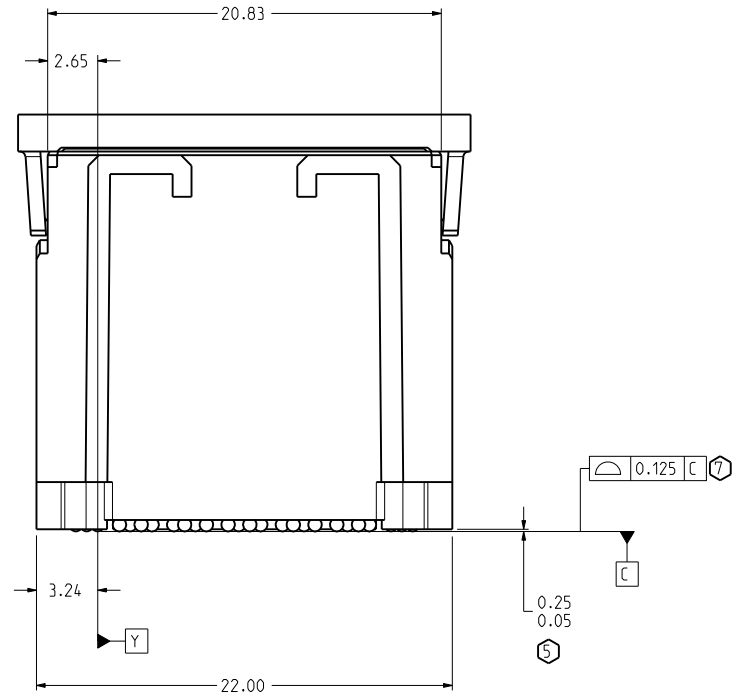
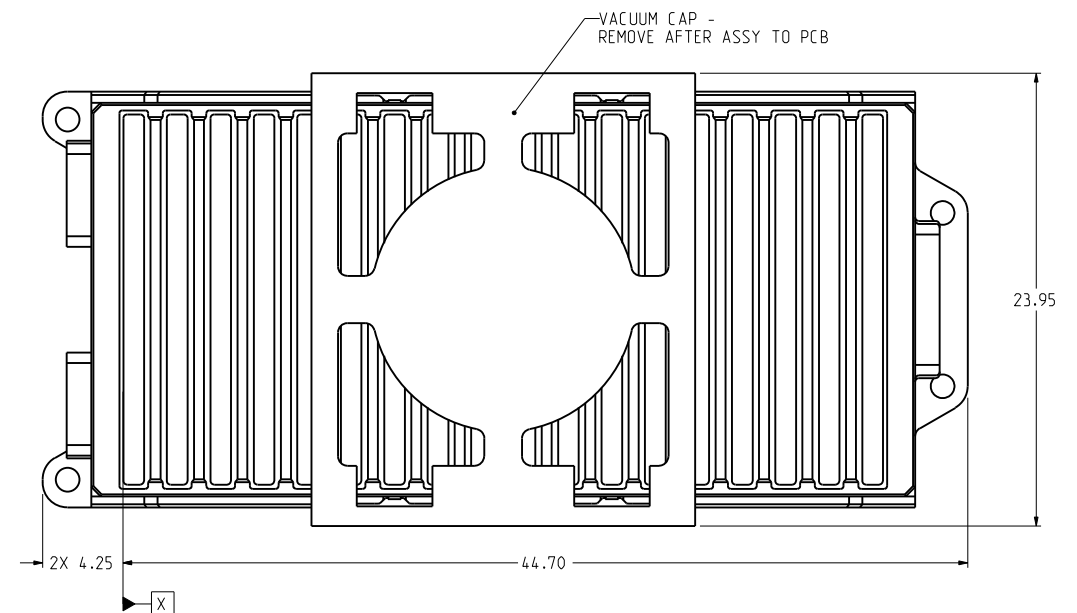

| TOLERANCES | DESIGN | 11/11/10 |
|------------|--------|------------|
| 0.0 | ±0.25 | D.MALOON |
| 0.00 | ±0.13 | D.MALOON |
| 0.000 | ± - | D.McNAMARA |
| ANGLES | ± - | D.McNAMARA |

Amphenol TCS
 A Division of Amphenol Corporation
 200 Innovative Way, Nashua, NH 03082 603.878.3000

| TITLE | RECEPTACLE ASSEMBLY, 18 WAFERS InfinX 6 PAIR 20 MM HIGH |
|-------------|--|
| PART NO. | SEE TABLE 1 |
| DRAWING NO. | C-380-5392-500 |
| SCALE | 5/1 |
| SHEET | 2 OF 4 |

UNLESS OTHERWISE SPECIFIED DIMENSIONS ARE IN MM. DECIMAL MARKER IS A PERIOD.

INTERPRET PER ASME Y14.5M
 CODE IDENT 31413

CUSTOMER USE
 DRAWING

DRW NO. C-380-5392-500

SH 2 REV B

1

| | | | | | | |
|---------|----------------|------------|-------------|-----|------|----------|
| DRW NO. | C-380-5392-500 | SH | 3 | REV | B | |
| ZONE | REV | SCR NUMBER | DESCRIPTION | BY | DATE | APPROVED |
| | | | SEE SHEET 1 | | | |

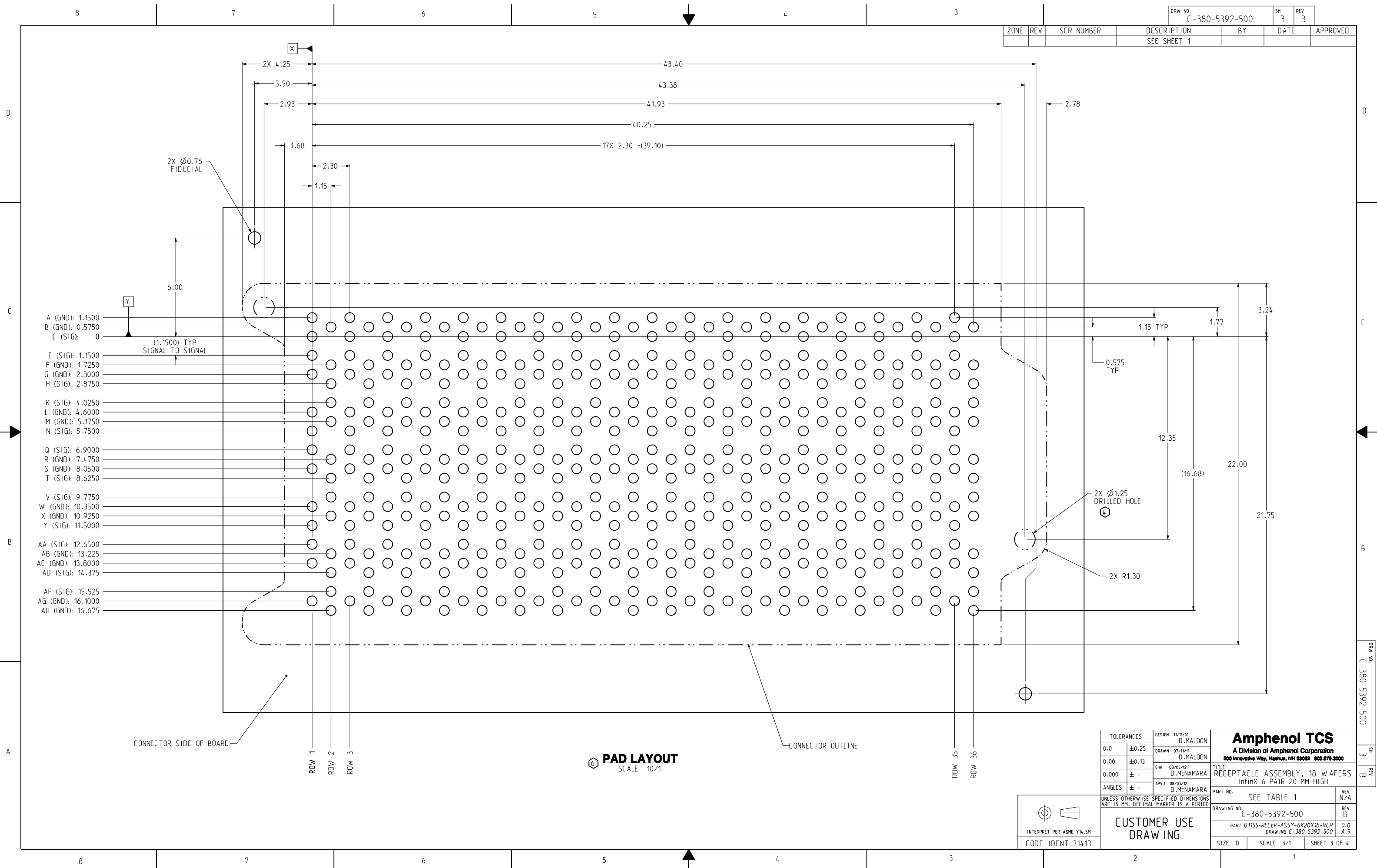

- A (GND): 1.1500
- B (GND): 0.5750
- C (SIG): 0
- E (SIG): 1.1500
- F (GND): 1.7250
- G (GND): 2.3000
- H (SIG): 2.8750
- K (SIG): 4.0250
- L (GND): 4.6000
- M (GND): 5.1750
- N (SIG): 5.7500
- Q (SIG): 6.9000
- R (GND): 7.4750
- S (GND): 8.0500
- T (SIG): 8.6250
- V (SIG): 9.7750
- W (GND): 10.3500
- X (GND): 10.9250
- Y (SIG): 11.5000
- AA (SIG): 12.6500
- AB (GND): 13.225
- AC (GND): 13.8000
- AD (SIG): 14.375
- AF (SIG): 15.525
- AG (GND): 16.1000
- AH (GND): 16.675

PAD LAYOUT
SCALE 10/1

| | | |
|------------|---|---|
| TOLERANCES | DESIGN 11/11/10 D.MALOON | Amphenol TCS A Division of Amphenol Corporation 200 Innovative Way, Nashua, NH 03082 603.879.3000 TITLE RECEPTACLE ASSEMBLY, 18 WAFERS InfinX 6 PAIR 20 MM HIGH PART NO. SEE TABLE 1 DRAWING NO. C-380-5392-500 PART 01155-RECEP-ASSY-6X20X18-VCP DRAWING C-380-5392-500 SCALE 3/1 SHEET 3 OF 4 |
| 0.0 ±0.25 | DRAWN 07/11/11 D.MALOON | |
| 0.00 ±0.13 | CHK 08/03/12 D.McNAMARA | |
| 0.000 ± - | APVD 08/03/12 D.McNAMARA | |
| ANGLES ± - | UNLESS OTHERWISE SPECIFIED DIMENSIONS ARE IN MM. DECIMAL MARKER IS A PERIOD | |

INTERPRET PER ASME Y14.5M
CODE IDENT 31413

**CUSTOMER USE
DRAWING**

PART NO. C-380-5392-500
SH 3
REV B

| ZONE | REV | SCR NUMBER | DESCRIPTION | BY | DATE | APPROVED |
|------|-----|------------|-------------|----|------|----------|
| | | | SEE SHEET 1 | | | |

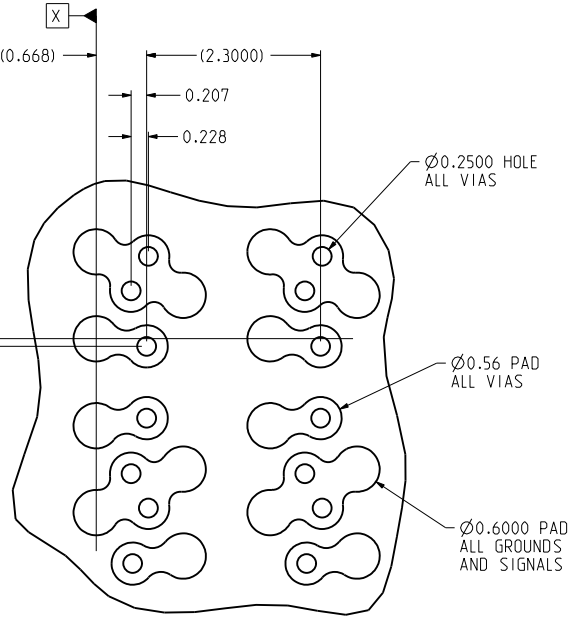

DETAIL A
SCALE 20/1

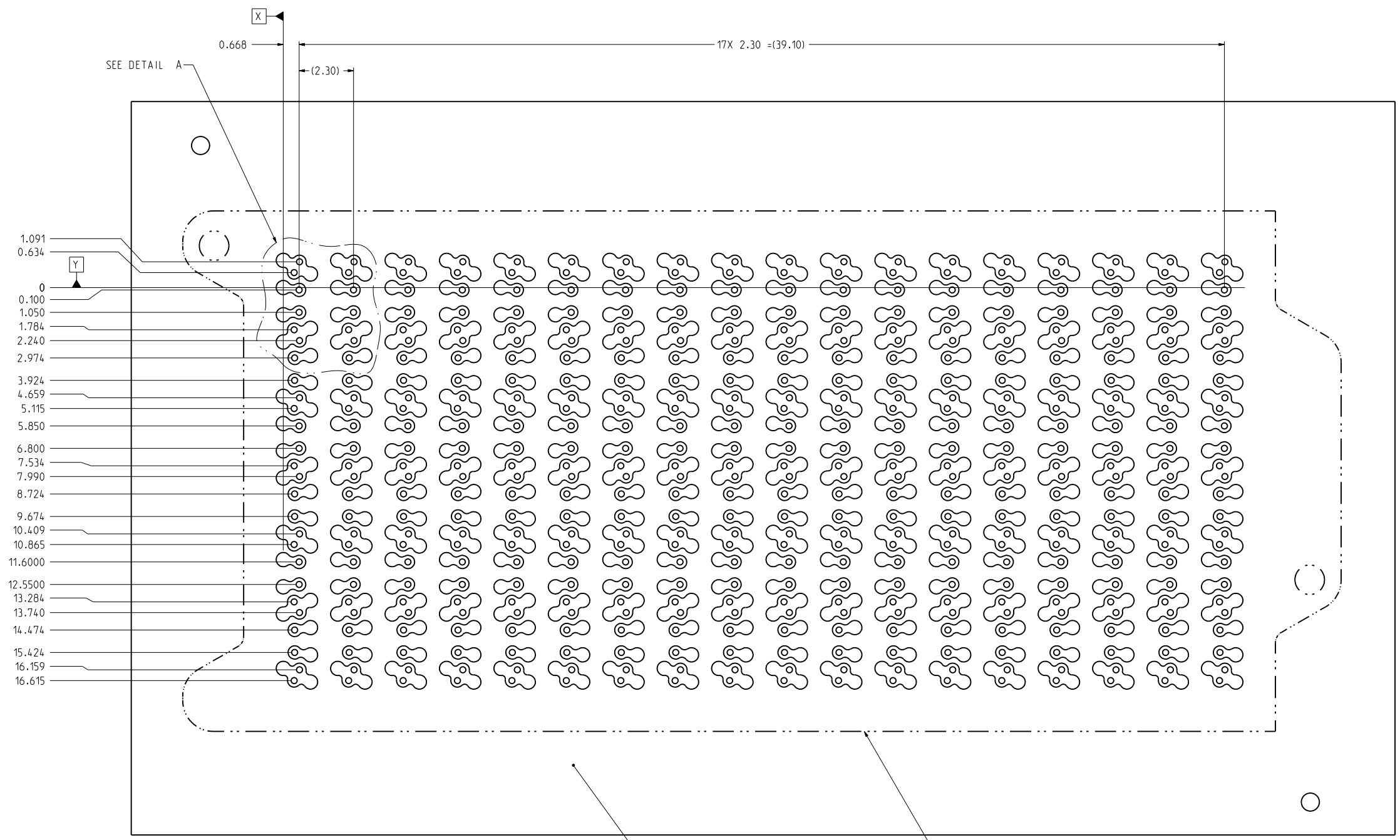

VIA LAYOUT
SCALE 10/1

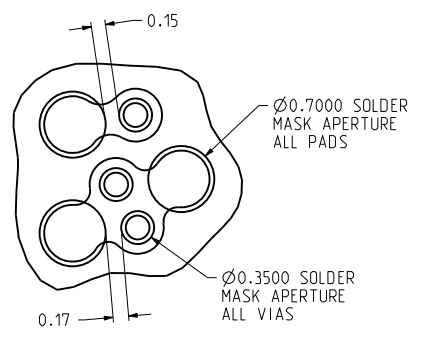

SOLDER MASK DETAIL
SCALE 25/1

| TOLERANCES | DESIGN | 11/11/10 |
|------------|--------|------------|
| 0.0 | ±0.25 | D.MALOON |
| 0.00 | ±0.13 | D.MALOON |
| 0.000 | ± - | D.McNAMARA |
| ANGLES | ± - | D.McNAMARA |

Amphenol TCS
A Division of Amphenol Corporation
200 Innovative Way, Nashua, NH 03082 603.878.3000

TITLE
RECEPTACLE ASSEMBLY, 18 WAFERS
Infinix 6 PAIR 20 MM HIGH

| | | | |
|--|----------------|-----------------------------------|--------|
| PART NO. | SEE TABLE 1 | REV | N/A |
| DRAWING NO. | C-380-5392-500 | REV | B |
| UNLESS OTHERWISE SPECIFIED DIMENSIONS ARE IN MM. DECIMAL MARKER IS A PERIOD. | | PART 01155-RECEP-ASSY-6X20X18-VCP | 0.0 |
| CUSTOMER USE DRAWING | | DRAWING C-380-5392-500 | A.9 |
| SIZE | D | SCALE | 3/1 |
| | | SHEET | 4 OF 4 |

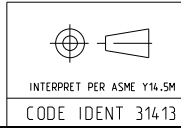

C-380-5392-500

SH 4 REV B

Mouser Electronics

Authorized Distributor

Click to View Pricing, Inventory, Delivery & Lifecycle Information:

[Amphenol:](#)

[380-5392-200](#)