



Amphenol FCI

© 2016 AFCI



D

1

2

3

4

5

6

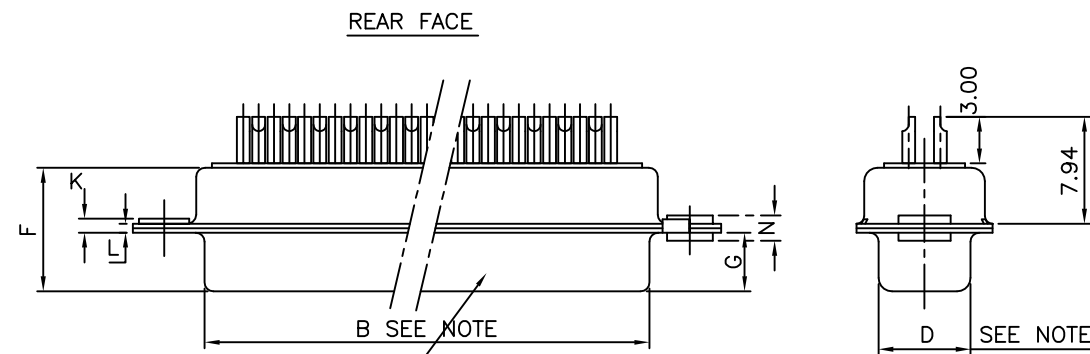
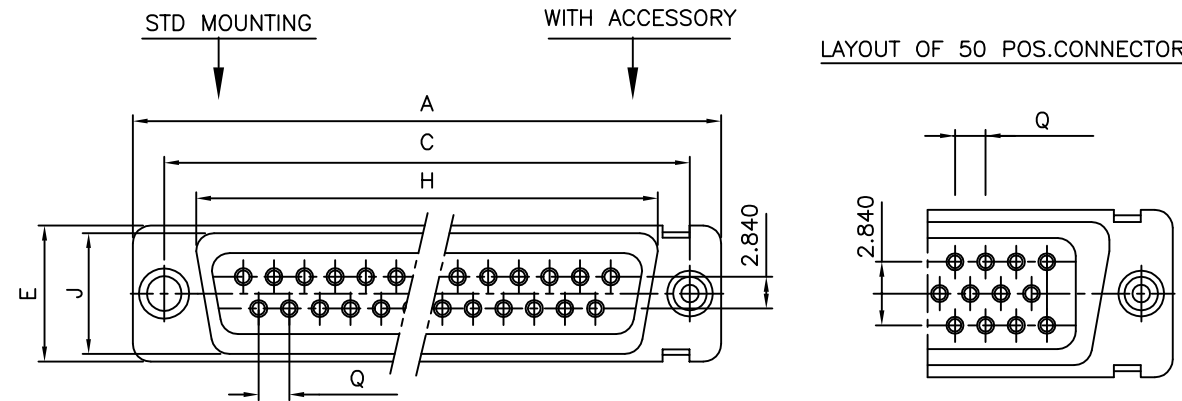

Part No. & Date code Printing

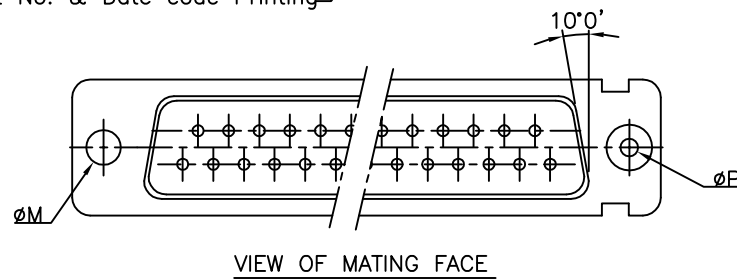

ORDERING INFORMATION

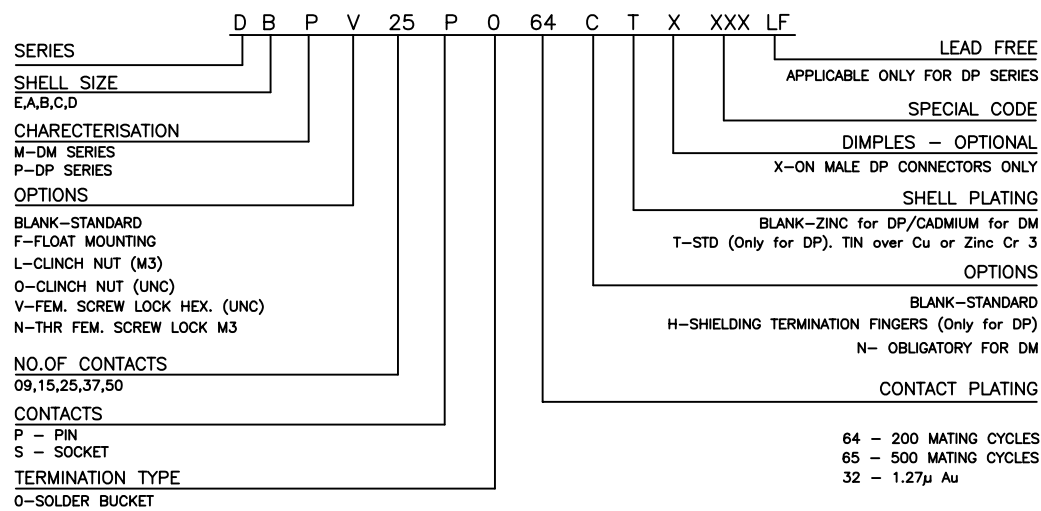

"This LF product meets European Union Directives and other country regulations as described in GS-47-0004"

Packaging as per GS-14-920

WITH SHIELDING TERMINATION FINGERS

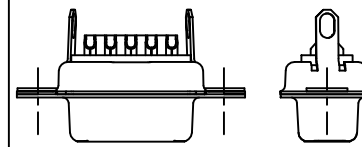

OPTION: H

MALE LEVER LOCK

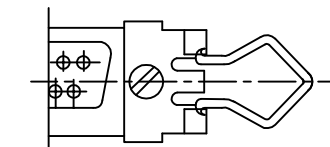

ORD CODE 8630-3427(EABC)  
" 8630-3428(D)

FEMALE LEVER LOCK

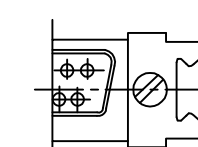

ORD CODE 8630-3425(EABC)  
" 8630-3426(D)

CLINCH NUT

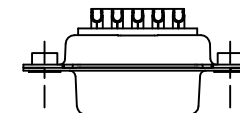

PREFIX:  
O - UNC4-40  
L - M3

RIVETTED FEMALE SCREW LOCK

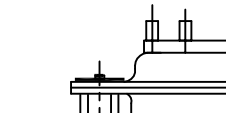

PREFIX: V  
UNC 4-40,2B  
THREAD

50	P	66.65	52.68	61.11	11.08	14.99	11.09	5.85	55.07	13.31	1.50	1.0	3.10	3.05	2.20	2.76
	S	66.65	52.30	61.11	10.62	14.99	11.21	6.05	55.07	13.31	1.10	0.8	3.10	2.85	2.20	2.76
37	P	68.94	55.30	63.50	8.23	12.17	11.09	5.85	57.45	10.46	1.50	1.0	3.10	3.05	2.20	2.76
	S	68.94	54.71	63.50	7.77	12.17	11.21	6.05	57.45	10.46	1.10	0.8	3.10	2.85	2.20	2.76
25	P	52.65	38.84	47.04	8.23	12.17	11.07	5.85	41.02	10.46	1.10	0.8	3.10	2.85	2.20	2.76
	S	52.65	38.25	47.04	7.77	12.17	11.21	6.05	41.02	10.46	1.10	0.8	3.10	2.85	2.20	2.76
15	P	38.76	25.12	33.32	8.23	12.17	10.99	5.85	27.25	10.46	1.10	0.8	3.10	2.85	2.20	2.74
	S	38.76	24.54	33.32	7.77	12.17	11.21	6.05	27.25	10.46	1.10	0.8	3.10	2.85	2.20	2.74
09	P	30.43	16.79	24.99	8.23	12.17	10.99	5.85	19.02	10.46	1.10	0.8	3.10	2.85	2.20	2.74
	S	30.43	16.21	24.99	7.77	12.17	11.21	6.05	19.02	10.46	1.10	0.8	3.10	2.85	2.20	2.74
SHELL SIZE		A-0	B-0	C	D-0	E-0	F MAX	G-0	H-0	J-0	K±0.20	L-0	M±0.22	N MAX.	P	Q±0.06

NOTE:-INSIDE DIMENSIONS OF MALE AND OUTSIDE DIMENSIONS OF THE FEMALE CONNECTOR.

FEMALE SCREW LOCK

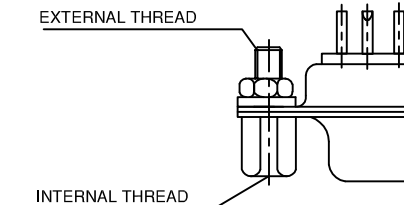

8630-01	M3	M3
8630-01A	M3	4-40 UNC 2
8630-01B	4-40 UNC 2A	4-40 UNC 2B
ORD-CODE	EXTERNAL THREAD	INTERNAL THREAD

FEMALE SCREW LOCK EXTEND TYPE

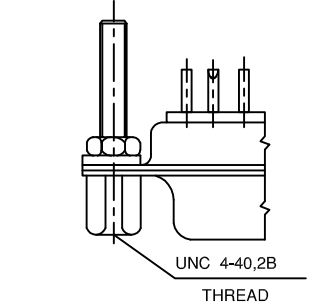

ORD CODE 8630-01-061

TECHNICAL SPECIFICATIONS

- SHELLS : TIN/CADMIUM/ZINC PLATED STEEL
- INSULATOR MATERIAL : SELF EXTINGUISHING THERMOPLASTIC- TO UL CLASS 94 V0
- HOUSING WILL WITHSTAND EXPOSURE TO 260-265°C
- IF USE PROTECTIVE ADHESIVE (type Kapton or Teflon) OR PROTECTIVE METALLIC DEVICE
- CONTACT DIA ON ACTIVE AREA: Ø1 MM.
- CONTACTS MATERIAL : COPPER ALLOY
- CONTACT PLATING : GXT / GOLD OVER NICKEL
- OPERATING TEMPERATURE : -55°C +125°C
- OPERATING CURRENT : 7.5 A PER CONTACT
- CONTACT RESISTANCE : ≤7.3 mΩ
- INSULATION RESISTANCE : ≥5000 MΩ
- MAXIMUM VOLTAGE : 1000 V.r.m.s
- MECHANICAL ENDURANCE : 500 MATINGS FOR CODE 65 & 32
- DAMP HEAT : 200 MATINGS FOR CODE 64
- : 56 DAYS FOR CODE 65 & 32
- : 21 DAYS FOR CODE 64

mat'l. code SEE NOTES				surface ISO 1302 ✓		tolerance ISO 406 ISO 1101		projection 		product family D-SUB	
ltr ecn no dr date				tolerances unless otherwise specified		linear .00±0.25 .000±0.1		mm		title D-SUB S/B CONNECTOR (DP&DM SERIES WITH ASSEMBLY OPTIONS)	
N ELX-I-25321 GREGAR 2016-14-11				angles 1'±x'		dr MINI K VANDANATH 1999-03-20		engr MITHUN PAUL 2016-14-11		dwg no sheet 1 of 1	
						chr GREGAR MATHEW 2016-14-11		appd BIJU K PAUL 2016-14-11		size A3	
sheet index				revision sheet		1 1				type Product Customer Drawing	

# Mouser Electronics

Authorized Distributor

Click to View Pricing, Inventory, Delivery & Lifecycle Information:

## [FCI / Amphenol:](#)

[D25S91C6GV4DLF](#) [DDP50P065TXLF](#) [DEPL09P065TXLF](#) [DBP25P064LORLF](#) [DAP15S064LORLF](#)  
[DAPL15S065TLF](#) [DAPO15S064TLF](#) [DAP15P064LORLF](#) [DBP25S064LORLF](#) [DDP50S064LORLF](#)  
[DCP37P064LORLF](#) [DEP09S064LORLF](#) [DCP37S064LORLF](#) [DEP09P064LORLF](#) [DDP50P064LORLF](#)  
[DEPO09P065TXLF](#) [DDP50S065TLF](#)