

P.C.B LAYOUT

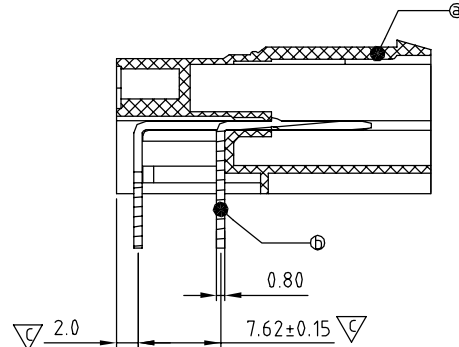
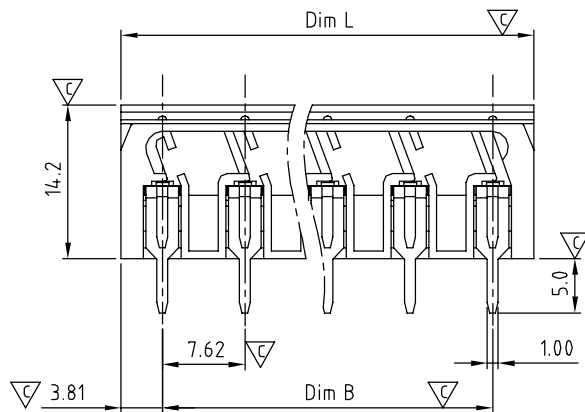

| SIGN | DATE | DESCRIPTION | APPROVER |
|--|------------|--|----------|
| △ | 10/6'06 | Added cULus logo | Steady |
| △ | 1/31'07 | Soldering temperature changed from 245° to 250° | Tony |
| △ | 04/08'09 | The current rating and operating temperature are changed | Jacke |
| △ | 04/08'09 | Add the tolerance table | Jacke |
| △ | 2009.12.19 | The material is changed from Brass to Copper | Jacke |
| △ | 07/31'12 | Added TUV standard | Chen Bo |
| △ | 07/31'12 | The IEC spec is removed | Chen Bo |
| △ | 07/31'12 | Soldering temperature changed from 250°C±10°C/5Sec to 260°C±5°C/5Sec | Chen Bo |
| THIS IS CAD DRAWING, DO NOT REVISE MANUALLY!!! | | | |

Material

- Item a Male contact pin : Copper with Tin plated
- Item b Terminal (housing):Thermoplastic (UL94V-0)

| Electrical | cULus | TUV |
|--------------------------|-----------------|------|
| ● Voltage rating: | 300V | 800V |
| ● Current rating: | 32A | 32A |
| ● Withstanding Voltage: | 1.6KV | 6KV |
| ● Operating temperature: | -40°C to +115°C | |
| ● Soldering temperature: | 260°C±5°C/5 Sec | |
| ● Safety Approval: | | |
| ● Critical dimension: | | |



VC xx 00 x 0 xxxx G

Solid Block
02 2 POLES
03 3 POLES
... ..
16 16 POLES

COLOR

0 Black (RAL9005)
2 Red (RAL3001/D)
3 Orange(RAL2011/P)
4 Yellow(RAL1018/A)
5 Green(RAL6018/T)
6 Blue (RAL5015/A)
8 Grey(RAL7035/D)

G RoHS compliant
(lead<4%)
In copper Alloy

000 0 Standard @ Logo
000 A Standard ANY Logo
Any special item by
customer request,
please contact sales
department.

| DIM | | TOL | | | |
|-------|------------|-------|--------|---------|---------|
| | | 2P-5P | 6P-10P | 11P-13P | 14P-16P |
| Dim L | N×7.62 | ±0.20 | ±0.30 | ±0.35 | ±0.40 |
| Dim B | (N-1)×7.62 | ±0.20 | ±0.30 | ±0.35 | ±0.40 |

ANYTEK

CUSTOMER COPY

ALL RIGHTS RESERVED. REPRODUCTION OR ISSUE TO THIRD PARTIES IN ANY FORM WHATEVER IS NOT PERMITTED WITHOUT WRITTEN AUTHORITY FROM THE PROPRIETOR. PROPERTY OF ANYTEK TECHNOLOGY CO., LTD

| | | | | | |
|----------|--------------------------------|---------------------|---------------------|--|---|
| TITLE | VC 7.62 SERIES 90D Right angle | | | | |
| PART NO. | VCxx00x0xxxxG | | DWG NO. | 8VC0001 | |
| APPROVED | CHECKED | DESIGNED | DRAWN | CUST NO. | Tolerance |
| | | Chen Bo 07/31'12 | Chen Bo 07/31'12 | | X. ±0.50 X.X ±0.30 X.XX ±0.10 X° ±1° |
| | | | | UNIT: mm SCALE: NONE SHEET: 01/01 REV.: H | |

Mouser Electronics

Authorized Distributor

Click to View Pricing, Inventory, Delivery & Lifecycle Information:

Amphenol:

[VC1200500000G](#) [VC1600500000G](#) [VC0300500000G](#) [VC0800500000G](#) [VC0900500000G](#) [VC1500500000G](#)
[VC0700500000G](#) [VC1100500000G](#) [VC1000500000G](#) [VC0500500000G](#) [VC0600500000G](#) [VC1400500000G](#)
[VC1300500000G](#) [VC0400500000G](#) [VC0200500000G](#) [VC0800000000G](#)