

DETAIL-A

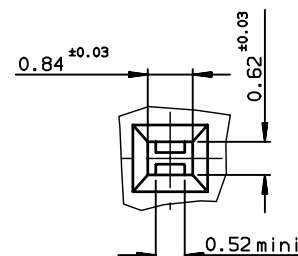

SECTION-FF

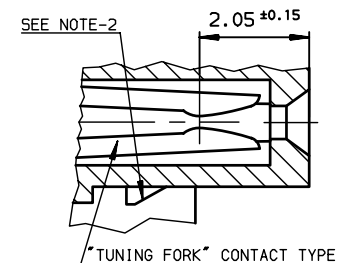

DETAIL OF PRESS-IN PEGS

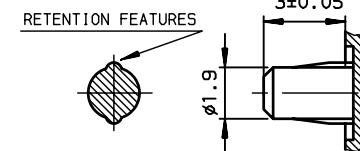

LAYOUT FOR P.C.B

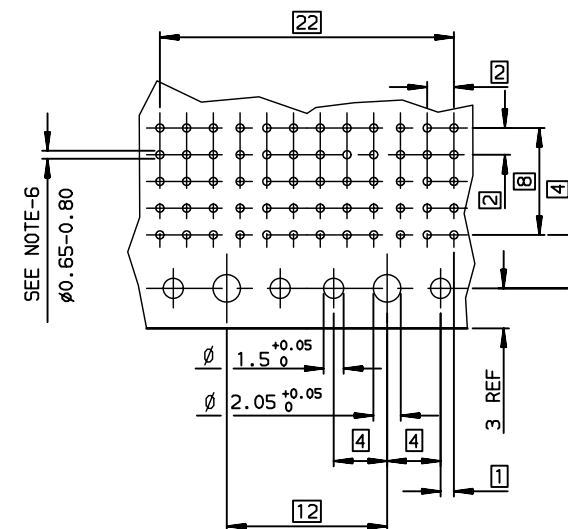

(REDUCED SCALE SHEET)

TIN LEAD PART NUMBER

Part Number: HM1F52FDP400H6P

LEAD FREE PART NUMBER

Part Number: HM1F52FDP400H6PLF

NOTE-1: PRESS-IN RETENTION PEG

SPECIFIC DATA:

NOTE-2: PLUG FOR CODING KEY FIXING

VISUAL INSPECTION: 100%

NOTE-3: EYE OF THE NEEDLE PRESS-FIT CTS TYPE

- marking failure
- housing material failure

NOTE-4: FLAT ROCK INSERTION TOOLING IN PCB,

- spoilt housing

SEE DRW REF:C-8626-1003

NOTE-5: METALIZED HOLE DEFINITION,SEE

- stained housing
- broken contacts (twisted or loosen)

DRW REF:C01-8626-000P

rev	ecn no	dr	date
A	-	-	-
B	LS05-004	MLE	2005/02/11
C	LS06-0092	MLE	2006/06/01
-	-	-	-
-	-	-	-
-	-	-	-

GENERAL CHARACTERISTICS AND ROHS INFORMATIONS: SEE DRAWING C-8626-000P

European Views

www.fciconnect.com			surface ISO 1302	tolerance std ISO 406 ISO 1101	projection mm	size A3		Scale 2.5
TOLERANCES UNLESS OTHERWISE SPECIFIED			ANGULAR	LINEAR	0.X ±0.1	size A3		Scale 2.5
0.XX ±0.1			0.XX ±0.1	0.XXX ±0.1	ECN LS06-0092		Spec ref -	
Product family			METRAL		Spec ref -		Rev. C	
METRAL FEMALE 5 ROWS			60 CTS REIGHT ANGLE PF		C-8626-11139		sheet 1 of 1	
catalog no			-		CUSTOMER		Printed: Jun 03, 2006	

Mouser Electronics

Authorized Distributor

Click to View Pricing, Inventory, Delivery & Lifecycle Information:

[FCI / Amphenol:](#)

[HM1F52FDP400H6PLF](#)