

THIS DOCUMENT IS SUBJECT TO CHANGE WITHOUT NOTICE. IT IS CONFIDENTIAL AND A PROPERTY OF Amphenol LTW. DISCLOSURE TO THIRD PARTY HAS TO BE AUTHORIZED BY Amphenol LTW.

REV.	ECN NO.	DATE	SIGN	DESCRIPTION
B	LEN1741179	2017/04/11	Ruru	Change Logo
C	C200908	2020/06/16	Ruru	$\triangle C$ X3

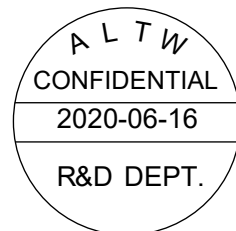
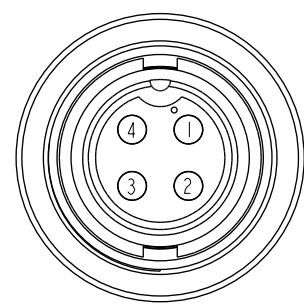
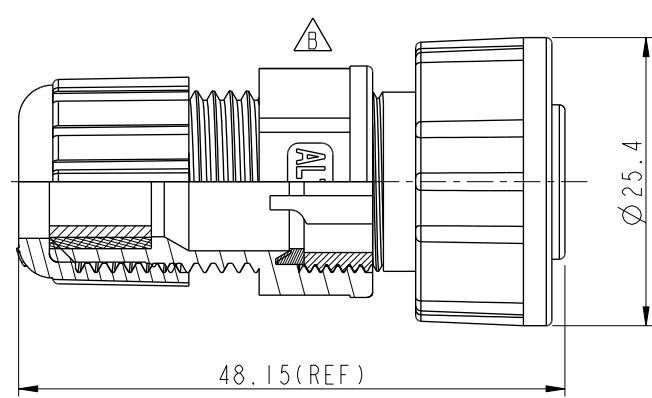
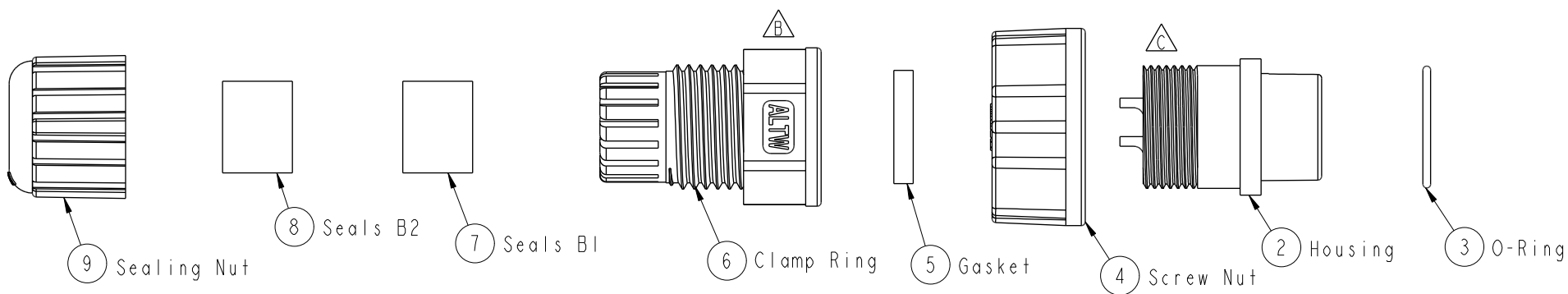

- $\triangle C$ Note:
- * CC Important Dimension
 - * Waterproof Rate : IP67
 - * Housing: Thermoplastic, Black
 - * Pin: Copper Alloy, Gold Plated
 - * Screw Nut: Thermoplastic, Black
 - * O-Ring: Rubber, Black
 - * Gasket : Rubber, Black
 - * Seals : Rubber, Black
 - * Clamp Ring: Thermoplastic, Black
 - * Sealing Nut: Thermoplastic, Black
 - * Seals B1 for Cable OD: $\varnothing 7.6\text{mm} \sim \varnothing 9.6\text{mm}$
 - * Seals B2 for Cable OD: $\varnothing 4.0\text{mm} \sim \varnothing 7.6\text{mm}$
 - * One Set Unassembled in one PE Bag

UNIT:mm		TITLE CERES, C-10A, 04P, CABLE W/O SR F, M, FI SOLDER, SCREW $\triangle C$		Amphenol LTW		ITEM NO CB-04BFMA-SL7001	DRAWN BY Ruru	DATE 2017-04-11
TOLERANCE .X ± 0.25 .XX ± 0.1 .XXX ± 0.05 ANGLES $\pm 1^\circ$		SCALE 1:1	SIZE A4	SHEET 1 OF 1	DWG NO CB-04BFMA-SL7001		CHECKED BY Rita	DATE 2017-04-11
REV. C		WC-REV. A.3	CC : Inspection item		CUSTOMER ALTW		APPROVED BY Max	DATE 2017-04-11

安費諾亮泰企業股份有限公司

Mouser Electronics

Authorized Distributor

Click to View Pricing, Inventory, Delivery & Lifecycle Information:

[Amphenol:](#)

[CB-04BFMA-SL7001](#)