

4				3
ITEM #	PART #	QTY	DESCRIPTION	MATERIAL
1	AP-176-1	1	SHELL ASSY	GLASS FILLED NYLON & 303 SS
2	AP-146-6	1	INSERT ASSY	DIALLYPHTHALATE, TYPE SDGF & GOLD PLATED BRASS
3	AP-105-5	1	STRAIN RELIEF	NYLON
4	AP-116-3	1	WASHER	RUBBER
5	AP-116-7	1	NUT ADAPTER	ALUMINUM, ANODIZED

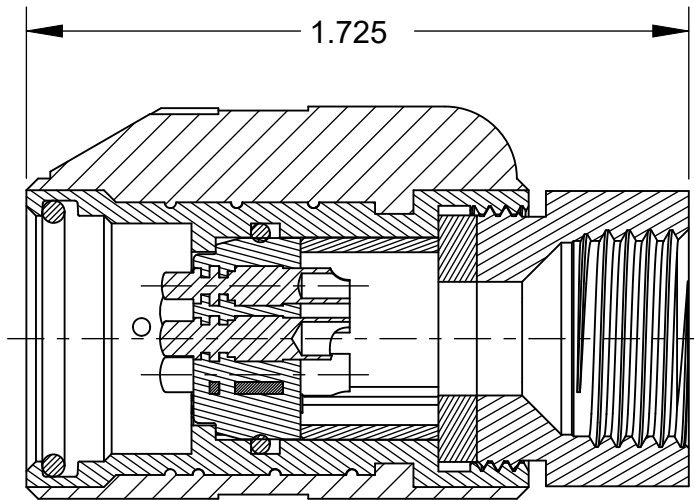
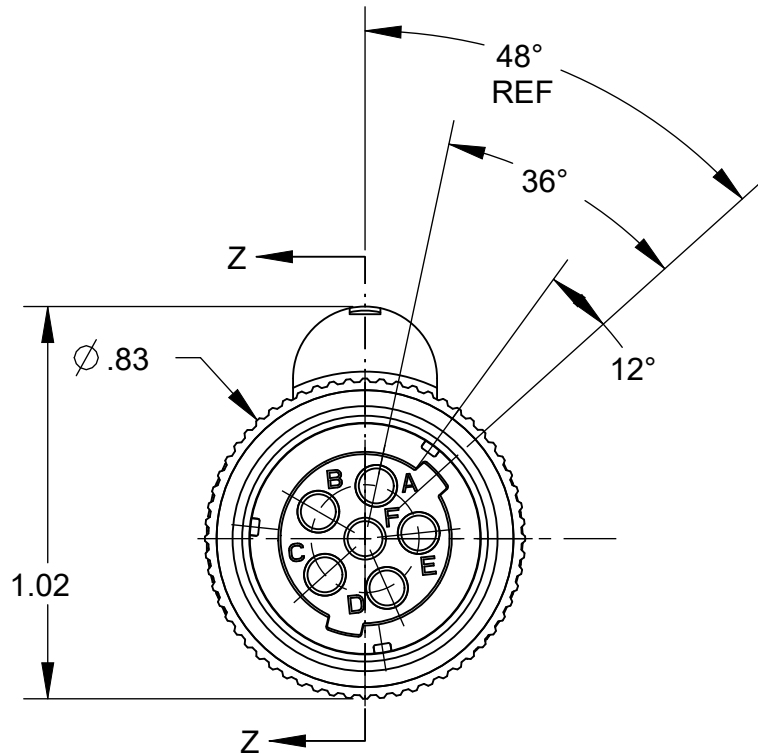
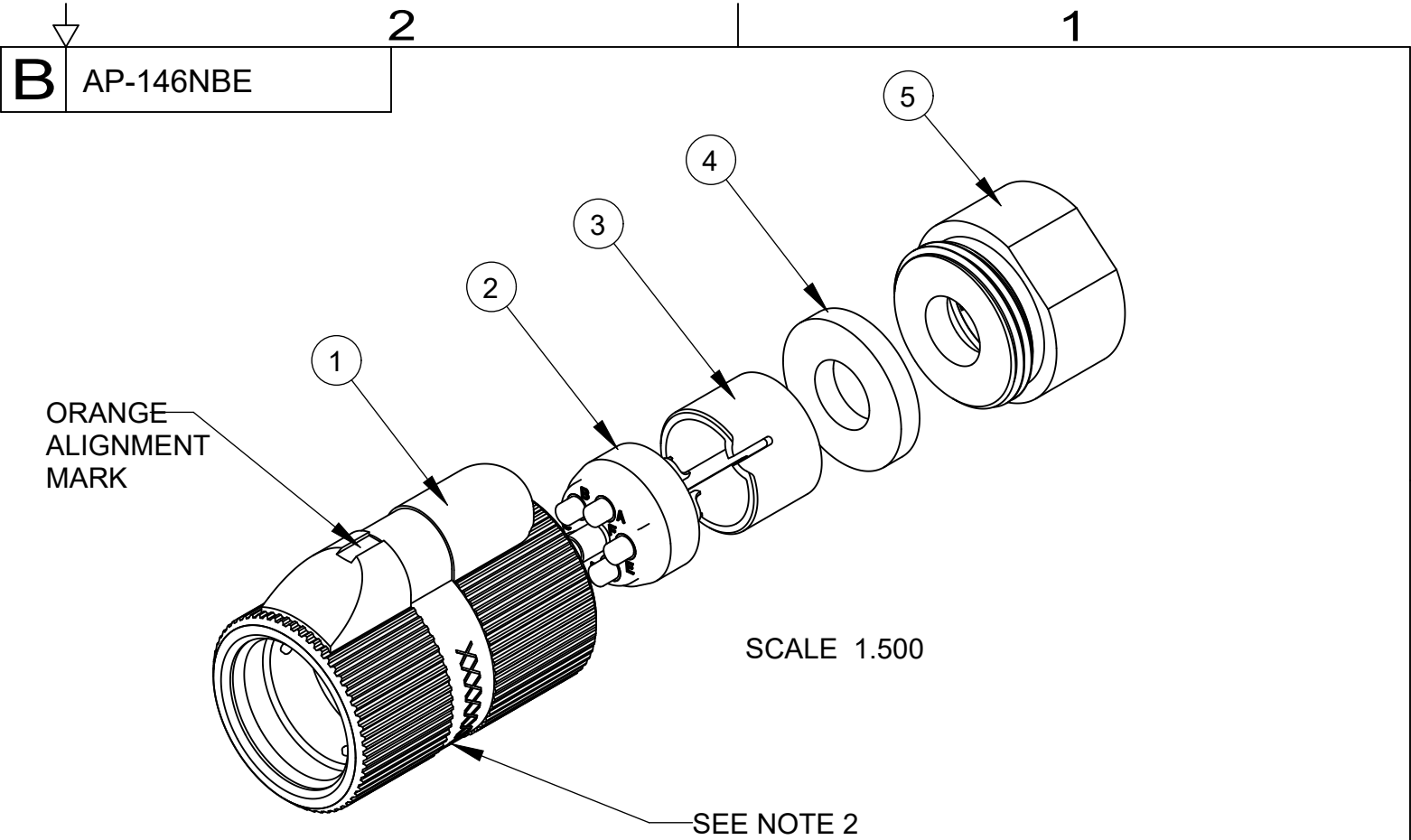

THIS DOCUMENT CONTAINS PROPRIETARY INFORMATION OF NEXUS, INCORPORATED AND SUCH INFORMATION MAY NOT BE DISCLOSED TO OTHERS FOR ANY PURPOSE OR USED FOR ANY PURPOSE WITHOUT THE WRITTEN CONSENT OF NEXUS.

NOTES:
1) UNLESS OTHERWISE SPECIFIED, CONNECTOR MEETS ALL GENERAL REQUIREMENTS & SPECIFICATIONS OF MIL-C-55116
2) MARK MANUFACTURER'S NAME AND CAGE CODE LOCATED APPROXIMATELY AS SHOWN

A	NEW RELEASE		6/11 2018	SPL
LET.	REVISION	CN #	DATE	CHK.

DWN.BY	SPL	DATE Jun-11-18	MATERIAL					
CHECKED BY		DATE	FINISH					
APPR.BY		DATE	WEIGHT —		SCALE = 2.00 :1		NEXUS STAMFORD,CONN	
UNLESS OTHERWISE SPECIFIED DIMENSIONS ARE IN INCHES TOLERANCES ON .XX .XXX ANGLES — ±.003 ±.5°			TITLE AUDIO PLUG					
			DO NOT SCALE DWG.		SHEET 1 OF 1		SIZE B	DWG. NO. AP-146NBE

Mouser Electronics

Authorized Distributor

Click to View Pricing, Inventory, Delivery & Lifecycle Information:

[Amphenol:](#)

[AP-146NBE](#)