

TJSE20100

PART NUMBER TABLE

PART NUMBER LESS CONTACTS	PART NUMBER WITH (3) M39029/1-101 CONTACTS	GLOBAL RESISTOR PART NUMBER	RESISTANCE (Ω)	POWER RATING	PART MARKING
TJSE20100	TJSE20100WC	RLR20C1002FS	10K ± 1%	1/2 W	TJSE20100
TJSE20101	TJSE20101WC	RLR20C22R0GS	22 ± 2%		TJSE20101
TJSE20102	TJSE20102WC	RLR20C56R0GS	56 ± 2%		TJSE20102
TJSE20103	TJSE20103WC	RLR20C3300GS	330 ± 2%		TJSE20103
TJSE20104	TJSE20104WC	RLR20C4300GS	430 ± 2%		TJSE20104
TJSE20113	TJSE20113WC	RLR20C1200GS	120 ± 2%		TJSE20113
TJSE20120	TJSE20121	RLR20C18R0GS	18 ± 2%	1 W	TJSE20121
TJSE20105	TJSE20105WC	RWR81S75R0FS	75 ± 1%		TJSE20105
TJSE20106	TJSE20106WC	RWR81S1100FS	110 ± 1%		TJSE20106
TJSE20107	TJSE20107WC	RWR81S80R6FS	80.6 ± 1%		TJSE20107
TJSE20108	TJSE20108WC	RWR81S49R9FS	49.9 ± 1%		TJSE20108
TJSE20126	TJSE20127	CPF15K100F	5.1K ± 1 %		TJSE20127
TJSE20116	TJSE20117	RNMF14FTC6K80	6800 ± 1%	1/4 W	TJSE20117
TJSE20128	TJSE20129	RLR07C5900FS	590 ± 2%		TJSE20129
TJSE20130	TJSE20131	RLR07C6R80GM	6.8 ± 2%		TJSE20131
TJSE20132	TJSE20133	RLR07C4022FS	40.2K ± 1%		TJSE20133
TJSE20136	TJSE20137	RNMF14FTC82K0	82K ± 1%		TJSE20137
TJSE20138	TJSE20139	RLR07C5903FS	590K ± 1%		TJSE20139
TJSE20124	TJSE20125	RWR80S169FR	1690 ± 1%	2 W	TJSE20125
TJSE20134	TJSE20135	RWR80S1001FRB12	1000 ± 1%		TJSE20135

REV	ECN	APP'D
C	6861	MD 10/16/12
D	7231	JT 1/4/14
E	7428	JT 1/8/15
F	7640	JT 11/6/15
G	7699	JT 4/8/16
H	7750	JT 4/25/16
J	7800	JT 8/11/16
K	7834	JT 9/20/16

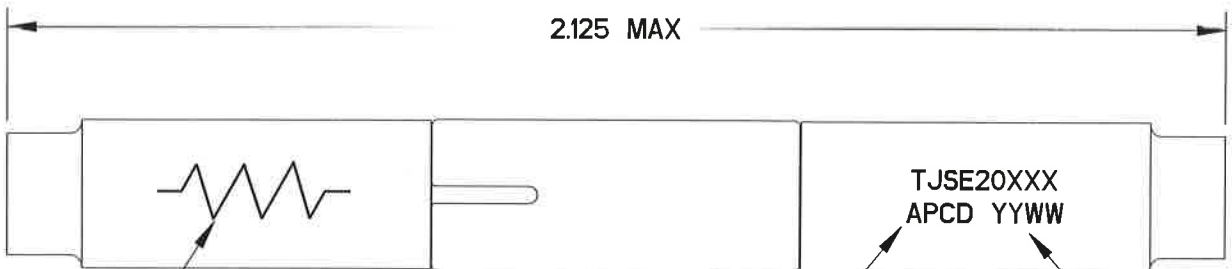
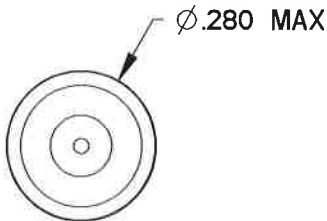

SCHEMATIC MARKING
COLOR: WHITE

PART MARKING
SEE TABLE ABOVE
FOR PART NUMBER
& RESISTOR

DATE CODE

NOTES:

- MATERIALS:
HOUSING: POLYETHERIMIDE, COLOR BLACK
GROMMET: SILICONE ELASTOMER, COLOR BLUE
INTERNAL CONTACT: COPPER ALLOY, GOLD PLATED,
PER MIL-DTL-45204, TYPE I, GRADE C, CLASS I.
CONTACT RETAINER: STAINLESS STEEL
- SPLICE ACCEPTS (2) MATING M39029/1-101 CONTACTS
- PART COMPLIES TO ALL REQUIREMENTS PER SAE-AS81714
- RESISTOR: SEE PART NUMBER TABLE

DIMENSIONS	TOLERANCES	PROJECTION	Amphenol Pcd SPECIFICATION DRAWING		TITLE WIRE SPLICE SINGLE RESISTOR, VARIOUS SIZE 20					
ANSI Y14.5M UNITS: INCHES Pro/E FILE	.XX ±0.01 .XXX ±0.005 ANGLES ±2.0°		DRWN	R. SWAINE Jan-08-16	SIZE B	DWG NO. TJSE20100	REV K	CODE: 58982	SCALE: 3:1	SHEET 1 OF 1
ORIGINAL	THIS DOCUMENT CONTAINS PROPRIETARY INFORMATION WHICH IS THE CONFIDENTIAL PROPERTY OF AMPHENOL PCD, BEVERLY, MA		ENGR 	9/20/16						
			APPD 	9/20/16						

Mouser Electronics

Authorized Distributor

Click to View Pricing, Inventory, Delivery & Lifecycle Information:

[Amphenol:](#)

[TJSE20128](#)