

M12 A-CODED  
5P FEMALE

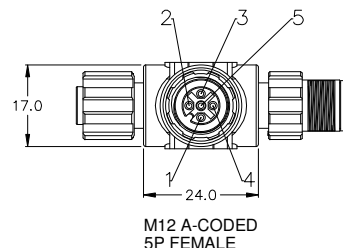

M12 A-CODED  
5P MALE

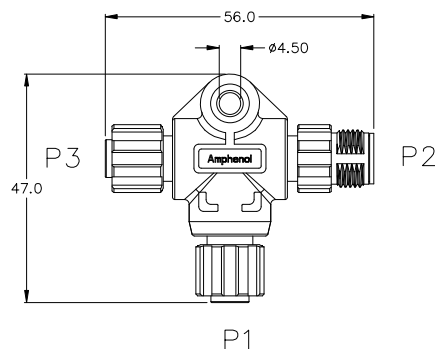
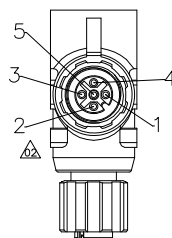
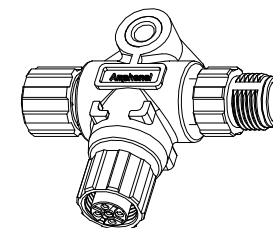
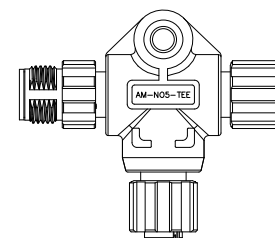
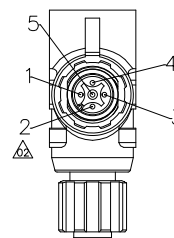

WIRING DIAGRAM

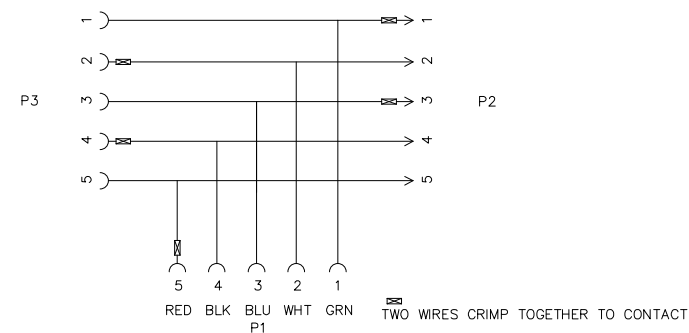

# TECHNICAL DATA:

## 1) CONNECTOR MATERIALS

COUPLING NUT: THERMOPLASTIC, NYLON, UL94 V-0  
INSULATION INSERT: THERMOPLASTIC, NYLON, UL 94V-0  
MACHINED CONTACT: GOLD FLASH PLATING OVER COPPER ALLOY  
PREMOLD MATERIAL: HOTMELT;  
OVERMOLD MATERIAL: THERMOPLASTIC, TPU COLOR: BLACK  
WIRE:UL1007 22AWG 105C° 300V, PVC  
ALUMINUM TUBE:ALUMINIUM ALLOY  
SEAL:EPDM,RED

## 2) RoHS COMPLIANT

## 3) CONNECTOR SPECIFICATION

VOLTAGE RATING: 60V  
AMPERAGE RATING: 4 AMPS  
CONTACT RESISTANCE: ≤ 5 mΩ  
INSULATION RESISTANCE:≥ 100 MΩ  
PROTECTION CLASS: IP67  
OPERATING TEMPERATURE: -25°C~90°C

# REVISIONS

REV	ECO	DESCRIPTION	DATE	BY	APPR
A1	-	RELEASE	28MAR16	JAH	KING

TITLE:

MULTI-HUB TEE, NMEA 2000

DWG NO:

AM-N05-TEE

REV: A1

SH: 1

OF: 1

# CUSTOMER DRAWING

QUANTITY	PART NUMBER	DESCRIPTION	ITEM
MATERIALS LIST			
UNLESS OTHERWISE SPECIFIED: 1) All dimensions are in metric (mm). 2) Tolerances are as follows: 1 PL DEC ±1.27 Fractions ±0.40 2 PL DEC ±0.25 Angles ±1° 3 PL DEC ±0.127 4) Note reference =  L MATERIAL SPECIFICATIONS: NOTED PROCESS SPECIFICATIONS: IPC/WHMA-A-620 NEXT ASSY:		SIGNATURES DATE DRAWN: FLAN 2015-8-13 CHECKED: CHELSEA 2015-8-13 ENGINEER: APPROVAL: KING 2015-8-13 CUSTOMER: THIS DRAWING IS SUPPLIED FOR INFORMATION ONLY. DESIGN FEATURES, SPECIFICATIONS AND PERFORMANCE DATA SHOWN HEREON ARE THE PROPERTY OF THE AMPHENOL CORPORATION. NO RIGHTS OF REPRODUCTION ARE IMPLIED. ALL DIMENSIONS ARE SUBJECT TO NORMAL MANUFACTURING VARIATIONS.	
Amphenol		Sine Systems - www.amphenol-sine.com 44724 Morley Drive Clinton Township, MI 48036	
MULTI-HUB TEE, NMEA 2000		SIZE: A4 C FSCM NO: DWG NO: AM-N05-TEE REVISION: A1 SCALE: NONE AM-N05-TEE SHEET 1 OF 1	

# Mouser Electronics

Authorized Distributor

Click to View Pricing, Inventory, Delivery & Lifecycle Information:

[Amphenol:](#)

[AM-N05-TEE](#)