

REV.	ECN NO.	DATE	SIGN	DESCRIPTION
B	C190346	2019/03/05	Vicky	Change Note

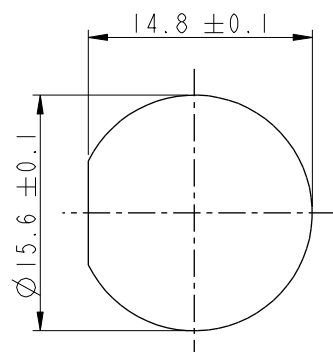

Recommended Panel  
Cut-Out

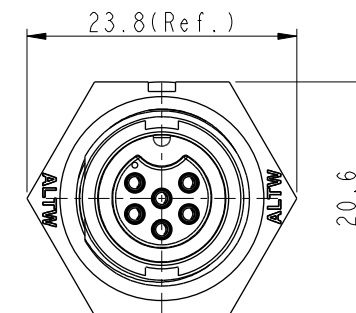
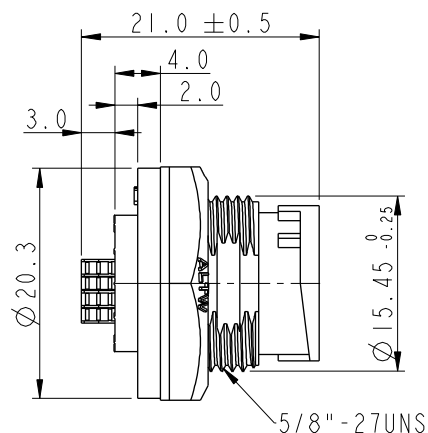
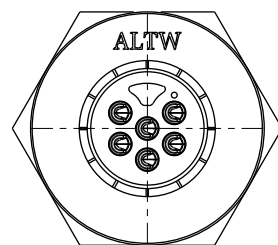

With Liquid Glue

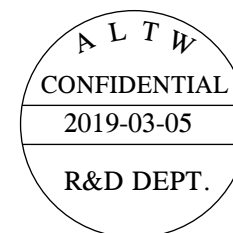
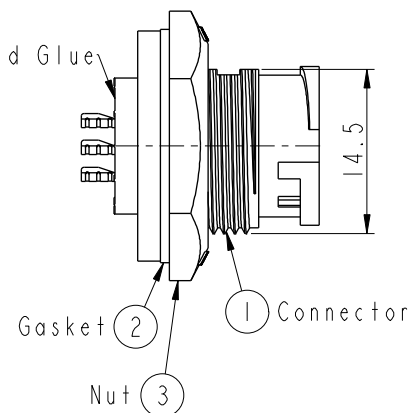

Note:

- \*  $\varnothing$  Important Dimension To Check.
- \* Waterproof Rate: IP67, Unmated.
- \* Housing: Thermoplastic, Black
- \* Pin: Copper Alloy, Gold Plated.
- \* Nut: Thermoplastic, Black.
- \* Gasket: Rubber, Gray.
- \* Use with waterproof cap or dust cap  
Maximum Panel Thickness: 2.8mm
- \* Use without waterproof cap or dust cap  
Maximum Panel Thickness: 4.0mm
- \* Gasket and Nut are packed separately  
in PE bags. (Gasket/Nut不組裝, 散裝出貨)

ABD-XXPMFS-LC7001  
02: 2Pin  
06: 6Pin

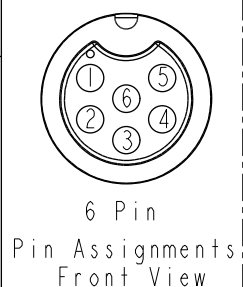

6 Pin

Pin Assignments  
Front View

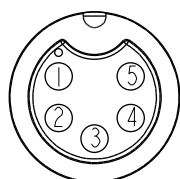

5 Pin

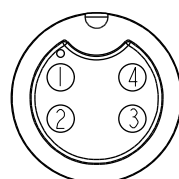

4 Pin

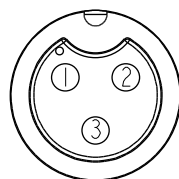

3 Pin

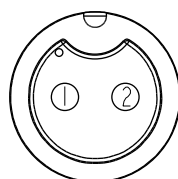

2 Pin

Pin Assignments Front View

UNIT: mm	
TOLERANCE	
.X	±0.25
.XX	±0.1
.XXX	±0.05
ANGLES	±1°

TITLE STANDARD PANEL LOCK M CONN F PIN			
SCALE 3:2	SIZE A4	SHEET 1 OF 1	
REV. B	WC-REV. A.1	QC: Inspection item	

**Amphenol LTW**  
安費諾亮泰企業股份有限公司

ITEM NO.	DRAWN BY Vicky	DATE 2019-03-05
DWG. NO. ABD-XXPMFS-LC7001	CHECKED BY Rita	DATE 2019-03-05
CUSTOMER ALTW	APPROVED BY Max	DATE 2019-03-05

# Mouser Electronics

Authorized Distributor

Click to View Pricing, Inventory, Delivery & Lifecycle Information:

[Amphenol:](#)

[ABD-03PMFS-LC7001](#) [ABD-06PMFS-LC7001](#)