

PRODUCT NUMBER
SEE TABLE

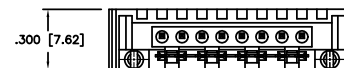
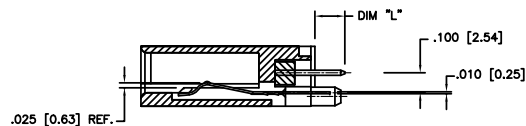
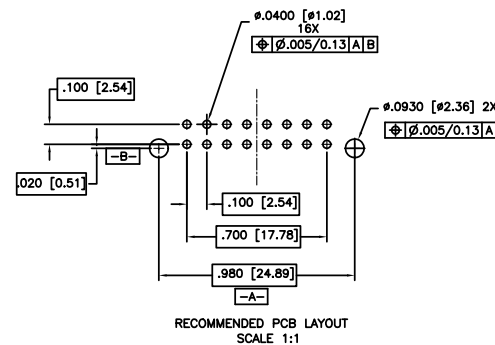
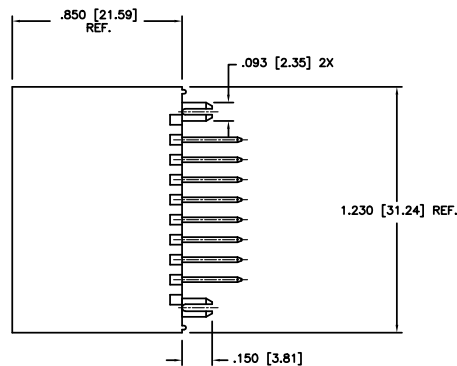

mat'l. code		surface		tolerance		projection		product family	
		ISO 1302 ✓		ISO 406 ISO 1101				LATCH-N-LOK	
l	tr	ec	n	dr	date	tolerances unless otherwise specified		title	
K	ELX-N-008459	ZK	11/29/11			angles	linea	1X8 VERTICAL HEADER ASSEMBLY	
E	M04-0230	MHT	12/8/04			0°±2'		dwg no	
F	M05-0052	ERE	3/19/05	dr	R.G. DRAGGOO	8/3/99		sheet 1 of 2	
G	M06-0285	AGS	7/28/06	engr	T.GARLICK	8/3/99		size	
H	M06-0365	AGS	9/21/06	chr	T.GARLICK	8/3/99		A3	
J	M09-0048	MHT	3/12/09	appd	T.GARLICK	8/3/99		type	
sheet		revision		K		K		Product Customer Drawing	
index		sheet		1		2			

PDS: Rev :K

STATUS: Released

Printed: Jan 06, 2012

98775-XXXXLF

LEAD FREE OPTION ⑥⑦

	COLOR ④	
1	70343 LT GRAY	OBS
2	80166 OFF WHITE	
3	70634 DK GRAY	OBS
4	701 BLACK	
5	70511 SLATE GRAY	OBS
7	70455 SILVER GRAY	
8	80189 PEARL WHITE	OBS
9	70419 PEBBLE GRAY	

	PLATING ③
0	30u" MIN OVER 50u"MIN Ni
3	30u" MIN OVER 50u"MIN Ni
5	50u" MIN OVER 50u"MIN Ni

	PIN LENGTH
	DIM L
0	.150/3.18
1	.110/2.79

NOTES:

1. HEADER SHROUD
MAT'L: HIGH TEMPERATURE THERMOPLASTIC.
UL-94V-0 RATED.
2. GROUND CONTACT
MAT'L: COPPER ALLOY
PLATING: 100-160u"/2.54-4.06u TIN
- ③ SIGNAL CONTACT
MAT'L: COPPER ALLOY
PLATING: PERFORMANCE PLATING WILL BE EITHER GOLD OR GXT
ON CONTACT AREA OR TAIL, OPTIONALLY (78-295u") TIN ON TAIL.
- ④ NUMBERS SHOWN ARE FOR G.E. LEXAN AND
ARE FOR REFERENCE ONLY.
5. THIS ASSEMBLY U.L. APPROVED PER
FILE E66906 VOL. 1, SEC. 84 AND
CSA APPROVED PER MASTER FILE
LR46923
- ⑥ ADD LF SUFFIX AT THE END OF PART NUMBER FOR LEAD FREE OPTION.
7. THE HOUSING WILL WITHSTAND EXPOSURE TO 260°C PEAK TEMPERATURE
FOR 15 SECONDS IN A WAVE SOLDER APPLICATION WITH A 1.5mm
MINIMUM THICK CIRCUIT BOARD. SEE APPLICATION NOTES/PROCEDURES
IF THEY ARE AVAILABLE.
8. THIS PRODUCT MEETS EUROPEAN UNION DIRECTIVES AND OTHER
COUNTRY REGULATION AS DESCRIBED IN GS-22-008.
9. PRODUCT SPEC: GS-12-003

mat'l. code		surface ISO 1302 ✓		tolerance ISO 406 ISO 1101		projection INCH/MM		product family LATCH-N-LOK	
ltr ecn nodr date		tolerances unless otherwise specified		title		dwg no		sheet 2 of 2 size	
K		angles	linea	1X8 VERTICAL HEADER ASSEMBLY		98775		A3	
		0°±2'		scale 1:1		type		Product Customer Drawing	
dr R.G DRAGG00		8/3/99		FCI		sheet		revision	
enr T.GARLICK		8/3/99				index		sheet	
chr T.GARLICK		8/3/99							
appd T.GARLICK		8/3/99							

Mouser Electronics

Authorized Distributor

Click to View Pricing, Inventory, Delivery & Lifecycle Information:

[FCI / Amphenol:](#)

[98775-104LF](#)