

PRODUCT NUMBER  
SEE TABLE

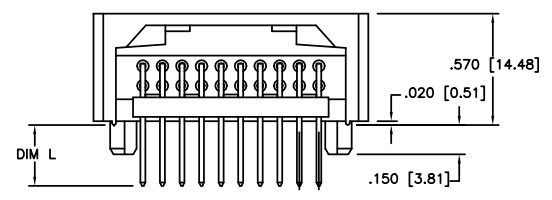
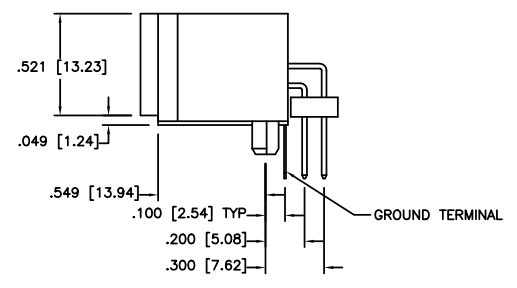
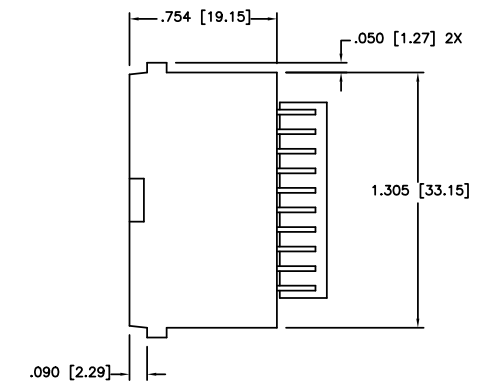

mat'l. code		surface ISO 1302 ✓		tolerance ISO 406 ISO 1101		projection ASME Y14.5		product family LATCH-N-LOK	
ltr ecn nodr date		tolerances unless otherwise specified		title		INCH/MM		2X10 LNL LOW PROFILE RT. ANGLE HEADER ASSEMBLY	
H	ELX-N-008457	ZK	11/28/11	angles	linea	.XXX±.01/0.XX±0.3 .XXX±.005/0.XXX±0.13 .XXX±.0020/0.XXX±0.05		scale 1:1	
C	V10987	TFG	3/1/01	0°±2°				dwg no 79610 sheet 1 of 2 size A3	
D	M05-0062	ERE	4/01/05	chr	M. CORNMAN	10/29/90		FCI	
E	M06-0285	AGS	7/28/06	engr	D. HORCHLER	10/29/90		type Product Customer Drawing	
F	M06-0365	AGS	9/20/06	chr	D. HORCHLER	10/29/90			
G	M09-0048	MHT	3/12/09	app	D. HORCHLER	10/29/90			
sheet	revision	H	H						
index	sheet	1	2						

79610-XXXLF

LEAD FREE OPTION (6) (7)

	COLOR (4)	
1	70343-LT GRAY	OBS
2	80166-OFF WHITE	
3	70634-DK GRAY	OBS
4	701-BLACK	
5	70511-SLATE GRAY	OBS
7	70455-SILVER GRAY	
8	80189-PEARL WHITE	OBS
9	70419-PEBBLE GRAY	

	PLATING (3)
0	30u" MIN OVER 50u"MIN Ni
3	30u" MIN OVER 50u"MIN Ni
5	50u" MIN OVER 50u"MIN Ni

	PIN LENGTH
	DIM L
0	.200/5.08
1	.130/3.30

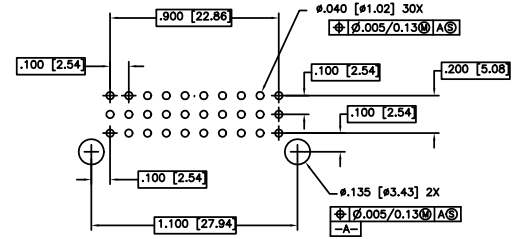

RECOMMENDED PCB LAYOUT

NOTES:

- HEADER SHROUD  
MAT'L: HIGH TEMPERATURE THERMOPLASTIC,  
UL-94V-0 RATED.
- GROUND CONTACT  
MAT'L: COPPER ALLOY  
PLATING: 100-160u"/2.54-4.06u TIN.
- SIGNAL CONTACT  
MAT'L: COPPER ALLOY  
PLATIN OPTION: PERFORMANCE PLATING WILL BE EITHER GOLD OR GXT  
ON CONTACT AREA OR TAIL, OPTIONALLY (78-295u") TIN ON TAIL.
- NUMBERS SHOWN ARE FOR G.E. LEXAN  
AND ARE FOR REFERENCE ONLY.
- THIS ASSEMBLY UL APPROVED PER FILE E66906 VOL 1, SEC. 84  
AND CSA APPROVED PER MASTER FILE LR 46923. PACKAGING
- ADD LF SUFFIX AT THE END OF PART NUMBER FOR LEAD FREE OPTION.
- THE HOUSING WILL WITHSTAND EXPOSURE TO 260°C PEAK TEMPERATURE  
FOR 15 SECONDS IN A WAVE SOLDER APPLICATION WITH A 1.5mm  
MINIMUM THICK CIRCUIT BOARD. SEE APPLICATION NOTES/PROCEDURES  
IF THEY ARE AVAILABLE.
- THIS PRODUCT MEETS EUROPEAN UNION DIRECTIVES AND OTHER  
COUNTRY REGULATION AS DESCRIBED IN GS-22-008.
- PRODUCT SPEC: GS-12-003

mat'l. code		surface ISO 1302 ✓	tolerance ISO 406 ISO 1101	projection INCH/MM	product family LATCH-N-LOK
ltr	ecn	nodr	date	title	
H				2X10 LNL LOW PROFILE RT. ANGLE HEADER ASSEMBLY	
tolerances unless otherwise specified				scale 1:1	dwg no
angles	line	.XXX±.01/0.X±0.3 .XXX±.005/0.XXX±0.13 .XXX±.0020/0.XXX±0.05		sheet 2 of 2	size
0°±2'				79610	A3
dr	M. CORNMAN	10/29/90		type Product Customer Drawing	
engr	D. HORCHLER	10/29/90			
chr	D. HORCHLER	10/29/90			
app	D. HORCHLER	10/29/90			
sheet index	revision sheet				



FCIconnect.com

Copyright FCI

# Mouser Electronics

Authorized Distributor

Click to View Pricing, Inventory, Delivery & Lifecycle Information:

[FCI / Amphenol:](#)

[79610-001LF](#) [79610-002](#) [79610-002LF](#) [79610-004](#) [79610-007](#) [79610-009](#) [79610-104LF](#) [79610-107](#) [79610-109](#)  
[79610-102](#) [79610-102LF](#)