

PRODUCT NUMBER

71600-YXXXLF

- LEAD FREE, SEE NOTE 6
- COLOR OPTION, SEE NOTE 1
- TOTAL NB OF POSITION 04 TO 64 SEE SHEET 2
- OPTIONAL STRAIN RELIEF SEE SHEET 2

TRIANGLE INDICATES POSITION 1
NOTE 5

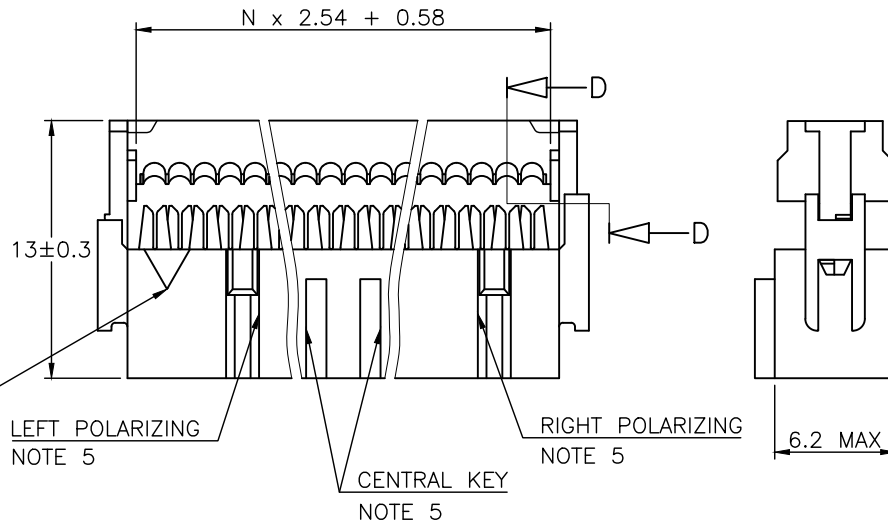

NOTES:

- 1 - HOUSING MATERIAL : GLASS FILLED THERMOPLASTIC. UL94V-0 COLOR: GREY
 = STANDARD COLOR GREY
 B = OPTION COLOR BLACK
- 2 - PIN MATERIAL : PHOSPHOR BRONZE
- 3 - PRODUCT PACKAGED IN TUBES.
- 4 - TO DETERMINE DIMENSIONS :
 N = NUMBER OF POSITIONS PER ROW
 EXAMPLE : 8 POS $N \times 2.54 = 20.32\text{mm}$
- 5 - 2x5, 2x6, 2x7 HAVE NO LEFT POLARIZING SLOT.
 - 2x2, 2x3 WITH CENTRAL KEY HAVE NO TRIANGLE, NO LEFT AND RIGHT POLARIZING SLOT.
 - 2x2 WITHOUT CENTRAL KEY HAS NO LEFT AND RIGHT POLARIZING SLOT.
 - 2x3, 2x4 WITHOUT CENTRAL KEY HAVE NO LEFT POLARIZING SLOT
 - 2x4 WITH CENTRAL KEY HAVE NO LEFT AND RIGHT POLARIZING SLOT
- 6 - THIS PRODUCT MEETS EUROPEAN UNION DIRECTIVES AND OTHER COUNTRY REGULATIONS AS PER GS-22-008. PACKAGING SPECIFICATION AS PER GS-14-920.

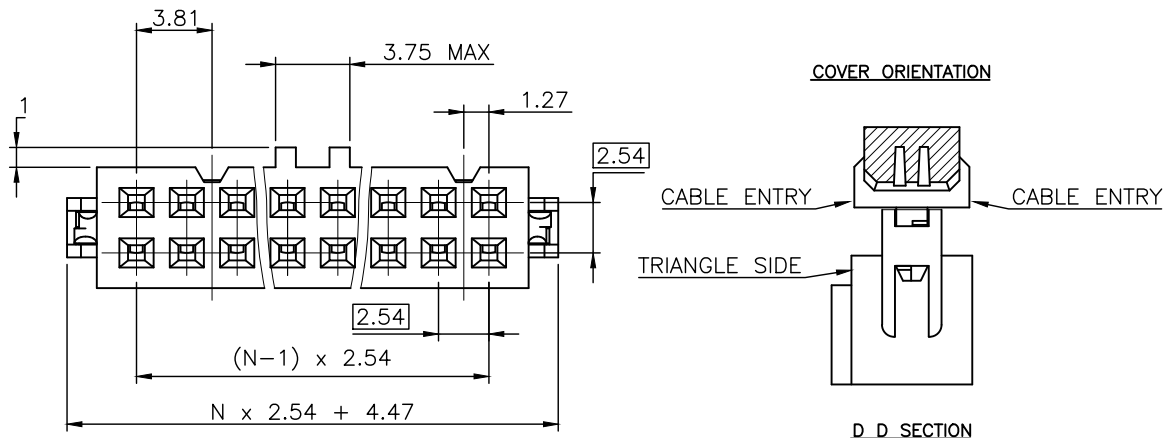

mat'l. code SEE NOTES		surface ISO 1302 ✓		tolerance ISO 406 ISO 1101		projection mm		product family 2.54MM IDC	
lfr ecn no dr date		tolerances unless otherwise specified		X.X ±0.3		mm		title QUICKIE III FEM 0.76µm Au	
AP F12-0046 LMU 12.04.25		angles		X.XX ±0.13		scale 5:1		dwg no 71600	
AR B-17851 LMU 14.06.05		linear		X.XXX ±0.05		FCJ		sheet 1 of 2 size A3	
AS F-26816 LMU 17.06.06		dr		D.LE 01.01.24				type CUSTOMER Drawing	
AL F06-0270 LMU 06.09.12		engr		P.NZ 01.01.24					
AM F06-0274 LMU 06.09.25		chr		JF.N 01.01.24					
AN F09-0233 LMU 09.12.15		appd		P.NZ 01.01.24					
sheet revision AS AG		index sheet 1 2							

STRAIN RELIEF OPTION AVAILABILITY	Nbr OF POSITIONS
1/6	04
0/1/2/3/6	06
0/1/2/3/6	08
0/1/2/3/6	10
0/1/2/3/6	14
0/1/2/3/6	16
0/1/2/3/6	18
0/1/2/3/6	20
0/1/3	24
0/1/2/3/6	26
0/1/2/3/6	30
0/1/2/3/6	34
0/1/2/3/6	40
0/1/2/3/6	50
0/1/2/3/6	60
0/1/2/3/6	64

624
304
204 / 224
004

DASHES NOT AVAILABLE

PLATING
 0.76µm GOLD ON CONTACT AREA
 1.27 µm Ni REMAINDER OF PRODUCT

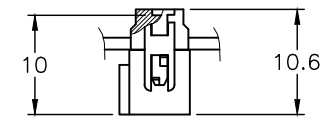

WITHOUT STRAIN RELIEF

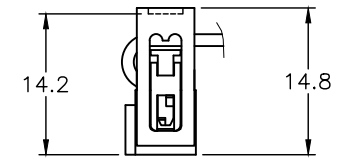

WITH LOW PROFILE STRAIN RELIEF

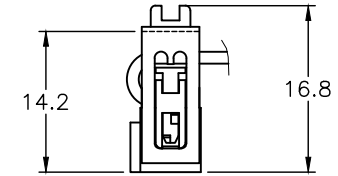

WITH STANDARD STRAIN RELIEF

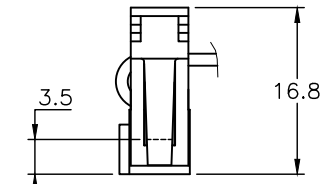

WITH LATCHING STRAIN RELIEF

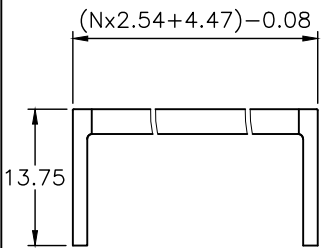

LOW PROFILE STRAIN RELIEF

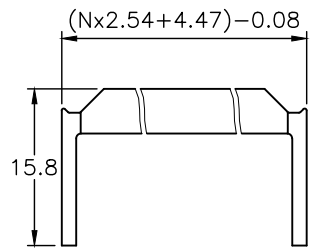

STANDARD STRAIN RELIEF

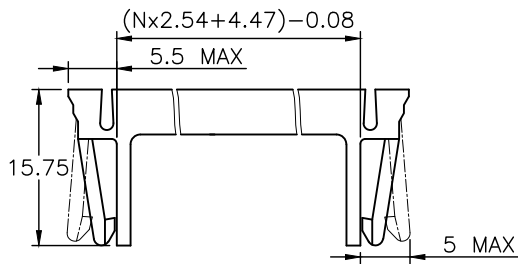

LATCHING STRAIN RELIEF FOR SLIM HEADER

71600-6YY(B)LF	●					●
71600-3YY(B)LF		●	●			
71600-2YY(B)LF	●			●		
71600-1YY(B)LF	●				●	
71600-0YY(B)LF	●		●			
PRODUCT NUMBER	WITH CENTRAL KEY	WITHOUT CENTRAL KEY	STANDARD STRAIN RELIEF	WITHOUT STRAIN RELIEF	LOW PROFILE STRAIN RELIEF	LATCHING STRAIN RELIEF

mat'l. code		surface		tolerance		projection		product family	
		ISO 1302		ISO 406 ISO 1101		mm		QUICKIE	
ltr ecn no dr date		tolerances unless otherwise specified		angles		linear		title	
AF B-17851 LMU 14.06.05								IDC RECEPT DR	
AG F-26816 LMU 17.06.06								scale N/A	
AB F03019 DLE 03.01.23		dr		D.LE		01.01.24		dwg no	
AC F05-0180 LMU 05.04.22		enrg		P.NZ		01.01.24		sheet 2 of - size	
AD F06-0270 LMU 06.09.12		chr		JF.N		01.01.24		71600 A3	
AE F06-0274 LMU 06.09.25		appd		P.NZ		01.01.24		type CUSTOMER Drawing	
sheet index		revision sheet							



Copyright FCI

Mouser Electronics

Authorized Distributor

Click to View Pricing, Inventory, Delivery & Lifecycle Information:

[FCI / Amphenol:](#)

71600-010LF	71600-026LF	71600-040LF	71600-050LF	71600-634LF	71600-240LF	71600-250LF	71600-014LF
71600-016LF	71600-020LF	71600-034LF	71600-110LF	71600-660LF	71600-044LF	71600-314LF	71600-310LF
71600-506LF	71600-614LF	71600-640LF	71600-024LF	71600-018LF	71600-144LF	71600-644LF	71600-618LF
71600-106LF	71600-030LF	71600-140LF	71600-064LF	71600-306LF	71600-060LF	71600-308LF	71600-610LF
71600-134LF	71600-126LF	71600-108LF	71600-006LF	71600-008LF	71600-104LF	71600-114LF	71600-116LF
71600-118LF	71600-120LF	71600-124LF	71600-130LF	71600-150LF	71600-160LF	71600-164LF	71600-206LF
71600-208LF	71600-210LF	71600-214LF	71600-216LF	71600-218LF	71600-220LF	71600-226LF	71600-230LF
71600-234LF	71600-244LF	71600-260LF	71600-264LF	71600-316LF	71600-318LF	71600-320LF	71600-326LF
71600-330LF	71600-334LF	71600-340LF	71600-350LF	71600-360LF	71600-364LF	71600-404LF	71600-406LF
71600-408LF	71600-410LF	71600-414LF	71600-416LF	71600-418LF	71600-420LF	71600-424LF	71600-426LF
71600-430LF	71600-434LF	71600-440LF	71600-444LF	71600-450LF	71600-460LF	71600-464LF	71600-516LF
71600-604LF	71600-606LF	71600-608LF	71600-616LF	71600-626LF	71600-630LF	71600-650LF	71600-664LF
71600-710LF	71600-716LF	71600-726LF	71600-324LF				