

PRODUCT NUMBER
SEE TABLE

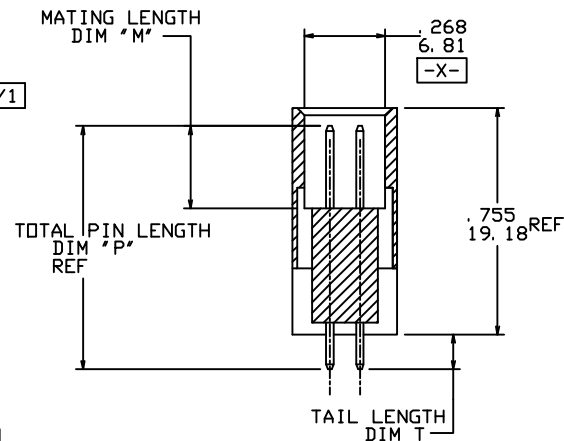

SECTION A-A

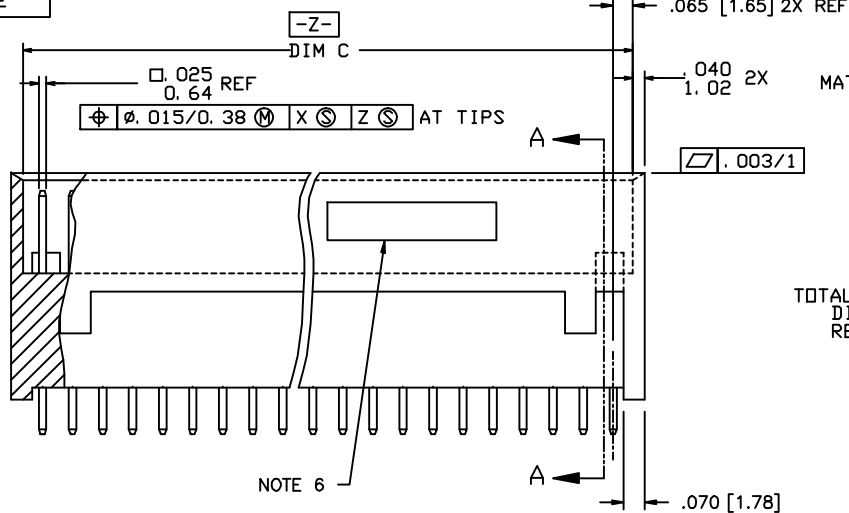
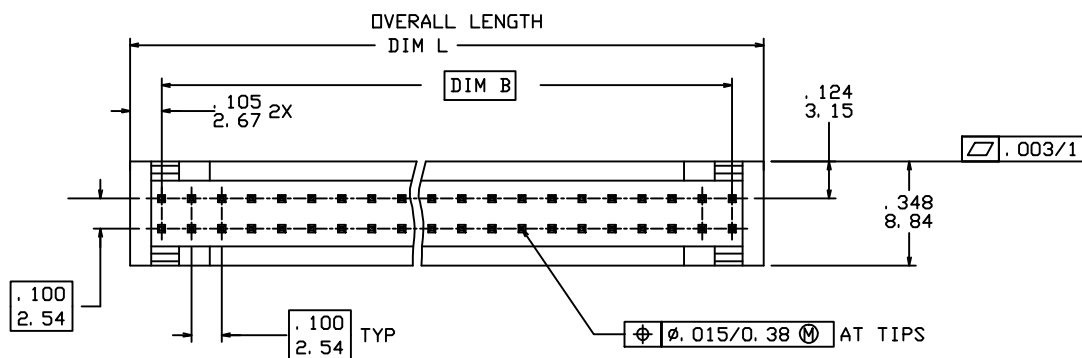

mat'l. code NOTE 3 & 4				surface ISO 802	tolerance ISO 406 ISO 1101	projection	product family
ltr	ecn no	dr	date	tolerances unless otherwise specified		INCH/MM	HEADERS
E	V13304	JWB	12/19/91	angles	linear		title
F	V50975	MDF	8/7/95				VERTICAL STACKING 2-ROW HEADER
G	V71450	HTB	10/7/97	0'±2'		scale 2:1	.755/19.18 W/O MOUNTING HOLES
H	M05-0089	ERE	4/20/05	dr	M. FETROW	7/20/95	dwg no
J	M07-0116	AGS	2/19/07	eng	L. FYE	7/20/95	sheet 1 of 4 size
K	M08-0279	MHT	9/30/08	chr	T. BREWBAKER	7/20/95	A3
				appd	L. FYE	7/20/95	type
sheet	revision	K	K	K	K		Product Customer Drawing
index	sheet	1	2	3	4		

POSITION TABLE	
PRODUCT NO	SIZE
XXXXX-001	2X5
-002	2X6
-003	2X7
-004	2X8
-005	2X9
-006	2X10
-007	2X11
-008	2X12
-009	2X13
-010	2X14
-011	2X15
-012	2X16
-013	2X17
-014	2X18
-015	2X19
-016	2X20
-017	2X21
-018	2X22
-019	2X23
-020	2X24
-021	2X25
-022	2X26
-023	2X27
-024	2X28
-025	2X29
-026	2X30
-027	2X31
-028	2X32
-029	2X33
-030	2X34
-031	2X35
XXXXX-032	2X36

PART NUMBER INFORMATION

XXXXX-XXX LF

LEAD FREE OPTION

SEE POSITION TABLE
FOR SIZES NOTE 1

BASE PART NO.

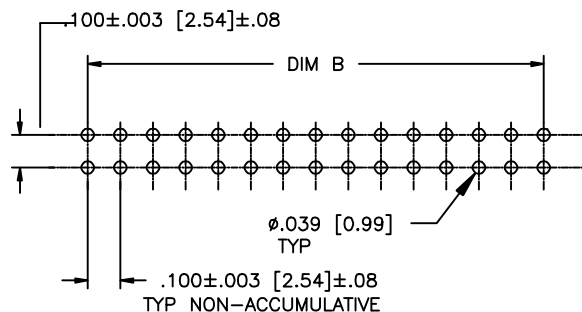

NOTES

- SEE POSITION TABLE FOR PRODUCT NO AND SIZE TABULATION. HOUSING DASH NO IS SAME AS HEADER DASH NO.
- DIM B =
(NO OF COLUMNS - 1) TIMES .100 (ENGLISH)
(NO OF COLUMNS - 1) TIMES 2.54 (METRIC)
- MOLDING MATERIAL: 20% MIN GLASS FILLED NYLON PER UL 94V-0. COLOR: BLACK, OXYGEN INDEX 36.
OR
MINERAL FILLED LCP FLAME RETARDENT PER UL-94V-0. COLOR: BLACK.
- TERMINAL MATERIAL: 3/4 HARD PHOS BRONZE ALLOY UNS C51000.
- PIN RETENTION TO BE 3 LBS./1.4 KGS MINIMUM PER PIN IN EITHER DIRECTION.
- COMPANY LOGO TO BE MOLDED IN APPROX LOCATION SHOWN.
- ADD "LF" SUFFIX AT THE END OF PART NUMBER FOR LEAD FREE OPTION.
- THE HOUSING WILL WITHSTAND EXPOSURE TO 260° FOR 15 SECONDS IN A WAVE SOLDER APPLICATION WITH A 1.5mm MINIMUM THICK CIRCUIT BOARD SEE APPLICATION NOTES/PROCEDURES IF THEY ARE AVAILABLE.
- THESE PRODUCT MEETS EUROPEAN UNION DIRECTIVES AND OTHER COUNTRY REGULATION AS DESCRIBED IN GS-22-008.
- PLATING OPTIONS:
MAY BE EITHER GOLD OR GXT PLATED AT MANUFACTURER'S OPTION.

RECOMMENDED PC BOARD LAYOUT
SCALE 2/1

mat'l. code NOTE 3 & 4		surface ISO 1902	tolerance ISO 406 ISO 1101	projection ISO 1001	product family HEADERS
ltr	ecn no	dr	date	tolerances unless otherwise specified	title
K				angles linear XX±.01/XX±.03 XXX±.005/XXX±.013 XXX±.0020/XXX±.0051	VERTICAL STACKING 2-ROW HEADER .755/19.18 W/O MOUNTING HOLES
				0'±2'	scale 2:1
dr	M. FETROW	7/20/95			dwg no
engr	L. FYE	7/20/95			sheet 2 of 4
chr	T. BREWBAKER	7/20/95			size A3
appd	L. FYE	7/20/95			type Product Customer Drawing
sheet index	revision sheet				

PRODUCT NO NOTE 7	TERMINAL PLATING (NOTE 10)
68210-XXX	15u"/0.38u MIN Au OVER 50u"/1.27u MIN Ni.
68210-033	15u"/0.38u MIN Au OVER 50u"/1.27u MIN Ni.
68210-034	15u"/0.38u MIN Au OVER 50u"/1.27u MIN Ni.
68533-XXX	120u"/3.05u MIN 93/7 SnPb OVER 50u"/1.27u MIN Ni.
68583-XXX	30u"/0.76u MIN GXT OVER 50u"/1.27u MIN Ni.
69205-XXX	15u"/0.38u MIN GXT OVER 50u"/1.27u MIN Ni.
69667-XXX	30u"/0.76u MIN Au OVER 50u"/1.27u MIN Ni.
69963-XXX	DUPLEX { CONTACT: 15u"/0.38u Au OVER 50u"/1.27u Ni. TAIL: 100u"/2.54u MIN Sn OVER 50u"/1.27u Ni.
69967-XXX	DUPLEX { CONTACT: 30u"/0.76u Au OVER 50u"/1.27u Ni. TAIL: 100u"/2.54u MIN Sn OVER 50u"/1.27u Ni.
89445-022	15u"/0.38u MIN Au OVER 50u"/1.27u MIN Ni.
90045-XXX	DUPLEX { CONTACT: 15u"/0.38u Au OVER 50u"/1.27u Ni. TAIL: 100u"/2.54u MIN Sn OVER 50u"/1.27u Ni.

mat'l. code NOTE 3 & 4				surface ISO 1902 <input checked="" type="checkbox"/>		tolerance ISO 406 ISO 1101		projection 		product family HEADERS	
ltr	ecn no	dr	date	tolerances unless otherwise specified							
K				angles	linear	XX±.01/XX±.03 XXX±.005/XXX±.013 XXXX±.0020/XXXX±.0051		INCH/MM 		title VERTICAL STACKING 2-ROW HEADER .755/19.18 W/O MOUNTING HOLES	
				0'±2'				scale 2:1		dwg no 68210	
				dr	M. FETROW	7/20/95				sheet 3 of 4 size A3	
				engr	L. FYE	7/20/95					
				chr	T. BREWBAKER	7/20/95					
				appd	L. FYE	7/20/95				type Product Customer Drawing	
sheet index	revision sheet										

PRODUCT NO NOTE 7	SIZE	DIM "B"	DIM "C"	DIM "L"	TAIL LENGTH DIM "T"	MATING LENGTH DIM "M"	TOTAL PIN LENGTH DIM "P"
68210-XXX	NOTE 1	NOTE 2	DIM "B" +.130/3.30	DIM "B" +.210/5.33	.103/2.62 MIN .130/3.30 MAX	.275±.010 6.98±0.25	.810/20.57
68210-033	2 x 15	1.400/35.56	1.53/38.9	1.61/40.9	.148±.008 3.76±0.20	.275±.010 6.98±0.25	.840/21.34
68210-034	2 x 25	2.400/60.96	2.53/64.3	2.61/66.3	.148±.008 3.76±0.20	.275±.010 6.98±0.25	.840/21.34
68533-XXX	NOTE 1	NOTE 2	DIM "B" +.130/3.30	DIM "B" +.210/5.33	.103/2.62 MIN .130/3.30 MAX	.275±.010 6.98±0.25	.810/20.57
68583-XXX						.275±.010 6.98±0.25	.810/20.57
69205-XXX						.275±.010 6.98±0.25	.810/20.57
69667-XXX						.275±.010 6.98±0.25	.810/20.57
69963-XXX						.275±.010 6.98±0.25	.810/20.57
69967-XXX	NOTE 1	NOTE 2	DIM "B" +.130/3.30	DIM "B" +.210/5.33		.275±.010 6.98±0.25	.810/20.57
89445-022	2 x 26	2.500/63.50	2.63/66.8	2.71/68.8		.400±.010 10.16±0.25	.935/23.75
90045-XXX	NOTE 1	NOTE 2	DIM "B" +.130/3.30	DIM "B" +.210/5.33		.275±.010 6.98±0.25	.810/20.57
69967-XXX	NOTE 1	NOTE 2	DIM "B" +.130/3.30	DIM "B" +.210/5.33		.275±.010 6.98±0.25	.810/20.57
89445-022	2 x 26	2.500/63.50	2.63/66.8	2.71/68.8	.103/2.62 MIN .130/3.30 MAX	.400±.010 10.16±0.25	.935/23.75
90045-XXX	NOTE 1	NOTE 2	DIM "B" +.130/3.30	DIM "B" +.210/5.33	.103/2.62 MIN .130/3.30 MAX	.275±.010 6.98±0.25	.810/20.57

mat'l. code NOTE 3 & 4				surface ISO 1902 <input checked="" type="checkbox"/>		tolerance ISO 406 ISO 1101		projection 		product family HEADERS	
ltr	ecn no	dr	date	tolerances unless otherwise specified							
K				angles	linear	XX±.01/XX±0.3		INCH/MM		title	
						XXX±.005/XXX±0.13				VERTICAL STACKING 2-ROW HEADER	
				0'±2'		XXX±.0020/XXX±0.051		scale 2:1		.755/19.18 W/O MOUNTING HOLES	
dr				M. FETROW	7/20/95					dwg no	sheet 4 of 4 size
engr				L. FYE	7/20/95					68210	A3
chr				T. BREWBAKER	7/20/95						
appd				L. FYE	7/20/95					type Product Customer Drawing	
sheet	revision										
index	sheet										

Mouser Electronics

Authorized Distributor

Click to View Pricing, Inventory, Delivery & Lifecycle Information:

[FCI / Amphenol:](#)

[68583-001](#) [68583-011](#) [68583-014](#) [68583-026](#) [68583-032](#) [68533-012](#)