

ELECTRICAL

FREQUENCY RANGE _____ DC - 18 GHz

ATTENUATION ACCURACY

| | |
|------------|----------|
| 0 - 6 dB | ±0.30 dB |
| 7 - 20 dB | ±0.50 dB |
| 21 - 30 dB | ±0.75 dB |

VSWR

| | |
|---------------|------------|
| DC - 4 GHz | 1.15:1 MAX |
| 4 - 12.4 GHz | 1.25:1 MAX |
| 12.4 - 18 GHz | 1.35:1 MAX |

INPUT POWER _____ 2 WATTS
DERATES LINEARLY FROM 100% @ +25°C TO 10% @ 125°C

PEAK POWER _____ 500 WATTS
(5µSec PULSE WIDTH, 0.1% DUTY CYCLE)

IMPEDANCE _____ 50 OHMS

OPERATING TEMP RANGE _____ 4 KELVIN TO +125°C
150° STORAGE

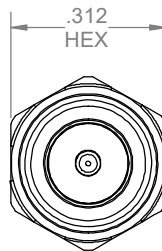

| REVISIONS | | | | |
|-----------|-----------------------|--------|---------|----------|
| REV | DESCRIPTION | ECO # | DATE | APPROVED |
| D | DUTY CYCLE WAS .01% | 16-036 | 2/19/16 | T.KUHN |
| E | CHANGED ASSY # IN BOM | 17-063 | 5/2/17 | T.KUHN |
| F | ADDED RoHS STATEMENT | 17-096 | 6/14/16 | T.KUHN |
| G | MODIFIED BOM | 18-141 | 9/20/18 | T.KUHN |

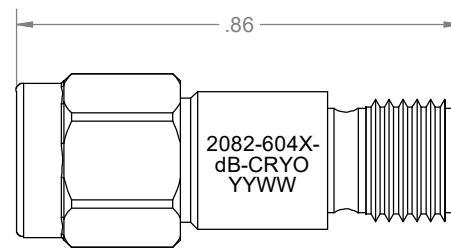

00 THRU 12 dB

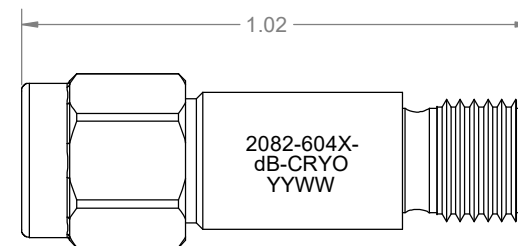

13 THRU 30 dB

MECHANICAL

| | |
|-------------------|---|
| CONNECTOR BODIES | PASSIVATED STAINLESS STEEL |
| CENTER CONDUCTORS | GOLD PLATED BERYLLIUM COPPER |
| INSULATORS | PTFE (TEFLON) IAW ASTM-D1710 |
| RESISTIVE ELEMENT | THIN FILM HYBRID ON 99.6% ALUMINA SUBSTRATE |

RoHS COMPLIANT DEVICE

CONNECTOR INTERFACES IAW MIL-STD-348 & MIL-PRF-39012

MATERIALS, FINISHES AND ENVIROMENTAL CAPABILITIES DESIGNED TO MEET MIL-DTL-3933

MARKING

PART LOOKS LIKE PRODUCT IMAGE ABOVE.
PART MARKING ORIENTATION AND FORMAT AS SHOWN.
CHANGE X TO THE ONE DIGIT VALUE ON WORK ORDER.
REPLACE dB WITH APPROPRIATE TWO DIGIT dB VALUE.
MARKING TO BE AS LARGE AS POSSIBLE, CLEAR, READABLE.
YYWW EQUALS DATE CODE.

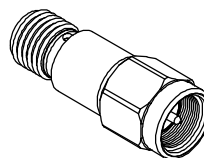

| 0 dB | 1-30 dB | PART NUMBER | DESCRIPTION | ITEM NO. |
|------|---------|------------------------|--|----------|
| X | X | 2082-604X-dB-CRYO | ATTENUATOR, SMA-m/f, DC-18 GHz, 2W, CRYOGENIC | |
| - | 1 | TA-2082-6000-dBAU-CRYO | ASSEMBLY, ATTENUATOR, SMA-m/f, DC-18 GHz, 2W, UNMARKED | |
| 1 | - | TA-2082-6040-00U | ASSEMBLY, ATTENUATOR, SMA-m/f, DC-18 GHz, 2W, UNMARKED, 0 dB | |

| dB VALUES 2082: | 1 dB STEPS, 18GHz 2082: |
|------------------------|----------------------------|
| -00/-03 = 0 THRU 3dB | -6040-00 THRU 03 |
| -04/-06 = 4 THRU 6dB | -6041-04 THRU 06 |
| -07/-10 = 7 THRU 10dB | -6042-07 THRU 10 |
| -11/-12 = 11 AND 12dB | -6043-11 AND 12 |
| -13/-20 = 13 THRU 20dB | -6043-13 THRU 20 |
| -25 & -30dB | 6044-25 & -30 |

DRAWING PRACTICES PER ANSI-Y-14.5 MIL-STD-100 & 1000

DIMENSIONS ARE IN INCHES AND APPLY BEFORE / AFTER PROCESSING

SURFACE ROUGHNESS μ INCHES **63**

FINISH:

SEE NOTES

MATERIAL:

SEE NOTES

NOTE:
THIS DRAWING INCORPORATES THIRD ANGLE PROJECTION.

INTERPRET IAW ANSI Y14.5-1982

UNLESS OTHERWISE SPECIFIED TOLERANCES IN:

| | | |
|----------|-------|--------|
| DECIMALS | INCH | [MM] |
| .X" | .05" | [1.27] |
| .XX" | .03" | [.76] |
| .XXX" | .010" | [.25] |

ANGLES ±0°30'

REMOVE ALL BURRS/SHARP W/ BREAK / R OF .003" TO .0005" UNLESS OTHERWISE NOTED DIAS CONCENTRIC <.003 T.I.R.

DO NOT SCALE PRINT

DRAWN DATE
V.SHELBY 2/20/13

CHECKED DATE
T.KUHN 2/20/13

ENG. APPR. DATE
T.KUHN 2/20/13



Phone: 603-222-2256 Fax: 603-222-2259
150 Dow Street, Manchester, NH 03101

ATTENUATOR, SMA-m/f, DC-18GHz, 2W, CRYOGENIC

| SIZE | CAGE CODE | DRAWING NUMBER | REV |
|------|-----------|-------------------|-----|
| B | 3HT76 | 2082-604X-dB-CRYO | G |

SCALE PLATED AREA SQ. IN SHEET 1 OF 1

Mouser Electronics

Authorized Distributor

Click to View Pricing, Inventory, Delivery & Lifecycle Information:

[Amphenol:](#)

[2082-6040-00-CRYO](#) [2082-6042-20](#) [2082-6040-03](#) [2082-6043-20-CRYO](#) [2082-6041-06-CRYO](#) [2082-6042-10-](#)
[CRYO](#) [2082-6040-03-CRYO](#) [2082-6041-06](#) [2082-6044-30-CRYO](#) [2082-6042-10](#)