

REV.	ECN NO.	DATE	SIGN	DESCRIPTION
B	LEN1390257	2013/09/05	Lu Di	Change LOGO

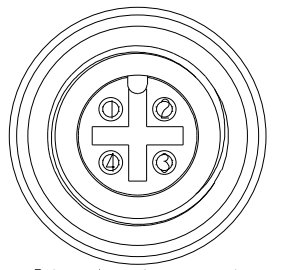
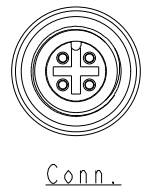
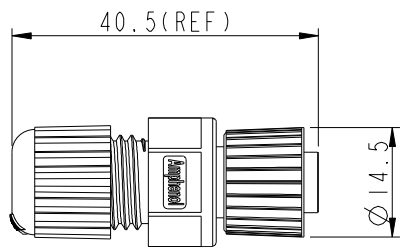
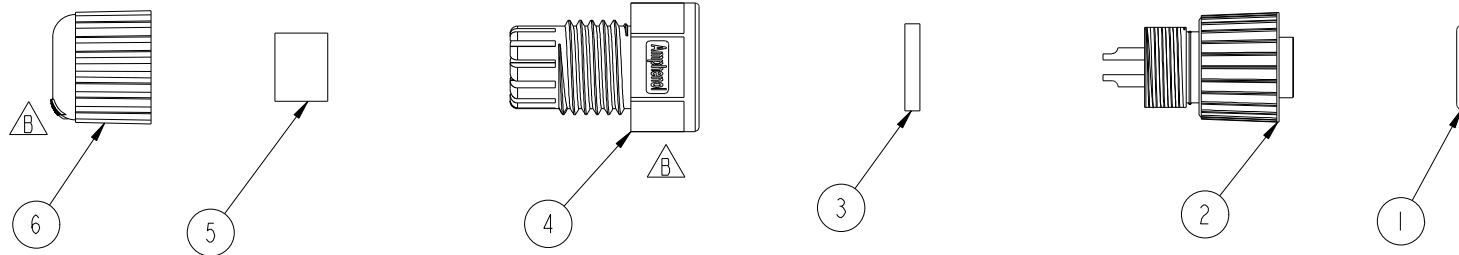
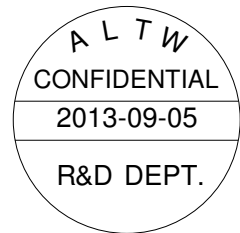
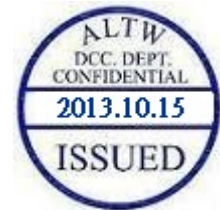

Pin Assignments
Front View

Note:

- * (C) Important Dimension To Check.
- * Waterproof Rate: IP68
- * Housing: Black, Nylon+GF
- * Pin: Copper Alloy, Gold Plated
- * Nut: Zinc Alloy, Nickel Plated
- * Ring: Green, Viton
- * Gasket: Black, EPDM
- * Clamp Ring: Black, Nylon
- * Sealing Nut: Black, Nylon
- * Seal: Black, EPDM
- * Seal For Cable OD: $\varnothing 4.5\text{mm} \sim \varnothing 6.5\text{mm}$

UNIT: mm

TOLERANCE	
.X	± 0.25
.XX	± 0.1
.XXX	± 0.05
ANGLES	$\pm 1^\circ$

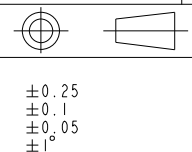

TITLE M12 Conn, Assy Screw 4Pin F Conn. F Pin			
SCALE	SIZE	SHEET	OF
1:1	A4	1	1
REV.	WC-REV.	QC: Inspection item	
B	B.2		

Amphenol LTW
安費諾亮泰企業股份有限公司

ITEM NO.	12-04BFFA-SL8001
DWG NO.	12-04BFFA-SL8001
CUSTOMER	ALTW

DRAWN BY	Di_lu
CHECKED BY	Mafei
APPROVED BY	Victor

DATE	2013/09/05
DATE	2013/09/05
DATE	2013/09/05

THIS DOCUMENT IS SUBJECT TO CHANGE WITHOUT NOTICE. IT IS CONFIDENTIAL AND A PROPERTY OF Amphenol LTW. DISCLOSURE TO THIRD PARTY HAS TO BE AUTHORIZED BY Amphenol LTW.

Mouser Electronics

Authorized Distributor

Click to View Pricing, Inventory, Delivery & Lifecycle Information:

[Amphenol:](#)

[12-04BFFA-SL8001](#)