

PRODUCT DATA DRAWING

REVISION HISTORY			
REV	DESCRIPTION	DATE	APPROVED
-	REL. NRN 35512	09/17/09	STW
A	DCN 39509	11/12	STW

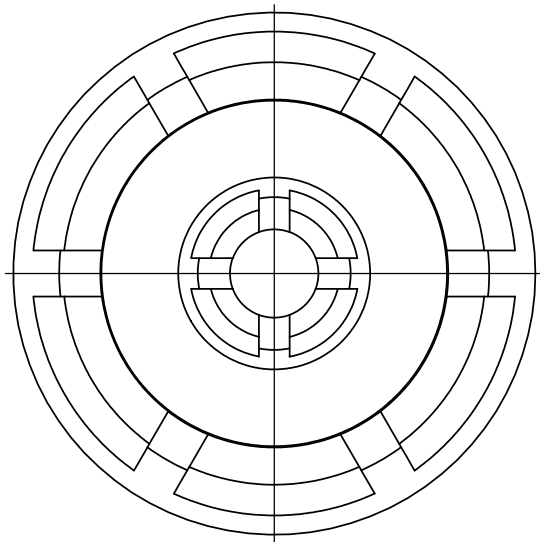

2X SMPS INTERFACE
ACCEPTS $\phi .009 \pm .001 [0.23 \pm 0.03]$
MALE PIN

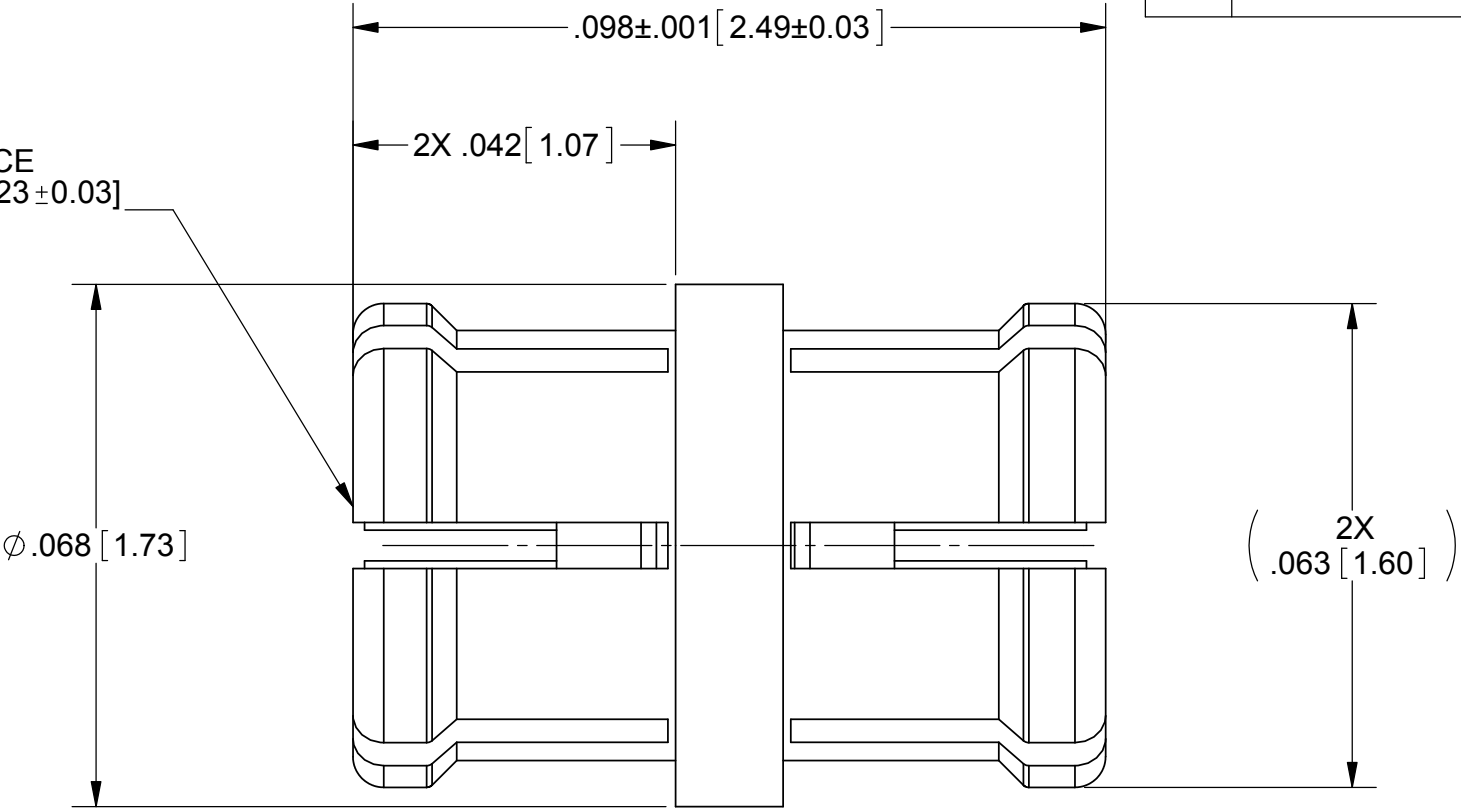

MATERIAL: BODY, & CONTACT:	BERYLLIUM COPPER PER ASTM B196, ALLOY No. UNS C17300, TD04
INSULATOR:	PTFE PER ASTM D1710, TYPE I, GRADE 1, CLASS B
FINISH: BODY & CONTACT:	GOLD PER ASTM B 488, TYPE II, CODE C, CLASS 1.27, OVER NICKEL PER AMS-QQ-N-290, CLASS 1, .00005" MIN.
PERFORMANCE: IMPEDANCE: VSWR:	50 OHMS 1.15:1 DC TO 40 GHz TYPICAL 1.25:1 TO 65 GHz TYPICAL
INSERTION LOSS: DWV:	.12 X SQRT(F(F IN GHz)) 250 VRMS
OPERATING TEMP.:	-55°C TO +165°C
ENGAGEMENT:	3.5 LBS TYPICAL IN FULL DETENT 1.6 LBS TYPICAL IN SMOOTH BORE
DISENGAGEMENT:	2.0 LBS TYPICAL IN FULL DETENT 0.5 LBS TYPICAL IN SMOOTH BORE

MATERIAL:	SEE NOTES	DIMENSIONS ARE IN INCHES TOLERANCES: FRACTIONAL: ±1/64 ANGULAR: X° ±1'0"
-----------	-----------	---

Mouser Electronics

Authorized Distributor

Click to View Pricing, Inventory, Delivery & Lifecycle Information:

[Amphenol:](#)

[1138-4001](#)