

PCB Layout

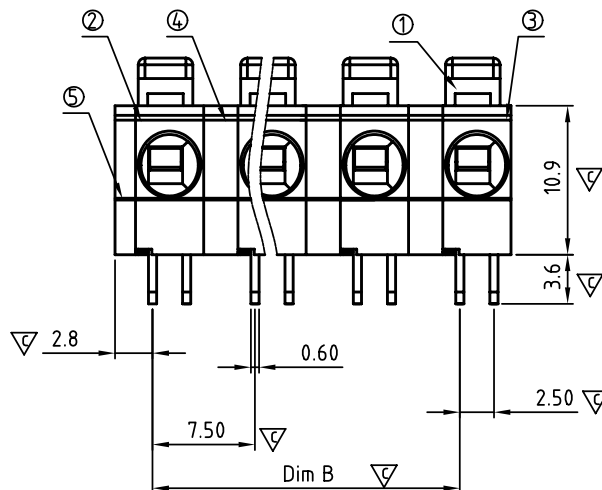

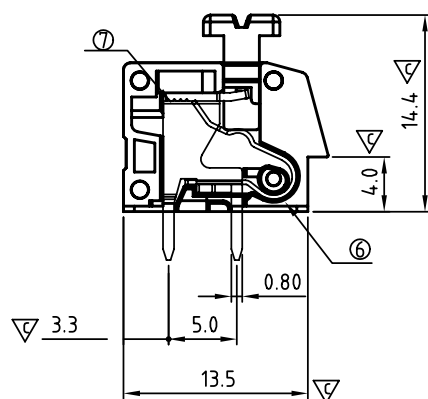
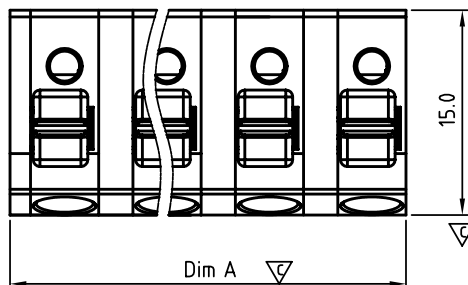

N=NUMBER OF POLES

DIM		TOL			
		2P--4P	5P--8P	9P--12P	13P--16P
Dim A	(N-1)×7.5+6.50	±0.15	±0.20	±0.30	±0.40
Dim B	(N-1)×7.5	±0.15	±0.20	±0.25	±0.30

SIGN	DATE	DESCRIPTION	APPROVER
△	08/24'12	Change the dwg no 8H60103 to 8H60701	Da cheng
THIS IS CAD DRAWING, DO NOT REVISE MANUALLY Y!!!			

- Material:
- Item ① Lever: Thermoplastic (UL94V-0)
  - Item ② Terminal body: Thermoplastic (UL94V-0)
  - Item ③ Terminal side body: Thermoplastic (UL94V-0)
  - Item ④ Pad board: Thermoplastic (UL94V-0)
  - Item ⑤ cover: Thermoplastic (UL94V-0)
  - Item ⑥ Spring clamp: Stainless steel
  - Item ⑦ contact pin: Brass.Tin plated

Electrical:	cULus	VDE
● Voltage rating:	300 V	450 V
● Current rating:	11 A	12 A
● Wire range:	0.5-4mm <sup>2</sup>	
● Solid wire(AWG):	12-20	
● Stranded wire(AWG):	12-20	
● Wire strip length:	10-11 mm	
● Withstanding Voltage:	1.6KV 2.5KV	
● Operating temperature:	-40°C to +115°C	
● Soldering temperature:	260°C ±5°C/5 Sec	
● Safety Approval:	 	
● Critical dimension:	▽	

H6 xx 1 0 x 0 xxxx G

No. OF POLES  
02: 2 POLES  
:  
16: 16 POLES

COLOR  
0: BLACK  
5: GREEN (RAL 6018/T)  
6: BLUE  
8: GREY (RAL 7004/P)

RoHS compliant  
(lead<4%)  
In copper Alloy

0000: "@ Logo (Standard)  
000A: "ANYTEK" Mark  
Any special item by  
customer request.  
please contact sales  
department.

**ANYTEK**

**CUSTOMER COPY**

ALL RIGHTS RESERVED. REPRODUCTION OR ISSUE TO THIRD PARTIES IN ANY FORM WHATEVER IS NOT PERMITTED WITHOUT WRITTEN AUTHORITY FROM THE PROPRIETOR. PROPERTY OF ANYTEK TECHNOLOGY CO., LTD

TITLE	H6 7.5mm Series ( Round hole )				
PART NO.	H6xx10x0xxxxG		DWG NO.	8H60701 △	
APPROVED	CHECKED	DESIGNED	DRAWN	CUST NO.	Tolerance
		Da cheng 2012.08.24	Da cheng 2012.08.24		X. ±0.50 X.X ±0.30 X.XX ±0.10 X* ±1°
				SHEET: 01/01	UNIT: mm SCALE: NONE REV.: B

# Mouser Electronics

Authorized Distributor

Click to View Pricing, Inventory, Delivery & Lifecycle Information:

## Amphenol:

[H60210800000G](#) [H60310800000G](#) [H60410800000G](#) [H60510800000G](#) [H60610800000G](#) [H60710800000G](#)  
[H60810800000G](#) [H60910800000G](#) [H61010800000G](#) [H61110800000G](#) [H61210800000G](#) [H61310800000G](#)  
[H61410800000G](#) [H61510800000G](#) [H61610800000G](#)