

C-FILTER D-SUB STANDARD

Solder cup – Precision machined contacts – For wire size AWG 26



RoHS compliant – CSA listed, File No.: LR 115000-1 – UL listed, File No.: E202784

SOCKET CONNECTOR

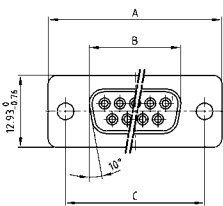

No. of pos.	A -0.76	B -0.25	C
09	31.19	16.46	25.00 <sup>+0.12</sup> <sub>-0.13</sub>
15	39.52	24.79	33.30 <sup>+0.15</sup> <sub>-0.10</sub>
25	53.42	38.50	47.04 <sup>+0.13</sup> <sub>-0.13</sub>
37	69.70	54.96	63.50 <sup>+0.13</sup> <sub>-0.13</sub>
50	67.31	52.55	61.10 <sup>+0.14</sup> <sub>-0.11</sub>

Mounting style: Through-hole

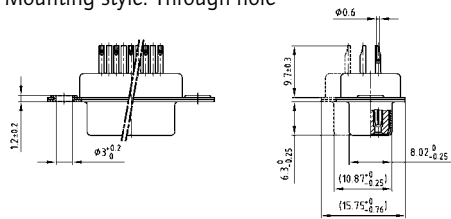

Mounting style: Threaded insert

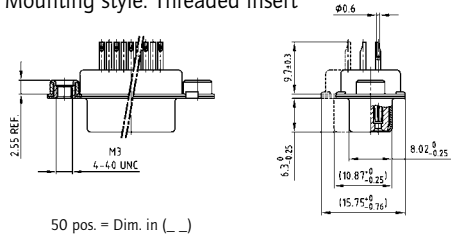

50 pos. = Dim. in ( \_ )

DESCRIPTION

- Suitable for wire size **AWG 26**
- Mounting styles:
  - with through-hole, Ø .118"/3 mm
  - with 4-40 UNC or M3 threaded insert
- Quality class 3 (also available in quality class 1)
- Shell: Steel tin plated (brass tin plated on request)

PLUG CONNECTOR

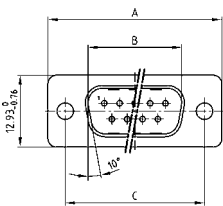

No. of pos.	A -0.76	B +0.25	C	D -0.3
09	31.19	16.79	25.00 <sup>+0.12</sup> <sub>-0.13</sub>	6.12
15	39.52	25.12	33.30 <sup>+0.15</sup> <sub>-0.10</sub>	6.12
25	53.42	38.84	47.04 <sup>+0.13</sup> <sub>-0.13</sub>	5.99
37	69.70	55.30	63.50 <sup>+0.13</sup> <sub>-0.13</sub>	5.99
50	67.31	52.68	61.10 <sup>+0.14</sup> <sub>-0.11</sub>	5.99

Mounting style: Through-hole

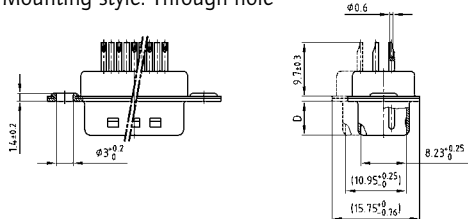

Mounting style: Threaded insert

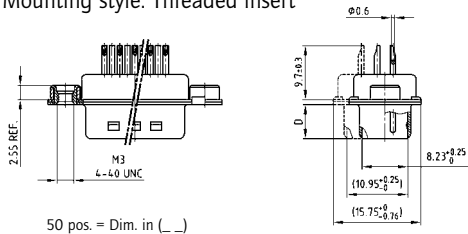

50 pos. = Dim. in ( \_ )

ORDER DATA

Capacitance 180 pF

SOCKET CONNECTOR

No. of pos.	Mounting style	Part Number
09	Through-hole	242 A 15910 X
15	Through-hole	242 A 15920 X
25	Through-hole	242 A 15930 X
37	Through-hole	242 A 15940 X
50	Through-hole	242 A 15950 X
09	4-40 UNC Threaded insert	242 A 15960 X
15	4-40 UNC Threaded insert	242 A 15970 X
25	4-40 UNC Threaded insert	242 A 15980 X
37	4-40 UNC Threaded insert	242 A 15990 X
50	4-40 UNC Threaded insert	242 A 16000 X
09	M3 Threaded insert	242 A 16010 X
15	M3 Threaded insert	242 A 16020 X
25	M3 Threaded insert	242 A 16030 X
37	M3 Threaded insert	242 A 16040 X
50	M3 Threaded insert	242 A 16050 X

PLUG CONNECTOR

No. of pos.	Mounting style	Part Number
09	Through-hole	241 A 18530 X
15	Through-hole	241 A 18540 X
25	Through-hole	241 A 18550 X
37	Through-hole	241 A 18560 X
50	Through-hole	241 A 18570 X
09	4-40 UNC Threaded insert	241 A 18580 X
15	4-40 UNC Threaded insert	241 A 18590 X
25	4-40 UNC Threaded insert	241 A 18600 X
37	4-40 UNC Threaded insert	241 A 18610 X
50	4-40 UNC Threaded insert	241 A 18620 X
09	M3 Threaded insert	241 A 18630 X
15	M3 Threaded insert	241 A 18640 X
25	M3 Threaded insert	241 A 18650 X
37	M3 Threaded insert	241 A 18660 X
50	M3 Threaded insert	241 A 18670 X

# C-FILTER D-SUB STANDARD

Solder cup – Precision machined contacts – For wire size AWG 26

## ORDER DATA

### Capacitance 370 pF

SOCKET CONNECTOR			PLUG CONNECTOR		
No. of pos.	Mounting style	Part Number	No. of pos.	Mounting style	Part Number
09	Through-hole	242 A 11610 X	09	Through-hole	241 A 11600 X
15	Through-hole	242 A 11620 X	15	Through-hole	241 A 11610 X
25	Through-hole	242 A 11630 X	25	Through-hole	241 A 11620 X
37	Through-hole	242 A 11640 X	37	Through-hole	241 A 11630 X
50	Through-hole	242 A 15820 X	50	Through-hole	241 A 15930 X
09	4-40 UNC Threaded insert	242 A 11730 X	09	4-40 UNC Threaded insert	241 A 11720 X
15	4-40 UNC Threaded insert	242 A 11740 X	15	4-40 UNC Threaded insert	241 A 11730 X
25	4-40 UNC Threaded insert	242 A 11750 X	25	4-40 UNC Threaded insert	241 A 11740 X
37	4-40 UNC Threaded insert	242 A 11760 X	37	4-40 UNC Threaded insert	241 A 11750 X
50	4-40 UNC Threaded insert	242 A 15850 X	50	4-40 UNC Threaded insert	241 A 15960 X
09	M3 Threaded insert	242 A 11850 X	09	M3 Threaded insert	241 A 11840 X
15	M3 Threaded insert	242 A 11860 X	15	M3 Threaded insert	241 A 11850 X
25	M3 Threaded insert	242 A 11870 X	25	M3 Threaded insert	241 A 11860 X
37	M3 Threaded insert	242 A 11880 X	37	M3 Threaded insert	241 A 11870 X
50	M3 Threaded insert	242 A 15880 X	50	M3 Threaded insert	241 A 15990 X

### Capacitance 830 pF

SOCKET CONNECTOR			PLUG CONNECTOR		
No. of pos.	Mounting style	Part Number	No. of pos.	Mounting style	Part Number
09	Through-hole	242 A 11690 X	09	Through-hole	241 A 11680 X
15	Through-hole	242 A 11700 X	15	Through-hole	241 A 11690 X
25	Through-hole	242 A 11710 X	25	Through-hole	241 A 11700 X
37	Through-hole	242 A 11720 X	37	Through-hole	241 A 11710 X
50	Through-hole	242 A 15840 X	50	Through-hole	241 A 15950 X
09	4-40 UNC Threaded insert	242 A 11810 X	09	4-40 UNC Threaded insert	241 A 11800 X
15	4-40 UNC Threaded insert	242 A 11820 X	15	4-40 UNC Threaded insert	241 A 11810 X
25	4-40 UNC Threaded insert	242 A 11830 X	25	4-40 UNC Threaded insert	241 A 11820 X
37	4-40 UNC Threaded insert	242 A 11840 X	37	4-40 UNC Threaded insert	241 A 11830 X
50	4-40 UNC Threaded insert	242 A 15870 X	50	4-40 UNC Threaded insert	241 A 15980 X
09	M3 Threaded insert	242 A 11930 X	09	M3 Threaded insert	241 A 11920 X
15	M3 Threaded insert	242 A 11940 X	15	M3 Threaded insert	241 A 11930 X
25	M3 Threaded insert	242 A 11950 X	25	M3 Threaded insert	241 A 11940 X
37	M3 Threaded insert	242 A 11960 X	37	M3 Threaded insert	241 A 11950 X
50	M3 Threaded insert	242 A 15900 X	50	M3 Threaded insert	241 A 16010 X

### Capacitance 1300 pF

SOCKET CONNECTOR			PLUG CONNECTOR		
No. of pos.	Mounting style	Part Number	No. of pos.	Mounting style	Part Number
09	Through-hole	242 A 11650 X	09	Through-hole	241 A 11640 X
15	Through-hole	242 A 11660 X	15	Through-hole	241 A 11650 X
25	Through-hole	242 A 11670 X	25	Through-hole	241 A 11660 X
37	Through-hole	242 A 11680 X	37	Through-hole	241 A 11670 X
50	Through-hole	242 A 15830 X	50	Through-hole	241 A 15940 X
09	4-40 UNC Threaded insert	242 A 11770 X	09	4-40 UNC Threaded insert	241 A 11760 X
15	4-40 UNC Threaded insert	242 A 11780 X	15	4-40 UNC Threaded insert	241 A 11770 X
25	4-40 UNC Threaded insert	242 A 11790 X	25	4-40 UNC Threaded insert	241 A 11780 X
37	4-40 UNC Threaded insert	242 A 11800 X	37	4-40 UNC Threaded insert	241 A 11790 X
50	4-40 UNC Threaded insert	242 A 15860 X	50	4-40 UNC Threaded insert	241 A 15970 X
09	M3 Threaded insert	242 A 11890 X	09	M3 Threaded insert	241 A 11880 X
15	M3 Threaded insert	242 A 11900 X	15	M3 Threaded insert	241 A 11890 X
25	M3 Threaded insert	242 A 11910 X	25	M3 Threaded insert	241 A 11900 X
37	M3 Threaded insert	242 A 11920 X	37	M3 Threaded insert	241 A 11910 X
50	M3 Threaded insert	242 A 15890 X	50	M3 Threaded insert	241 A 16000 X

# Mouser Electronics

Authorized Distributor

Click to View Pricing, Inventory, Delivery & Lifecycle Information:

## Amphenol:

<a href="#"><u>241A11870X</u></a>	<a href="#"><u>241A11700X</u></a>	<a href="#"><u>241A11730X</u></a>	<a href="#"><u>241A11610X</u></a>	<a href="#"><u>242A15890X</u></a>	<a href="#"><u>242A15970X</u></a>	<a href="#"><u>242A15910X</u></a>	<a href="#"><u>242A15990X</u></a>
<a href="#"><u>242A15850X</u></a>	<a href="#"><u>242A16030X</u></a>	<a href="#"><u>242A15930X</u></a>	<a href="#"><u>242A15940X</u></a>	<a href="#"><u>242A16020X</u></a>	<a href="#"><u>242A15820X</u></a>	<a href="#"><u>242A15980X</u></a>	<a href="#"><u>242A15900X</u></a>
<a href="#"><u>242A15920X</u></a>	<a href="#"><u>242A15950X</u></a>	<a href="#"><u>242A15960X</u></a>	<a href="#"><u>242A16040X</u></a>	<a href="#"><u>242A11650X</u></a>	<a href="#"><u>242A11890X</u></a>	<a href="#"><u>242A11730X</u></a>	<a href="#"><u>242A11800X</u></a>
<a href="#"><u>242A11900X</u></a>	<a href="#"><u>242A15860X</u></a>	<a href="#"><u>242A11820X</u></a>	<a href="#"><u>242A11910X</u></a>	<a href="#"><u>242A15870X</u></a>	<a href="#"><u>242A16050X</u></a>	<a href="#"><u>242A11930X</u></a>	<a href="#"><u>242A15880X</u></a>
<a href="#"><u>242A11660X</u></a>	<a href="#"><u>242A11690X</u></a>	<a href="#"><u>242A11700X</u></a>	<a href="#"><u>242A11780X</u></a>	<a href="#"><u>242A11860X</u></a>	<a href="#"><u>242A11710X</u></a>	<a href="#"><u>242A11790X</u></a>	<a href="#"><u>242A11950X</u></a>
<a href="#"><u>242A11960X</u></a>	<a href="#"><u>242A11630X</u></a>	<a href="#"><u>242A11760X</u></a>	<a href="#"><u>242A11610X</u></a>	<a href="#"><u>242A11620X</u></a>	<a href="#"><u>242A11870X</u></a>	<a href="#"><u>242A11670X</u></a>	<a href="#"><u>242A11740X</u></a>
<a href="#"><u>242A11920X</u></a>	<a href="#"><u>242A15830X</u></a>	<a href="#"><u>242A16000X</u></a>	<a href="#"><u>242A11680X</u></a>	<a href="#"><u>242A11840X</u></a>	<a href="#"><u>242A11850X</u></a>	<a href="#"><u>242A11940X</u></a>	<a href="#"><u>241A18660X</u></a>
<a href="#"><u>241A18530X</u></a>	<a href="#"><u>241A18610X</u></a>	<a href="#"><u>241A11880X</u></a>	<a href="#"><u>241A18650X</u></a>	<a href="#"><u>241A18590X</u></a>	<a href="#"><u>241A18620X</u></a>	<a href="#"><u>241A15930X</u></a>	<a href="#"><u>241A16000X</u></a>
<a href="#"><u>241A16010X</u></a>	<a href="#"><u>241A18540X</u></a>	<a href="#"><u>241A18550X</u></a>	<a href="#"><u>241A18640X</u></a>	<a href="#"><u>241A18600X</u></a>	<a href="#"><u>241A18670X</u></a>	<a href="#"><u>241A15960X</u></a>	<a href="#"><u>241A15970X</u></a>
<a href="#"><u>241A18570X</u></a>	<a href="#"><u>241A18580X</u></a>	<a href="#"><u>241A11810X</u></a>	<a href="#"><u>241A11900X</u></a>	<a href="#"><u>241A11660X</u></a>	<a href="#"><u>241A11740X</u></a>	<a href="#"><u>241A11830X</u></a>	<a href="#"><u>241A11600X</u></a>
<a href="#"><u>241A11680X</u></a>	<a href="#"><u>241A11690X</u></a>	<a href="#"><u>241A11930X</u></a>	<a href="#"><u>241A15940X</u></a>	<a href="#"><u>241A15950X</u></a>	<a href="#"><u>241A11940X</u></a>	<a href="#"><u>241A11820X</u></a>	<a href="#"><u>241A11920X</u></a>
<a href="#"><u>241A11720X</u></a>	<a href="#"><u>241A11890X</u></a>	<a href="#"><u>241A11670X</u></a>	<a href="#"><u>241A11750X</u></a>	<a href="#"><u>241A11840X</u></a>	<a href="#"><u>241A11910X</u></a>	<a href="#"><u>241A11770X</u></a>	<a href="#"><u>241A11850X</u></a>
<a href="#"><u>241A11860X</u></a>	<a href="#"><u>241A11650X</u></a>	<a href="#"><u>241A15990X</u></a>	<a href="#"><u>241A11620X</u></a>				