

C-FILTER D-SUB STANDARD

Solder pin – Straight – Precision machined contacts

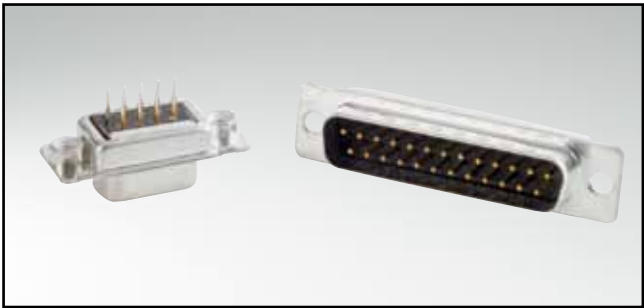

RoHS compliant – CSA listed, File No.: LR 115000-1 – UL listed, File No.: E202784

SOCKET CONNECTOR

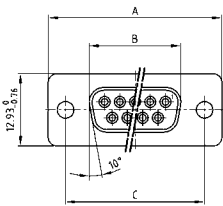

No. of pos.	A -0.76	B -0.25	C
09	31.19	16.46	25.00 ^{+0.12} _{-0.13}
15	39.52	24.79	33.30 ^{+0.15} _{-0.10}
25	53.42	38.50	47.04 ^{+0.13} _{-0.13}
37	69.70	54.96	63.50 ^{+0.13} _{-0.13}
50	67.31	52.55	61.10 ^{+0.14} _{-0.11}

PCB layout: Kat1kFUA

Mounting style: Through-hole

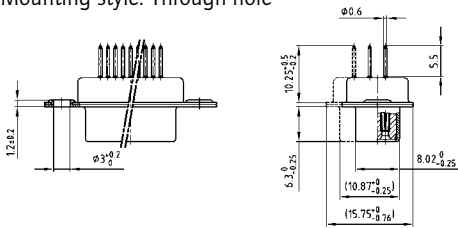

Mounting style: Threaded insert

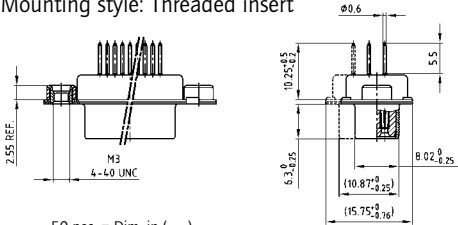

50 pos. = Dim. in (_)

DESCRIPTION

- Mounting styles:
 - with through-hole, Ø .118"/3 mm
 - with 4-40 UNC or M3 threaded insert
- Quality class 3 (also available in quality class 1)
- Shell: Steel tin plated (brass tin plated on request)

PLUG CONNECTOR

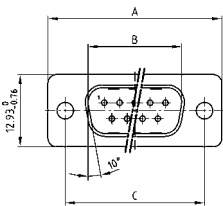

No. of pos.	A -0.76	B +0.25	C	D -0.3
09	31.19	16.79	25.00 ^{+0.12} _{-0.13}	6.12
15	39.52	25.12	33.30 ^{+0.15} _{-0.10}	6.12
25	53.42	38.84	47.04 ^{+0.13} _{-0.13}	5.99
37	69.70	55.30	63.50 ^{+0.13} _{-0.13}	5.99
50	67.31	52.68	61.10 ^{+0.14} _{-0.11}	5.99

PCB layout: Kat1kFUA

Mounting style: Through-hole

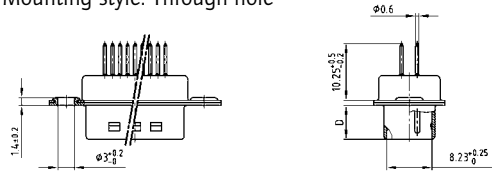

Mounting style: Threaded insert

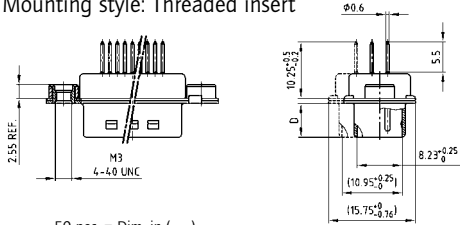

50 pos. = Dim. in (_)

ORDER DATA

Capacitance 180 pF

SOCKET CONNECTOR			PLUG CONNECTOR		
No. of pos.	Mounting style	Part Number	No. of pos.	Mounting style	Part Number
09	Through-hole	242 A 16060 X	09	Through-hole	241 A 18680 X
15	Through-hole	242 A 16070 X	15	Through-hole	241 A 18690 X
25	Through-hole	242 A 16080 X	25	Through-hole	241 A 18700 X
37	Through-hole	242 A 16090 X	37	Through-hole	241 A 18710 X
50	Through-hole	242 A 16100 X	50	Through-hole	241 A 18720 X
09	4-40 UNC Threaded insert	242 A 16110 X	09	4-40 UNC Threaded insert	241 A 18730 X
15	4-40 UNC Threaded insert	242 A 16120 X	15	4-40 UNC Threaded insert	241 A 18740 X
25	4-40 UNC Threaded insert	242 A 16130 X	25	4-40 UNC Threaded insert	241 A 18750 X
37	4-40 UNC Threaded insert	242 A 16140 X	37	4-40 UNC Threaded insert	241 A 18760 X
50	4-40 UNC Threaded insert	242 A 16150 X	50	4-40 UNC Threaded insert	241 A 18770 X
09	M3 Threaded insert	242 A 16160 X	09	M3 Threaded insert	241 A 18780 X
15	M3 Threaded insert	242 A 16170 X	15	M3 Threaded insert	241 A 18790 X
25	M3 Threaded insert	242 A 16180 X	25	M3 Threaded insert	241 A 18800 X
37	M3 Threaded insert	242 A 16190 X	37	M3 Threaded insert	241 A 18810 X
50	M3 Threaded insert	242 A 16200 X	50	M3 Threaded insert	241 A 18820 X

C-FILTER D-SUB STANDARD

Solder pin – Straight – Precision machined contacts

ORDER DATA

Capacitance 370 pF

SOCKET CONNECTOR			PLUG CONNECTOR		
No. of pos.	Mounting style	Part Number	No. of pos.	Mounting style	Part Number
09	Through-hole	242 A 10010 X	09	Through-hole	241 A 10010 X
15	Through-hole	242 A 10020 X	15	Through-hole	241 A 10020 X
25	Through-hole	242 A 10030 X	25	Through-hole	241 A 10030 X
37	Through-hole	242 A 10040 X	37	Through-hole	241 A 10040 X
50	Through-hole	242 A 15580 X	50	Through-hole	241 A 15690 X
09	4-40 UNC Threaded insert	242 A 10130 X	09	4-40 UNC Threaded insert	241 A 10130 X
15	4-40 UNC Threaded insert	242 A 10140 X	15	4-40 UNC Threaded insert	241 A 10140 X
25	4-40 UNC Threaded insert	242 A 10150 X	25	4-40 UNC Threaded insert	241 A 10150 X
37	4-40 UNC Threaded insert	242 A 10160 X	37	4-40 UNC Threaded insert	241 A 10160 X
50	4-40 UNC Threaded insert	242 A 15610 X	50	4-40 UNC Threaded insert	241 A 15720 X
09	M3 Threaded insert	242 A 10250 X	09	M3 Threaded insert	241 A 10250 X
15	M3 Threaded insert	242 A 10260 X	15	M3 Threaded insert	241 A 10260 X
25	M3 Threaded insert	242 A 10270 X	25	M3 Threaded insert	241 A 10270 X
37	M3 Threaded insert	242 A 10280 X	37	M3 Threaded insert	241 A 10280 X
50	M3 Threaded insert	242 A 15640 X	50	M3 Threaded insert	241 A 15750 X

Capacitance 830 pF

SOCKET CONNECTOR			PLUG CONNECTOR		
No. of pos.	Mounting style	Part Number	No. of pos.	Mounting style	Part Number
09	Through-hole	242 A 10090 X	09	Through-hole	241 A 10090 X
15	Through-hole	242 A 10100 X	15	Through-hole	241 A 10100 X
25	Through-hole	242 A 10110 X	25	Through-hole	241 A 10110 X
37	Through-hole	242 A 10120 X	37	Through-hole	241 A 10120 X
50	Through-hole	242 A 15600 X	50	Through-hole	241 A 15710 X
09	4-40 UNC Threaded insert	242 A 10210 X	09	4-40 UNC Threaded insert	241 A 10210 X
15	4-40 UNC Threaded insert	242 A 10220 X	15	4-40 UNC Threaded insert	241 A 10220 X
25	4-40 UNC Threaded insert	242 A 10230 X	25	4-40 UNC Threaded insert	241 A 10230 X
37	4-40 UNC Threaded insert	242 A 10240 X	37	4-40 UNC Threaded insert	241 A 10240 X
50	4-40 UNC Threaded insert	242 A 15630 X	50	4-40 UNC Threaded insert	241 A 15740 X
09	M3 Threaded insert	242 A 10330 X	09	M3 Threaded insert	241 A 10330 X
15	M3 Threaded insert	242 A 10340 X	15	M3 Threaded insert	241 A 10340 X
25	M3 Threaded insert	242 A 10350 X	25	M3 Threaded insert	241 A 10350 X
37	M3 Threaded insert	242 A 10360 X	37	M3 Threaded insert	241 A 10360 X
50	M3 Threaded insert	242 A 15660 X	50	M3 Threaded insert	241 A 15770 X

Capacitance 1300 pF

SOCKET CONNECTOR			PLUG CONNECTOR		
No. of pos.	Mounting style	Part Number	No. of pos.	Mounting style	Part Number
09	Through-hole	242 A 10050 X	09	Through-hole	241 A 10050 X
15	Through-hole	242 A 10060 X	15	Through-hole	241 A 10060 X
25	Through-hole	242 A 10070 X	25	Through-hole	241 A 10070 X
37	Through-hole	242 A 10080 X	37	Through-hole	241 A 10080 X
50	Through-hole	242 A 15590 X	50	Through-hole	241 A 15700 X
09	4-40 UNC Threaded insert	242 A 10170 X	09	4-40 UNC Threaded insert	241 A 10170 X
15	4-40 UNC Threaded insert	242 A 10180 X	15	4-40 UNC Threaded insert	241 A 10180 X
25	4-40 UNC Threaded insert	242 A 10190 X	25	4-40 UNC Threaded insert	241 A 10190 X
37	4-40 UNC Threaded insert	242 A 10200 X	37	4-40 UNC Threaded insert	241 A 10200 X
50	4-40 UNC Threaded insert	242 A 15620 X	50	4-40 UNC Threaded insert	241 A 15730 X
09	M3 Threaded insert	242 A 10290 X	09	M3 Threaded insert	241 A 10290 X
15	M3 Threaded insert	242 A 10300 X	15	M3 Threaded insert	241 A 10300 X
25	M3 Threaded insert	242 A 10310 X	25	M3 Threaded insert	241 A 10310 X
37	M3 Threaded insert	242 A 10320 X	37	M3 Threaded insert	241 A 10320 X
50	M3 Threaded insert	242 A 15650 X	50	M3 Threaded insert	241 A 15760 X

Mouser Electronics

Authorized Distributor

Click to View Pricing, Inventory, Delivery & Lifecycle Information:

Amphenol:

<u>241A10310X</u>	<u>241A10120X</u>	<u>241A10220X</u>	<u>241A10180X</u>	<u>241A10290X</u>	<u>241A10070X</u>	<u>241A10240X</u>	<u>241A10130X</u>
<u>241A15750X</u>	<u>241A15710X</u>	<u>242A15620X</u>	<u>242A16120X</u>	<u>242A16200X</u>	<u>241A15760X</u>	<u>241A15690X</u>	<u>241A15770X</u>
<u>241A10100X</u>	<u>241A10110X</u>	<u>241A10190X</u>	<u>241A10270X</u>	<u>241A10160X</u>	<u>241A15730X</u>	<u>241A15740X</u>	<u>241A18700X</u>
<u>241A18790X</u>	<u>241A18750X</u>	<u>241A18800X</u>	<u>241A18810X</u>	<u>241A18690X</u>	<u>241A18760X</u>	<u>241A15720X</u>	<u>241A18820X</u>
<u>241A18720X</u>	<u>242A10130X</u>	<u>242A10300X</u>	<u>242A10100X</u>	<u>242A10260X</u>	<u>241A10260X</u>	<u>241A10200X</u>	<u>241A10350X</u>
<u>241A10210X</u>	<u>241A10300X</u>	<u>241A10140X</u>	<u>241A10150X</u>	<u>241A10230X</u>	<u>241A10320X</u>	<u>241A15700X</u>	<u>241A10010X</u>
<u>241A10020X</u>	<u>241A10360X</u>	<u>242A10240X</u>	<u>242A10250X</u>	<u>242A10280X</u>	<u>242A10290X</u>	<u>242A10060X</u>	<u>242A10230X</u>
<u>242A10320X</u>	<u>242A10270X</u>	<u>242A15660X</u>	<u>242A16160X</u>	<u>242A10310X</u>	<u>242A16100X</u>	<u>242A16110X</u>	<u>242A10360X</u>
<u>242A10020X</u>	<u>242A10340X</u>	<u>242A10350X</u>	<u>242A16130X</u>	<u>241A18710X</u>	<u>241A10090X</u>	<u>241A10250X</u>	<u>241A10340X</u>
<u>241A18680X</u>	<u>241A18770X</u>	<u>241A18780X</u>	<u>242A15580X</u>	<u>242A15590X</u>	<u>242A16080X</u>	<u>242A16090X</u>	<u>242A15610X</u>
<u>242A16190X</u>	<u>242A16180X</u>	<u>242A15640X</u>	<u>242A15650X</u>	<u>242A16060X</u>	<u>242A16170X</u>	<u>241A10030X</u>	<u>241A10040X</u>
<u>242A16070X</u>	<u>242A16140X</u>	<u>242A16150X</u>	<u>241A10050X</u>	<u>242A10010X</u>	<u>242A10030X</u>	<u>242A10040X</u>	<u>242A10070X</u>
<u>242A10080X</u>	<u>242A10150X</u>	<u>242A10170X</u>	<u>242A10180X</u>				