

REV.	DATE	DESCRIPTION
NC	01/02/07	INITIAL RELEASE

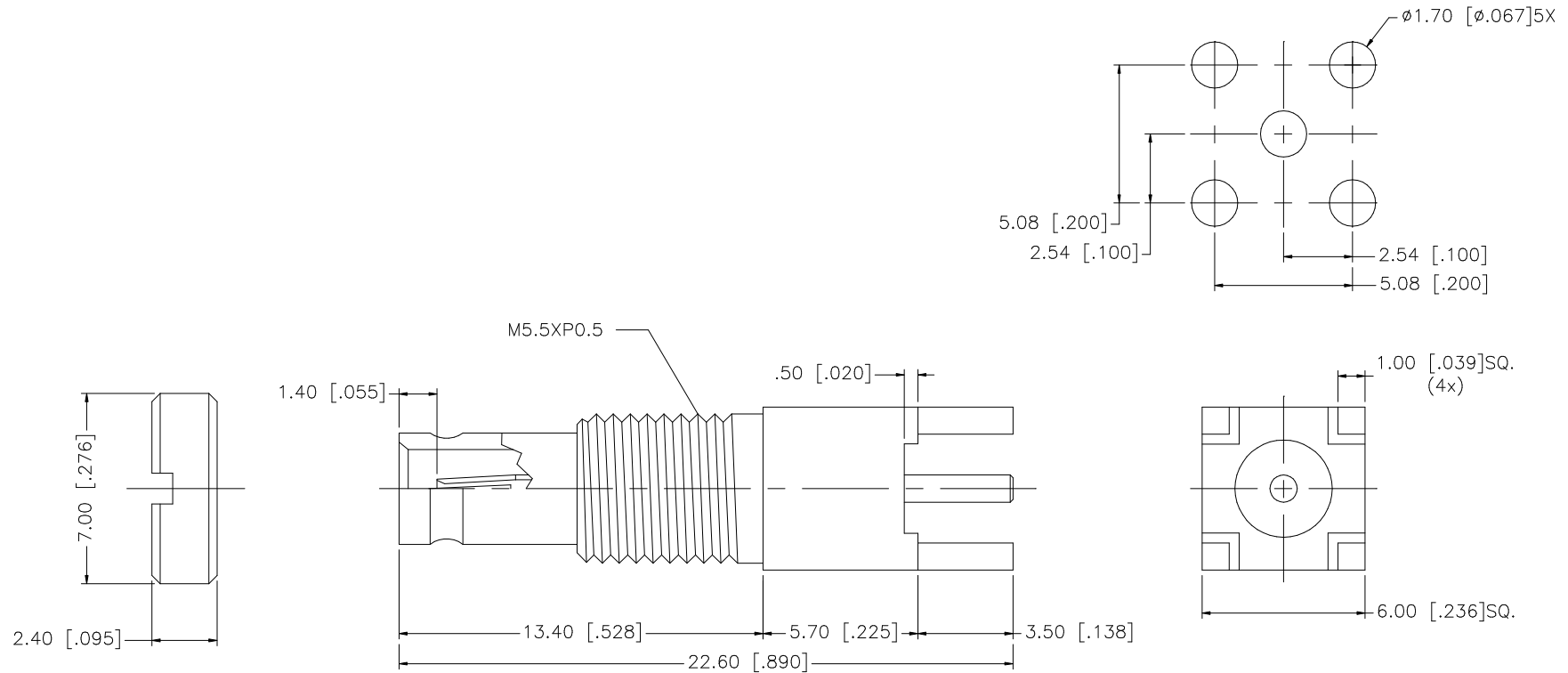

					UNLESS OTHERWISE SPECIFIED DIMENSIONS ARE IN MILLIMETERS. DIMENSIONS IN [ ] ARE IN INCHES AND FOR CUSTOMER REFERENCE ONLY.  UNLESS OTHERWISE SPECIFIED TOLERANCES FOR MILLIMETERS ARE: 0.5 – 8mm ± 0.20mm 8 – 30mm ± 0.40mm 30 – 120mm ± 0.50mm  UNLESS OTHERWISE SPECIFIED TOLERANCES FOR INCHES ARE: .020 – .315 = ± 0.007" .315 – 1.180 = ± 0.015" 1.180 – 4.724 = ± 0.020"  DO NOT SCALE DRAWING	APPROVALS		DATE		Amphenol Connex										
8						DRAWN	G.R.S.	01/02/07												
7						CHECKED									PART DESCRIPTION  1.0/2.3 PCB BULKHEAD RECEPTACLE – 75ohm					
6						ISSUED														
5						SHEET		1 OF 1		PART NO.  282121–75										
4	SPANNER NUT	BRASS	NICKEL	1		CAD FILE C:/282/282121–75.DWG									DWG. NO. 282121–75.DWG		REV. A	SIZE A	SCALE NA	
3	CONTACT PIN	BER. COPPER	GOLD	1																
2	INSULATOR	TEFLON	NATURAL	1																
1	BODY	BRASS	GOLD	1																
	DESCRIPTION	MATERIAL	FINISH	QTY																

# Mouser Electronics

Authorized Distributor

Click to View Pricing, Inventory, Delivery & Lifecycle Information:

[Amphenol:](#)

[282121-75](#)