

REVISIONS				
REV	ECO	DESCRIPTION	DATE	BY
A1	-	FIRST RELEASE	21-Nov-14	Tod
				APPR TOMMY

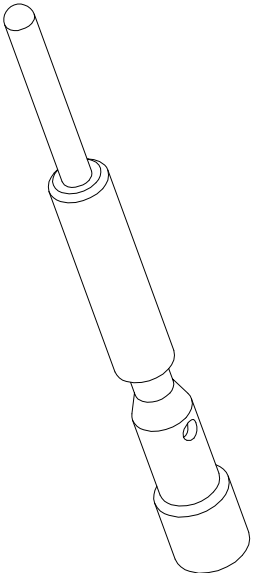
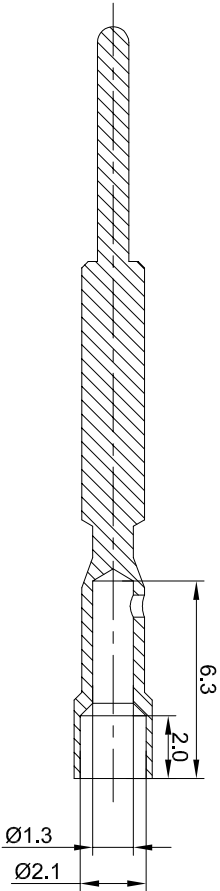
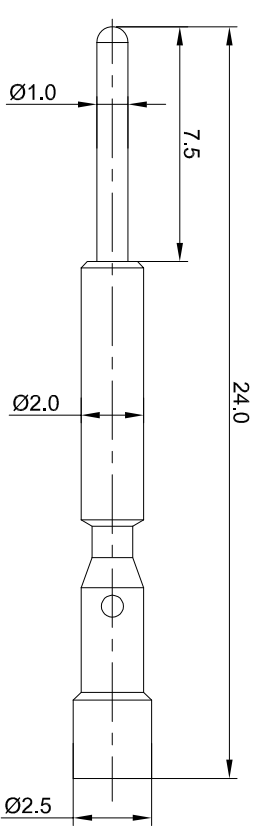

- NOTES: UNLESS OTHERWISE SPECIFIED
- MATERIAL: COPPER ALLOY, GOLD PLATED
 - SPECIFICATIONS:
 - 2.1 RATED CURRENT: 7 AMPS
 - 2.2 CONTACT RESISTANCE: <5 milliohm
 - 2.3 AVAILABLE WIRE RANGE: 18-22AWG
 - 2.4 RoHS COMPLIANT
 - ALL DIMENSIONS ARE FOR REFERENCE USE ONLY.

QUANTITY		SEE PART NUMBER CHART		DESCRIPTION		ITEM
PART NUMBER		MATERIALS LIST				
UNLESS OTHERWISE SPECIFIED: 1) All dimensions are in millimeters. 2) Tolerances are as follows: 1 Pl. DEC 40.30 Fractions ±.104 3 Pl. DEC 40.08 Angles ±1° 3) Note reference =		SIGNATURES		DATE		
DRAWN: Tod		21-Nov-14				
CREATED: 1 Pl. DEC 40.30						
ENGINEER: 3 Pl. DEC 40.08						
APPROVAL:						
MATERIAL SPECIFICATIONS:		CUSTOMER:				
PROCESS SPECIFICATIONS:		THIS DRAWING IS SUBMITTED FOR INFORMATION ONLY. ALL DESIGN FEATURES, SPECIFICATIONS AND PERFORMANCE DATA ARE THE PROPERTY OF SHE SYSTEMS. NO PARTS OF REPRODUCTION ARE PERMITTED. ALL MANUFACTURING VARIATIONS.				
NEXT ASSTY:		SCALE: 8:1		SHEET 1 OF 1		

Amphenol
 She Systems - www.amphenol-she.com
 44724 Morley Drive
 Clinton Township, MI 48036

Pin, 1.0mm, Crimp 18-22AGW

SIZE: B TYPE: C- DWG NO: SC000338

REVISION: A1

TITLE:

Pin, 1.0mm, Crimp 18-22AGW

DWG NO:

SC000338

REV: A1

SH: 1

OF: 1

Mouser Electronics

Authorized Distributor

Click to View Pricing, Inventory, Delivery & Lifecycle Information:

[Amphenol:](#)

[SC000338](#)