

REV.	DATE	DESCRIPTION
A	03/27/05	UPDATE DRAWING FORMAT

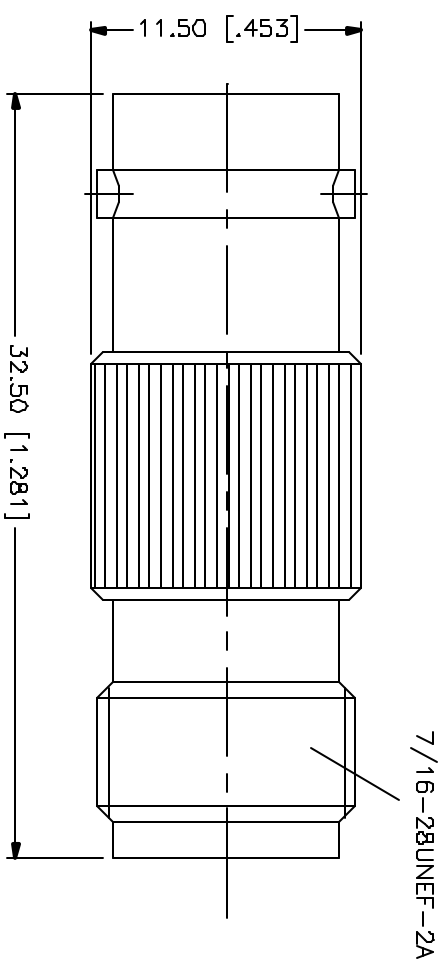

NO.	DESCRIPTION	MATERIAL	FINISH	QTY	UNLESS OTHERWISE SPECIFIED, DIMENSIONS ARE IN MILLIMETERS (PARENTS IN [ ] ARE IN INCHES AND THE DIMENSION REFERENCE DATA.)	APPROVALS	DATE	PART DESCRIPTION
1	CONTACT FIN	PHOS. BRONZE	GOLD	1	UNLESS OTHERWISE SPECIFIED, DIMENSIONS ARE IN MILLIMETERS (PARENTS IN [ ] ARE IN INCHES AND THE DIMENSION REFERENCE DATA.)	DRAWN G.R.S.	03/27/05	<b>Amphenol Connex</b> BNC FEMALE TO TNC FEMALE ADAPTER 242150
2	INSULATOR	TEFLON	NATURAL	1	UNLESS OTHERWISE SPECIFIED, DIMENSIONS ARE IN MILLIMETERS (PARENTS IN [ ] ARE IN INCHES AND THE DIMENSION REFERENCE DATA.)	CHECKED		
3	INSULATOR BODY	BRASS	NICKEL	1	UNLESS OTHERWISE SPECIFIED, DIMENSIONS ARE IN MILLIMETERS (PARENTS IN [ ] ARE IN INCHES AND THE DIMENSION REFERENCE DATA.)	ISSUED		
4					UNLESS OTHERWISE SPECIFIED, DIMENSIONS ARE IN MILLIMETERS (PARENTS IN [ ] ARE IN INCHES AND THE DIMENSION REFERENCE DATA.)	SHEET 1 OF 1		
5					UNLESS OTHERWISE SPECIFIED, DIMENSIONS ARE IN MILLIMETERS (PARENTS IN [ ] ARE IN INCHES AND THE DIMENSION REFERENCE DATA.)			
DESCRIPTION						DAD FILE C:/242/242150.DWG		DWG. NO. 242150.DWG
						REV. A	SIZE A	SCALE NA

# Mouser Electronics

Authorized Distributor

Click to View Pricing, Inventory, Delivery & Lifecycle Information:

[Amphenol:](#)

[242150](#)