

CAT. NO. & DIMENSIONS

NO. OF CONTACTS (n)	CAT. NO.	DIMENSIONS (NOTE2)			
		A ± 0.2	B ± 0.2	C ± 0.1	D ± 0.1
4	SFV 4R-3/4STB__HLF	7.5	5.9	1.5	1.6
5	SFV 5R-3/4STB__HLF	8.0	6.4	2.0	2.1
6	SFV 6R-3/4STB__HLF	8.5	6.9	2.5	2.6
7	SFV 7R-3/4STB__HLF	9.0	7.4	3.0	3.1
8	SFV 8R-3/4STB__HLF	9.5	7.9	3.5	3.6
9	SFV 9R-3/4STB__HLF	10.0	8.4	4.0	4.1
10	SFV10R-3/4STB__HLF	10.5	8.9	4.5	4.6
11	SFV11R-3/4STB__HLF	11.0	9.4	5.0	5.1
12	SFV12R-3/4STB__HLF	11.5	9.9	5.5	5.6
13	SFV13R-3/4STB__HLF	12.0	10.4	6.0	6.1
14	SFV14R-3/4STB__HLF	12.5	10.9	6.5	6.6
15	SFV15R-3/4STB__HLF	13.0	11.4	7.0	7.1
16	SFV16R-3/4STB__HLF	13.5	11.9	7.5	7.6
17	SFV17R-3/4STB__HLF	14.0	12.4	8.0	8.1
18	SFV18R-3/4STB__HLF	14.5	12.9	8.5	8.6
19	SFV19R-3/4STB__HLF	15.0	13.4	9.0	9.1
20	SFV20R-3/4STB__HLF	15.5	13.9	9.5	9.6
21	SFV21R-3/4STB__HLF	16.0	14.4	10.0	10.1
22	SFV22R-3/4STB__HLF	16.5	14.9	10.5	10.6
23	SFV23R-3/4STB__HLF	17.0	15.4	11.0	11.1
24	SFV24R-3/4STB__HLF	17.5	15.9	11.5	11.6
25	SFV25R-3/4STB__HLF	18.0	16.4	12.0	12.1
26	SFV26R-3/4STB__HLF	18.5	16.9	12.5	12.6
27	SFV27R-3/4STB__HLF	19.0	17.4	13.0	13.1
28	SFV28R-3/4STB__HLF	19.5	17.9	13.5	13.6
29	SFV29R-3/4STB__HLF	20.0	18.4	14.0	14.1
30	SFV30R-3/4STB__HLF	20.5	18.9	14.5	14.6
31	SFV31R-3/4STB__HLF	21.0	19.4	15.0	15.1
32	SFV32R-3/4STB__HLF	21.5	19.9	15.5	15.6
33	SFV33R-3/4STB__HLF	22.0	20.4	16.0	16.1
34	SFV34R-3/4STB__HLF	22.5	20.9	16.5	16.6
35	SFV35R-3/4STB__HLF	23.0	21.4	17.0	17.1

CAT. NO. SFV (n) R - 3 ST B __ HLF

SERIES NAME

NO. OF CONTACTS

RIGHT ANGLE TYPE

FOR FPC,
WITH CABLE LOCK MECHANISM

CONTACT DIRECTION
3: LOWER CONTACT TYPE
4: UPPER CONTACT TYPE

FOR AUTOMATIC MOUNTING (SMT)

PLATING VARIATION

PACKAGE STYLE

HALOGEN AND LEAD FREE

NOTES

- THIS PRODUCT IS THE CONNECTOR USED FOR FPC AND COPELS WITH AUTOMATIC MOUNTING (SMT).
- SEE PART DRAWINGS FOR DIMENSIONS A~D.
- THIS PRODUCT IS THE CONNECTOR WITH CABLE LOCK MECHANISM.

mat'l. code				surface 58/ISO 1302		tolerance ISO 406 ISO 1101		projection		product family 58EF			
ltr	ecn no	dr	date	tolerances unless otherwise specified						title			
A				angles	linear			MM		CAT. NO. TABLE FOR 0.5 mm CONTACT SPACING CONNECTOR (Cat. No. : SFV__R-3/4STB__HLF)			
								scale N/A		dwg no sheet 2 of 8 size			
				dr				Amphenol FCI		10142909 A4			
				engr						type CUSTOMER Drawing			
				chr									
				appd									
sheet index	revision sheet												

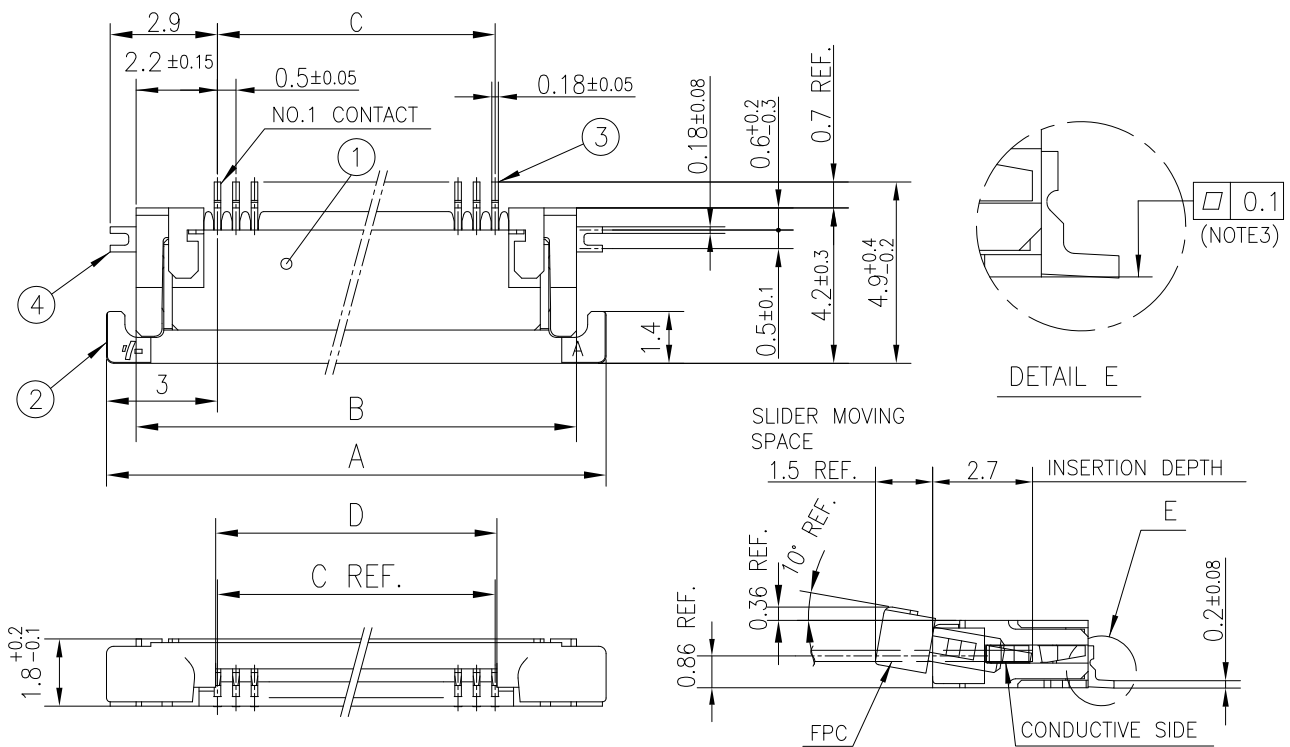

PT. NO.	PARTS NAME	MATERIAL	Q'TY	NOTE
1	HOUSING	13~35pin : LCP RESIN GLASS REINFORCED (UL94V-0)	1	COLOR : BLACK (HALOGEN FREE)
		4~12pin : POLYAMIDE RESIN GLASS REINFORCED (UL94V-0)		
2	SLIDER	PPS RESIN GLASS REINFORCED (UL94V-0)	1	COLOR : BLACK (HALOGEN FREE)
3	CONTACT	PHOSPHOR BRONZE	n	PLATING : Contact area Au 0.08um min. Terminal area Au 0.05um min. (With Ni Dam) UNDER PLATING : Ni 1.27um min.
4	MOUNTING PLATE			PLATING : Tin 1.5um min. UNDER PLATING : Ni 1.27um min.

n : NO. OF CONTACTS

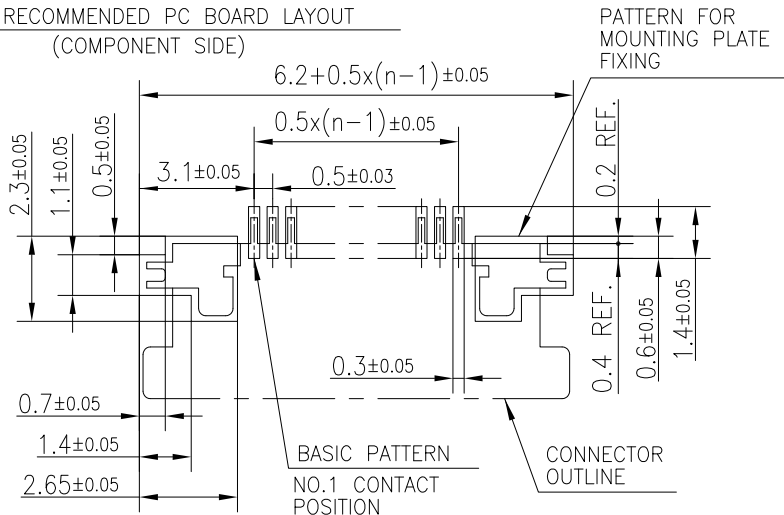
RECOMMENDED PC BOARD LAYOUT
(COMPONENT SIDE)

NOTES

- THIS PRODUCT IS THE CONNECTOR USED FOR FPC AND COPS WITH AUTOMATIC MOUNTING (SMT).
- THIS PRODUCT IS LOWER CONTACT TYPE CONNECTOR WITH CABLE LOCK MECHANISM.
- FLATNESS OF CONTACT TERMINAL AND MOUNTING PLATE MUST BE WITHIN TOLERANCE IN E PORTION DETAILED DRAWING.
- THIS PRODUCT MEETS EUROPEAN UNION DIRECTIVES AND OTHER COUNTRY REGULATIONS AS DESCRIBED IN GS-22-008.
- THE HOUSING WILL WITHSTAND EXPOSURE TO 260°C PEAK TEMPERATURE FOR 10 SECONDS IN A REFLOW SOLDERING OVEN.

mat'l. code				surface 58	tolerance	projection	product family			
-				ISO 1302	ISO 406 ISO 1101		58EF			
ltr	ecn no	dr	date	tolerances unless otherwise specified			title			
A				angles	linear	MM	CONNECTOR USED FOR FPC WITH 0.5 mm CONTACT SPACING (Cat. No. : SFV__R-3STB__HLF)			
						scale N/A	dwg no			
							sheet 3 of 8			
							10142909			
							size A4			
							type			
							CUSTOMER Drawing			
sheet index	revision									
	sheet									

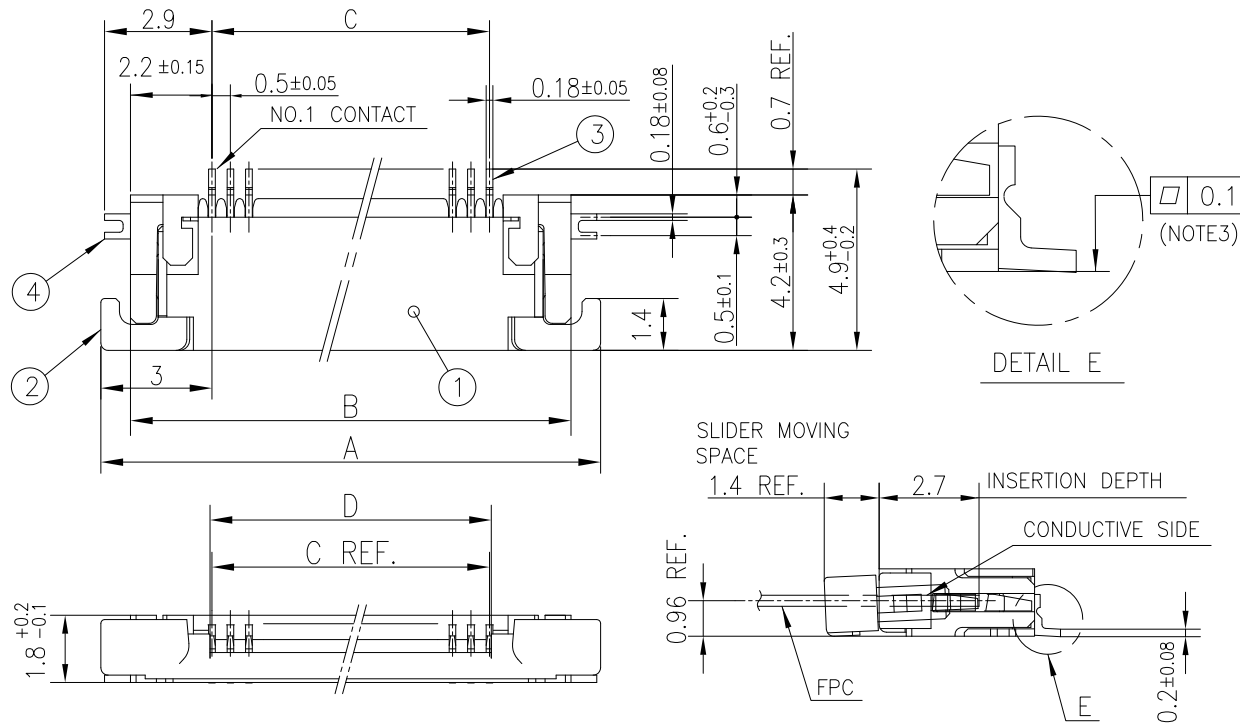

PT. NO.	PARTS NAME	MATERIAL	Q'TY	NOTE
1	HOUSING	13~35pin : LCP RESIN GLASS REINFORCED (UL94V-0)	1	COLOR : BLACK (HALOGEN FREE)
		4~12pin : POLYAMIDE RESIN GLASS REINFORCED (UL94V-0)		
2	SLIDER	PPS RESIN GLASS REINFORCED (UL94V-0)	1	COLOR : BLACK (HALOGEN FREE)
3	CONTACT	PHOSPHOR BRONZE	n	PLATING : Contact area Au 0.08um min. Terminal area Au 0.05um min. (With Ni Dam) UNDER PLATING : Ni 1.27um min.
4	MOUNTING PLATE			PLATING : Tin 1.5um min. UNDER PLATING : Ni 1.27um min.

n : NO. OF CONTACTS

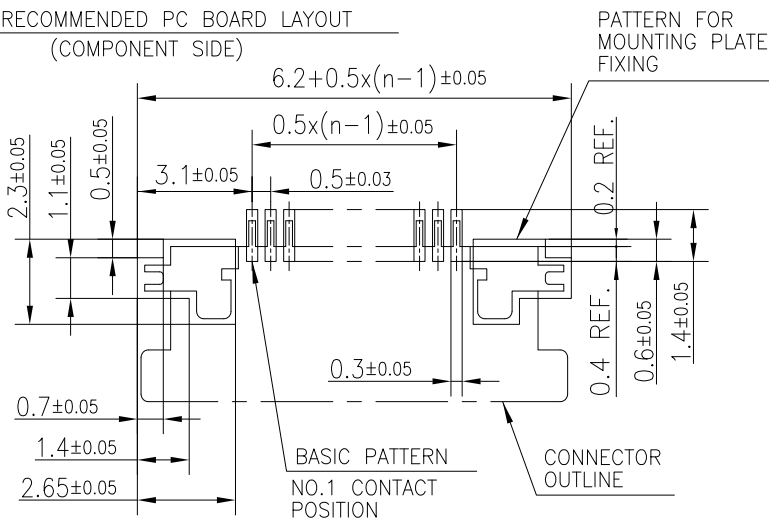
RECOMMENDED PC BOARD LAYOUT
(COMPONENT SIDE)

NOTES

- THIS PRODUCT IS THE CONNECTOR USED FOR FPC AND COPS WITH AUTOMATIC MOUNTING (SMT).
- THIS PRODUCT IS UPPER CONTACT TYPE CONNECTOR WITH CABLE LOCK MECHANISM.
- FLATNESS OF CONTACT TERMINAL AND MOUNTING PLATE MUST BE WITHIN TOLERANCE IN E PORTION DETAILED DRAWING.
- THIS PRODUCT MEETS EUROPEAN UNION DIRECTIVES AND OTHER COUNTRY REGULATIONS AS DESCRIBED IN GS-22-008.
- THE HOUSING WILL WITHSTAND EXPOSURE TO 260°C PEAK TEMPERATURE FOR 10 SECONDS IN A REFLOW SOLDERING OVEN.

mat'l. code				surface 58	tolerance	projection	product family			
-				ISO 1302	ISO 406 ISO 1101		58EF			
ltr	ecn no	dr	date	tolerances unless otherwise specified			title			
A				angles	linear	MM				
						scale N/A	CONNECTOR USED FOR FPC WITH 0.5 mm CONTACT SPACING (Cat. No. : SFV__R-4STB__HLF)			
				dr		Amphenol FCi	dwg no		sheet 4 of 8	size
				enr			10142909			A4
				chr			type		CUSTOMEER Drawing	
				appd						
sheet index	revision sheet									

CAT. NO. & DIMENSIONS

NO. OF CONTACTS (n)	CAT. NO.	DIMENSIONS (NOTE3)		
		F MAX.	G ± 0.3	H ± 0.1
4	SFV4R-3/4STBE9HLF	22.4	16	—
5	SFV5R-3/4STBE9HLF	22.4	16	—
6	SFV6R-3/4STBE9HLF	22.4	16	—
7	SFV7R-3/4STBE9HLF	30.4	24	—
8	SFV8R-3/4STBE9HLF	30.4	24	—
9	SFV9R-3/4STBE9HLF	30.4	24	—
10	SFV10R-3/4STBE9HLF	30.4	24	—
11	SFV11R-3/4STBE9HLF	30.4	24	—
12	SFV12R-3/4STBE9HLF	30.4	24	—
13	SFV13R-3/4STBE9HLF	30.4	24	—
14	SFV14R-3/4STBE9HLF	30.4	24	—
15	SFV15R-3/4STBE9HLF	30.4	24	—
16	SFV16R-3/4STBE9HLF	30.4	24	—
17	SFV17R-3/4STBE9HLF	30.4	24	—
18	SFV18R-3/4STBE9HLF	30.4	24	—
19	SFV19R-3/4STBE9HLF	30.4	24	—
20	SFV20R-3/4STBE9HLF	30.4	24	—
21	SFV21R-3/4STBE9HLF	30.4	24	—
22	SFV22R-3/4STBE9HLF	30.4	24	—
23	SFV23R-3/4STBE9HLF	38.4	32	28.4
24	SFV24R-3/4STBE9HLF	38.4	32	28.4
25	SFV25R-3/4STBE9HLF	38.4	32	28.4
26	SFV26R-3/4STBE9HLF	38.4	32	28.4
27	SFV27R-3/4STBE9HLF	38.4	32	28.4
28	SFV28R-3/4STBE9HLF	38.4	32	28.4
29	SFV29R-3/4STBE9HLF	38.4	32	28.4
30	SFV30R-3/4STBE9HLF	38.4	32	28.4
31	SFV31R-3/4STBE9HLF	50.4	44	40.4
32	SFV32R-3/4STBE9HLF	50.4	44	40.4
33	SFV33R-3/4STBE9HLF	50.4	44	40.4
34	SFV34R-3/4STBE9HLF	50.4	44	40.4
35	SFV35R-3/4STBE9HLF	50.4	44	40.4

CAT. NO. SFV (n) R - 3 ST B E9 HLF

SERIES NAME —

NO. OF CONTACTS —

RIGHT ANGLE TYPE —

FOR FPC,
WITH CABLE LOCK MECHANISM
CONTACT DIRECTION

3: LOWER CONTACT TYPE
4: UPPER CONTACT TYPE

FOR AUTOMATIC MOUNTING
(SMT)

PLATING VARIATION —

TAPE PACKAGING FOR E9 —
(500pcs PER REEL)

LEAD AND HALOGEN FREE —

NOTES

1. THIS PRODUCT IS THE CONNECTOR USED FOR FPC AND COPEs WITH AUTOMATIC MOUNTING (SMT).
2. THIS CATALOG NO. INDICATES PLASTIC TAPE PACKAGED CONNECTOR.
3. SEE PART DRAWINGS FOR DIMENSIONS F~H.

mat'l. code				surface 58/ISO 1302		tolerance ISO 406 ISO 1101		projection		product family 58EF			
ltr	ecn no	dr	date	tolerances unless otherwise specified						title			
A				angles	linear			MM		CAT. NO. TABLE FOR PLASTIC TAPE PACKAGED 0.5 mm CONTACT SPACING CONNECTOR (Cat. No. : SFV__R-3/4STBE9HLF)			
								scale N/A		dwg no sheet 5 of 8 size			
				dr				Amphenol FCI		10142909 A4			
				engr						type CUSTOMEER Drawing			
				chr									
				appd									
sheet index	revision sheet												

TOLERANCES
UNLESS OTHERWISE SPECIFIED : ± 5 , ANGLE $\pm 5^\circ$

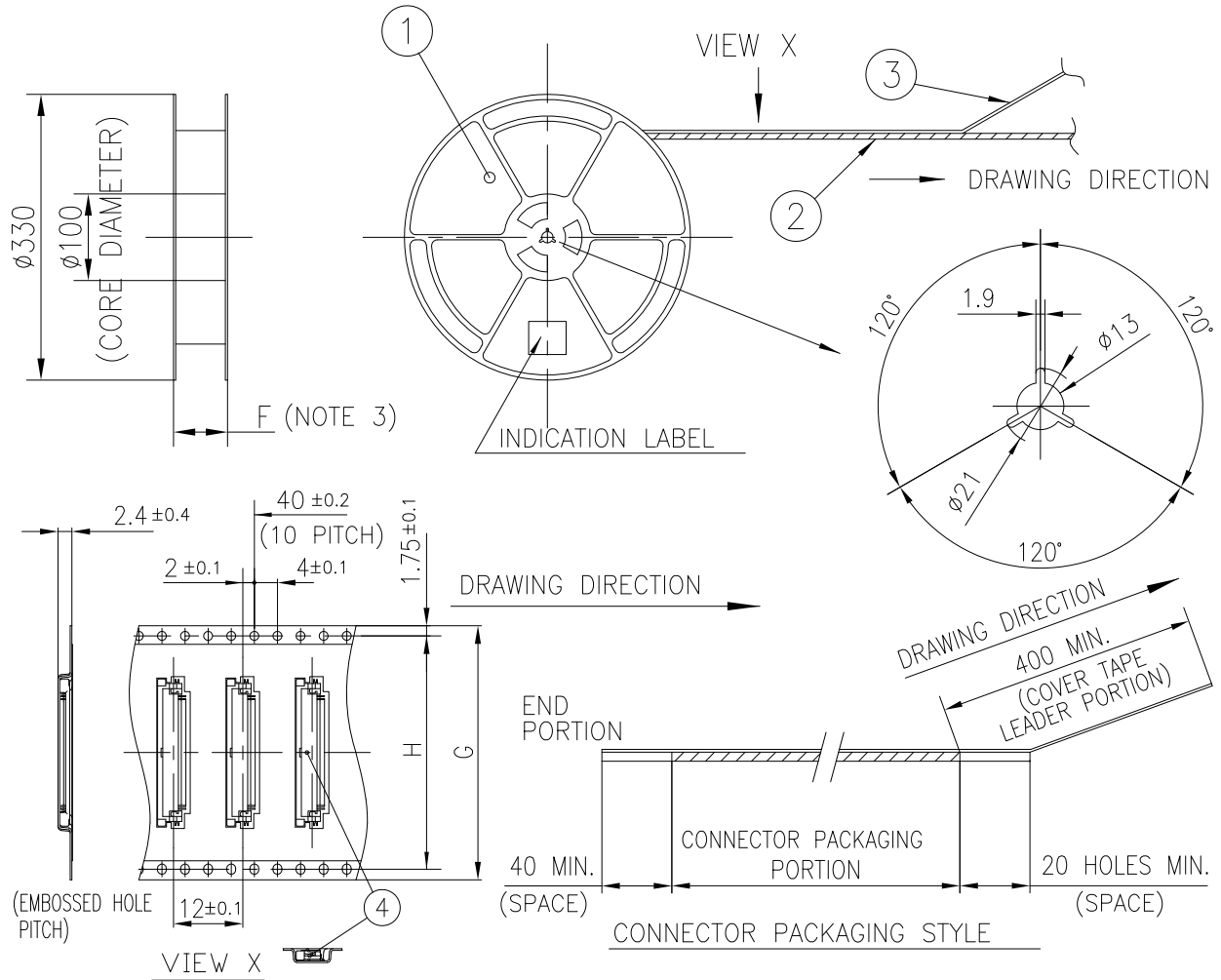

PT. NO.	PARTS NAME	CAT. NO.	MATERIAL	Q'TY	NOTE
1	REEL		POLYSTYRENE	1	COLOR : BLACK
2	PLASTIC (EMBOSS) TAPE		A-PET		COLOR : TRANSPARENCY
3	COVER		POLYESTER		COLOR : TRANSPARENCY
4	CONNECTOR	SFV__R-3STB__HLF	SEE SHEET 3	500	LOWER CONTACT TYPE WITH CABLE LOCK MECHANISM

NOTES

- THIS IS PLASTIC TAPE PACKAGED CONNECTOR USED FOR FPC AND COPES WITH AUTOMATIC MOUNTING (SMT).
- SEE JIS C 0806 (PACKING OF ELECTRONIC COMPONENTS ON CONTINUOUS TAPES (SURFACE MOUNTING DEVICES)) FOR SHAPE AND DIMENSIONS OF PLASTIC (EMBOSS) TAPE AND REEL.
- F DIMENSION IS PORTION OF THE CORE.

mat'l. code				surface 58	tolerance	projection	product family			
-				ISO 1302	ISO 406 ISO 1101		58EF			
ltr	ecn no	dr	date	tolerances unless otherwise specified			title			
A				angles	linear	MM				
						scale N/A	0.5 mm CONTACT SPACING CONNECTOR (Cat. No. : SFV__R-3STBE9HLF)			
				dr		Amphenol FCI	dwg no		sheet 6 of 8	size
				enr			10142909			A4
				chr			type			
				appd			CUSTOMEER Drawing			
sheet index	revision									
	sheet									

TOLERANCES
UNLESS OTHERWISE SPECIFIED : ± 5 , ANGLE $\pm 5^\circ$

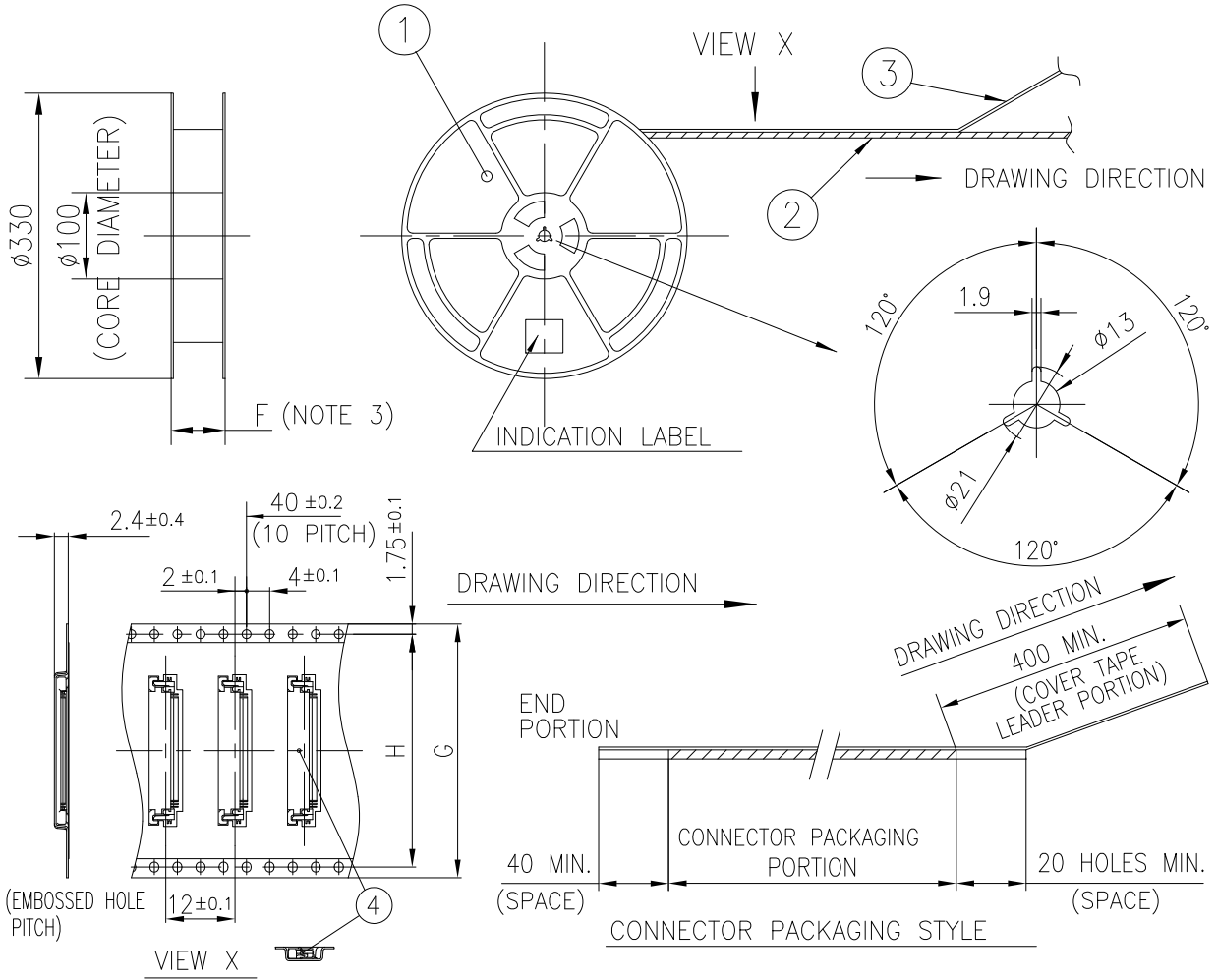

PT. NO.	PARTS NAME	CAT. NO.	MATERIAL	Q'TY	NOTE
1	REEL		POLYSTYRENE	1	COLOR : BLACK
2	PLASTIC (EMBOSS) TAPE		A-PET		COLOR : TRANSPARENCY
3	COVER		POLYESTER		COLOR : TRANSPARENCY
4	CONNECTOR	SFV__R-4STB__HLF	SEE SHEET 4	500	UPPER CONTACT TYPE WITH CABLE LOCK MECHANISM

NOTES

- THIS IS PLASTIC TAPE PACKAGED CONNECTOR USED FOR FPC AND COPES WITH AUTOMATIC MOUNTING (SMT).
- SEE JIS C 0806 (PACKING OF ELECTRONIC COMPONENTS ON CONTINUOUS TAPES (SURFACE MOUNTING DEVICES)) FOR SHAPE AND DIMENSIONS OF PLASTIC (EMBOSS) TAPE AND REEL.
- F DIMENSION IS PORTION OF THE CORE.

mat'l. code				surface 58	tolerance	projection	product family			
-				ISO 1302	ISO 406 ISO 1101		58EF			
ltr	ecn no	dr	date	tolerances unless otherwise specified			title			
A				angles	linear	MM				
						scale N/A	0.5 mm CONTACT SPACING CONNECTOR (Cat. No. : SFV__R-4STBE9HLF)			
				dr						
				enr			dwg no			
				chr						
				appd			sheet 7 of 8			
sheet index	revision sheet						10142909			
							CUSTOMER Drawing			

RECOMMENDED CABLE (FPC)

n : NO. OF CONTACTS

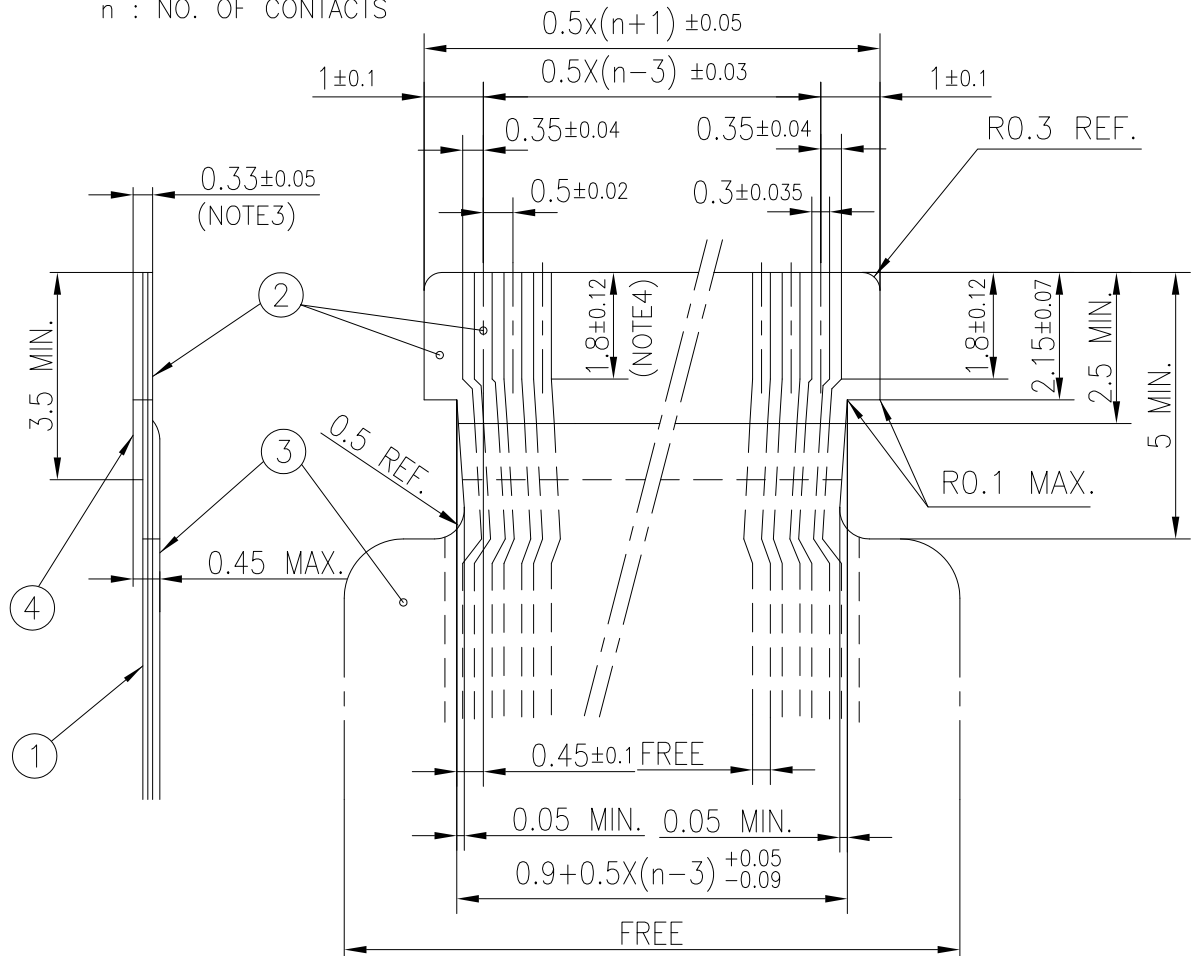

PT. NO.	PARTS NAME	MATERIAL	THICKNESS (um)
1	BASE FILM	POLYIMIDE OR POLYESTER OR EQUAL	25
2	CONDUCTOR	COPPER FOIL(PLATING : GOLD)	35
3	OVERLAY	POLYIMIDE OR POLYESTER OR EQUAL	—
4	SUPPORTING TAPE	POLYESTER OR POLYIMIDE OR EQUAL	188

NOTES

1. NO BURR AT EACH PORTION.
2. NO PEELING IN COMMON USE.
3. TOTAL THICKNESS LIMIT OF EACH MATERIAL (INCLUDING ADHESIVE AGENT) IS SPECIFIED.
4. THIS DIMENSION INDICATES THE RANGE FOR 0.3±0.035 CONDUCTOR WIDTH.

mat'l. code				surface 58/ISO 1302		tolerance ISO 406 ISO 1101		projection		product family 58EF			
—				ISO 1302		ISO 406 ISO 1101		MM		title			
ltr	ecn no	dr	date	tolerances unless otherwise specified						RECOMMENDED CABLE			
A				angles linear						(Cat. No. : SFV__R-3/4STB__HLF)			
								scale N/A		dwg no sheet 8 of 8 size			
				dr				Amphenol FCI		10142909 A4			
				engr						type			
				chr						CUSTOMEER Drawing			
				appd									
sheet index		revision sheet											

Mouser Electronics

Authorized Distributor

Click to View Pricing, Inventory, Delivery & Lifecycle Information:

[FCI / Amphenol:](#)

[SFV7R-4STBE9HLF](#)