

REVISIONS					
REV.	ECO	DESCRIPTION	DATE	BY	APPROVED
A1	-	INITIAL RELEASE	1APR20	TZ	TZ

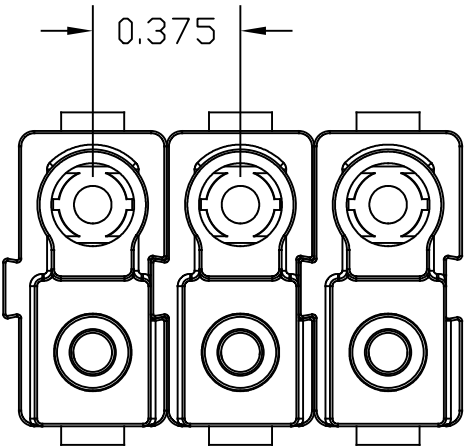
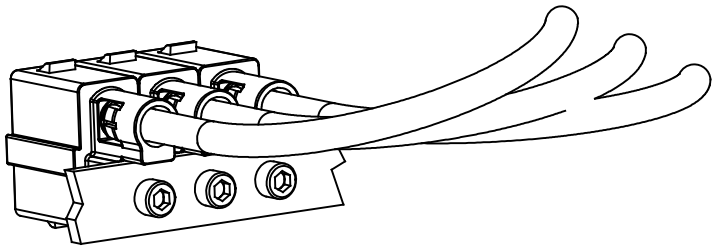
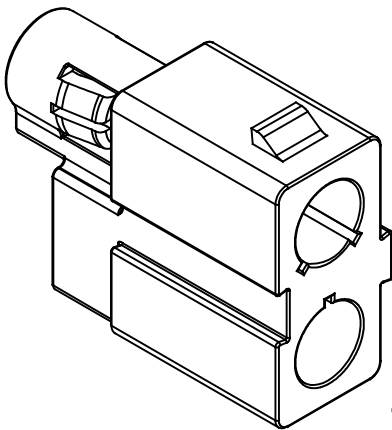
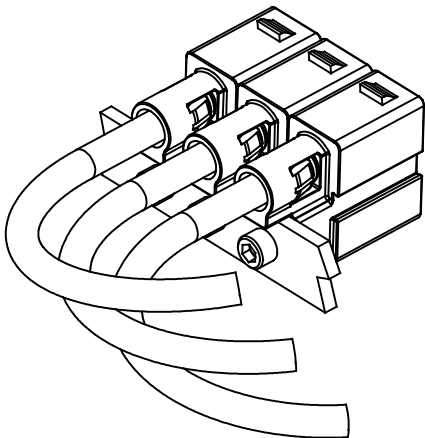
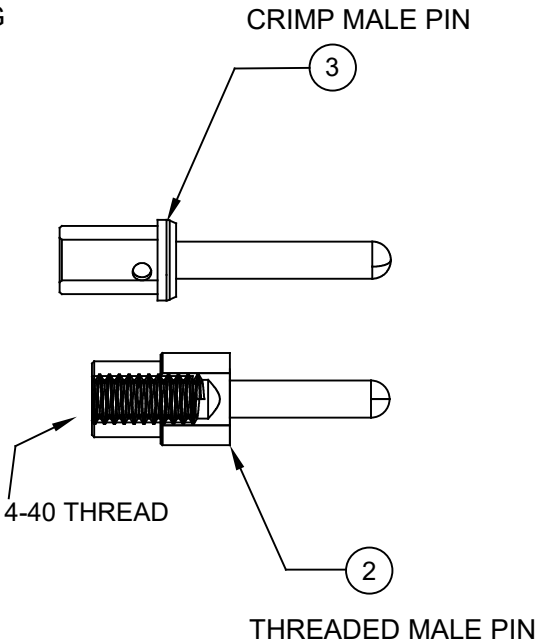
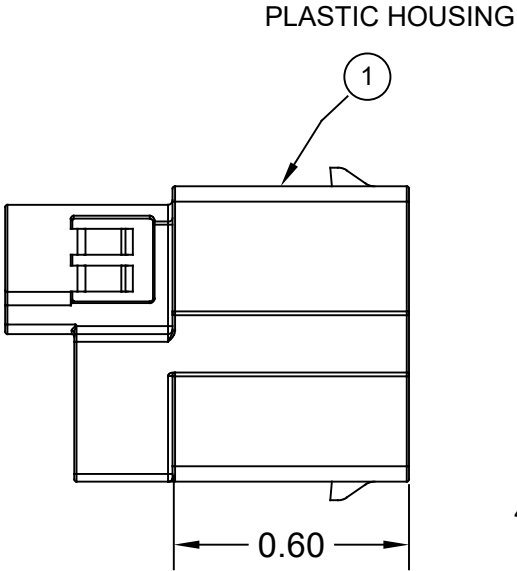
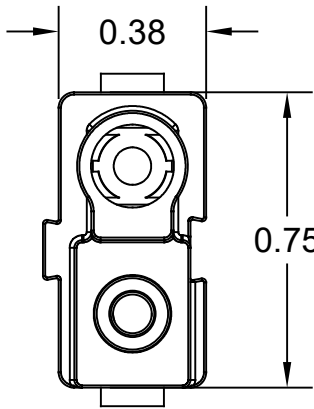

STACKABLE TO REDUCE FOOTPRINT

ALL DIMENSIONS REF ONLY

TECHNICAL DATA:

1) MATERIALS:

CONTACT: SILVER PLATING OVER COPPER ALLOY
MATERIAL: GF NYLON 6/6 COLOR: BLACK

2) UL / CUL : APPROVED TO 32 AMPS, E336860



1	SC000611	2.4MM PIN, 10AWG CRIMP	3
1	SC000565	2.4MM PIN, 4-40 THREADED	2
1	PL000733	PANEL SIDE, PLASTIC HOUSING	1
	PART NUMBER	DESCRIPTION	ITEM
QUANTITY	MATERIALS LIST		
<div>UNLESS OTHERWISE SPECIFIED</div> <div>1) All dimensions are in inches. 2) Tolerances are as follows: 1 PL DEC ±0.05 2 PL DEC ±0.01 3 PL DEC ±0.005 3) Fabrication Standards Per: S5-20020 4) Note Reference = </div> <div>MATERIAL SPECIFICATIONS:</div> <div>MATERIAL SPECIFICATION</div> <div>PROCESS SPECIFICATIONS:</div> <div>S3-20003</div> <div>NEXT ASSY: NEXT ASM</div>		<div>SIGNATURES</div> <div>DATE</div> <div>DRAWN: TZ 1JAN20</div> <div>CHECKED: RC 1APR20</div> <div>ENGINEER: TZ</div> <div>APPROVAL: TZ 1APR20</div> <div>CUSTOMER:</div> <div>THE USE OF THIS DOCUMENT IS UNLIMITED. DESIGN FEATURES, SPECIFICATIONS, AND PERFORMANCE DATA SHOWN HEREIN ARE THE PROPERTY OF AMPHENOL CORP. ALL DIMENSIONS ARE SUBJECT TO NORMAL MANUFACTURING VARIATIONS. DOCUMENTS REFERENCED HEREIN MAY CONTAIN LIMITED RIGHTS DATA.</div>	<div>SINE Systems Corporation</div> <div>A Subsidiary of Amphenol Corporation 44724 Morley Drive Clinton Township, MI 48036</div> <div>KIT, 2 POSN MALE RECP, PIN, PRM SERIES 12-14AWG MACHINED CONTACT MATES WITH PRM2400-GX-PLG</div> <div>SIZE: B FSC# 1GK44 DWG# PRM2.400-G2-PNL REVISION: A1</div> <div>SCALE: SCALE: 2:1 SHEET 1 OF 1</div>

SINE Systems Corporation

A Subsidiary of Amphenol Corporation
44724 Morley Drive
Clinton Township, MI 48036

KIT, 2 POSN MALE RECPT, PIN, PRM SERIES
12-14AWG MACHINED CONTACT MATES WITH PRM2400-GX-PLG

Mouser Electronics

Authorized Distributor

Click to View Pricing, Inventory, Delivery & Lifecycle Information:

[Amphenol:](#)

[PRM2400-G2-PNL](#)