

FOR REFERENCE ONLY

A

NX301AB1B

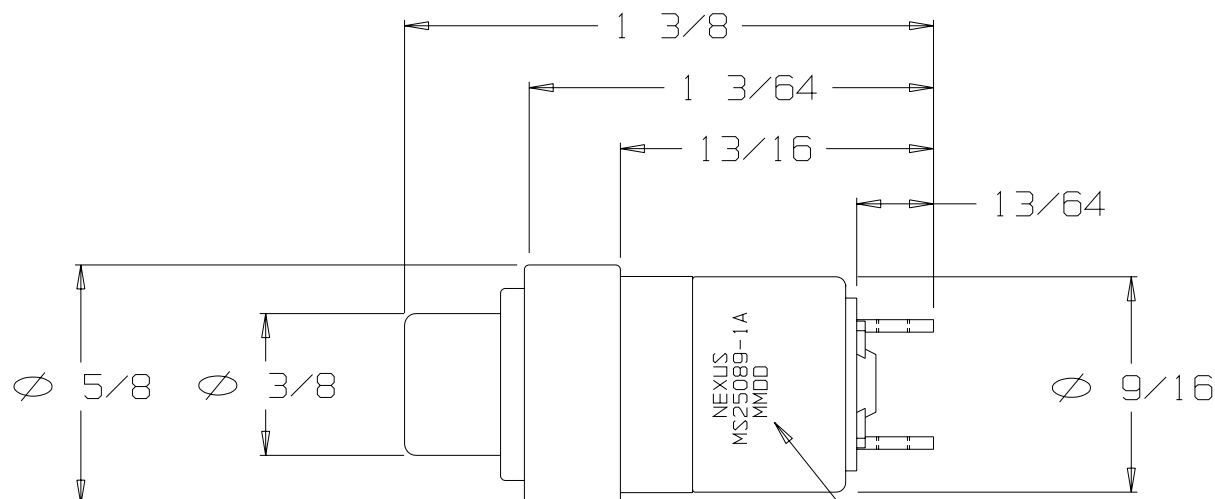

CONTACT
ARRANGEMENT
(SPNO)

"MMDD" IS THE
DATE CODE

DUSTPROOF "SERIES 300" MOMENTARY SWITCH
CONTACTS SPNO - SINGLE POLE NORMALLY OPEN
ADAPTER TYPE "A", COLOR BLACK
BUTTON #1, COLOR BLACK

THIS DOCUMENT CONTAINS PROPRIETARY INFORMATION OF NEXUS, INCORPORATED AND SUCH INFORMATION MAY NOT BE DISCLOSED TO OTHERS FOR ANY PURPOSE OR USED FOR ANY PURPOSE WITHOUT THE WRITTEN CONSENT OF NEXUS.

OWN. BY EWT	DATE 7/1/05	MATERIAL N/A	
CHECKED BY	DATE	FINISH N/A	
APPR. BY	DATE	WEIGHT	SCALE 2:1
UNLESS OTHERWISE SPECIFIED DIMENSIONS ARE IN INCHES TOLERANCES ON .XX .XXX ANGLES ±.003 ±.5°		TITLE SWITCH MOMENTARY	
		DO NOT SCALE DWG.	SHEET 1 OF 1
A	INITIAL RELEASE	CN #	7/1/05 EWT
LET.	REVISION	DATE	CHK.
		SIZE A	DWG. NO. NX301AB1B

Mouser Electronics

Authorized Distributor

Click to View Pricing, Inventory, Delivery & Lifecycle Information:

[Amphenol:](#)

[NX301AB1B](#) [NX301AB1R](#) [NX301AB1W](#) [MS25089-1A](#) [MS25089-1AR](#)