

| REVISIONS | | | | |
|-----------|-----|------------------------|-------------|-------------|
| REV | ECO | DESCRIPTION | DATE | BY APPR |
| B1 | - | RELEASE NEW DWG FORMAT | May.10.2014 | Drack Tommy |
| B2 | - | UPDATE THE DURABILITY | Jun.27.2015 | Drack Tommy |
| B3 | - | UPDATED NUT | Dec.02.2015 | Flan Tommy |

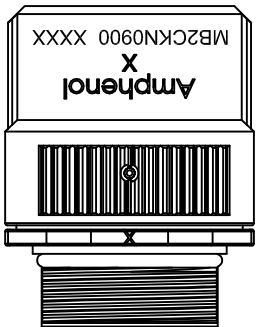
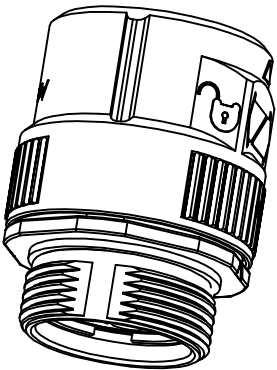
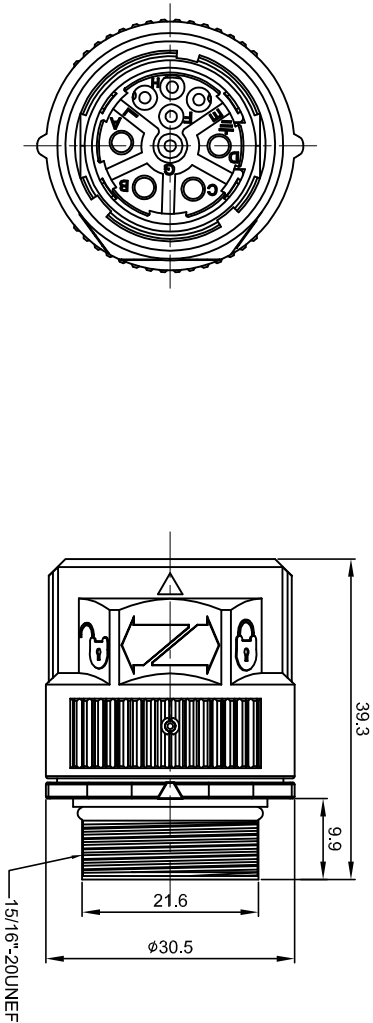

NOTES: UNLESS OTHERWISE SPECIFIED

1. MATERIAL:
INSULATION INSERT:PA66,UL94 V0
SEAL: VITON
HOUSING BODY: ZINC DIE CAST, NICKEL PLATED
COUPLING NUT: ZINC DIE CAST, NICKEL PLATED

2. SPECIFICATIONS:
2.1 CURRENT RATING: SIGNAL: 10 AMPS
POWER: 30AMPS
2.2 VOLTAGE RATING: SIGNAL: 250V AC/DC
POWER: 630V AC/DC
2.3 OPERATING TEMPERATURE: -20°C TO +130°C
2.4 DIELECTRIC WITHSTANDING VOLTAGE: LESS THAN 2
MILLIAMPS CURRENT LEAKAGE @ SIGNAL: 2500VOLTS AC,
POWER: 6000 VOLTS AC.
2.5 DEGREE OF PROTECTION: IP67 (MATED CONDITION)
2.6 DEGREE OF POLLUTION: 3 PER UL840
2.7 OVERVOLTAGE CATEGORY: III PER UL840
2.8 MATING CYCLE DURABILITY: >500 CYCLES
2.9 RoHS COMPLIANT

3. ALL DIMENSIONS ARE FOR REFERENCE USE ONLY.

| | | | | | |
|---------------------------------------|--|--|--|-------------|--|
| | | SEE PART NUMBER CHART | | | |
| QUANTITY | | PART NUMBER | | DESCRIPTION | |
| ITEM | | | | | |
| MATERIALS LIST | | | | | |
| UNLESS OTHERWISE SPECIFIED | | SIGNATURES | | DATE | |
| 1) All dimensions are in millimeters. | | DRAWN: Hm | | 06/12/2015 | |
| 2) Tolerances are as follows: | | CHECKED: | | | |
| 1 PL DEC 20.30 | | FRACTIONS: 1/16" | | | |
| 3 PL DEC 20.08 | | ANGLES: 1° | | | |
| 3) Note reference = | | ENGINEER: | | | |
| △ | | APPROVAL: | | | |
| MATERIAL SPECIFICATIONS: | | CUSTOMER: | | | |
| PROCESS SPECIFICATIONS: | | THIS DRAWING IS SUBMITTED FOR YOUR INFORMATION ONLY. DESIGN FEATURES, SPECIFICATIONS AND PERFORMANCE DATA ARE THE PROPERTY OF AMPHENOL CORPORATION. NO PARTS OR REPRODUCTIONS OF THIS DRAWING OR REPRODUCTION ARE ALLOWED. ALL MANUFACTURING VARIATIONS ARE SUBJECT TO NORMAL TOLERANCES AND VARIATIONS. | | | |
| NEXT ASSY: | | SCALE: NONE | | | |
| | | SIZE: B | | | |
| | | TYPE: B-C | | | |
| | | DWG NO: MB2CKND900 | | | |
| | | SHEET 1 OF 1 | | | |
| | | REVISION: B3 | | | |

M23B PLUG, STR, 9POS(4+5), CHECKMATE

Amphenol

Sine Systems - www.amphenol-sine.com
44724 Molex Drive
Clinton Township, MI 48036

Amphenol

Shie Systems - www.amphenol-shie.com
44724 Morley Drive
Clinton Township, MI 48036

M23B PLUG,STR.9POS(4+5),CHECKMATE

MB2CKN0900

B3

TITLE: M23B PLUG,STR.9POS(4+5),CHECKMATE

DWG NO.: MB2CKN0900

REV: B3

SH: 1

OF: 1

Mouser Electronics

Authorized Distributor

Click to View Pricing, Inventory, Delivery & Lifecycle Information:

[Amphenol:](#)

[MB2CKN0900](#)