

REVISIONS				
REV	ECO	DESCRIPTION	DATE	BY APPR
B1	-	RELEASE NEW DWG FORMAT	May.10.2014	Drack Tommy
B2	-	UPDATE THE DURABILITY	Jun.27.2015	Drack Tommy
B3	-	UPDATED NUT	Dec.02.2015	Flan Tommy

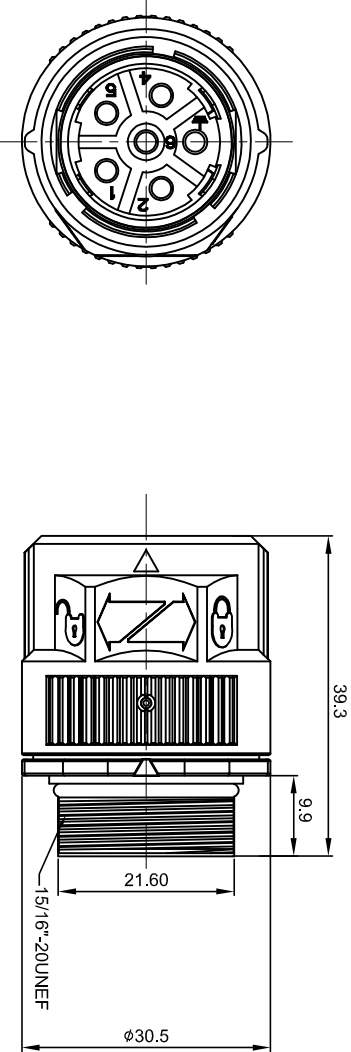

- NOTES: UNLESS OTHERWISE SPECIFIED
- MATERIAL:
INSULATION INSERT: PA66,UL94 V0
SEAL: VITON
HOUSING BODY: ZINC DIE CAST , NICKEL PLATED
COUPLING NUT: ZINC DIE CAST , NICKEL PLATED
 - SPECIFICATIONS:
2.1 CURRENT RATING: 28 AMPS
2.2 VOLTAGE RATING: 630V AC/DC
2.3 OPERATING TEMPERATURE: -20°C TO +130°C
2.4 DIELECTRIC WITHSTANDING VOLTAGE: LESS THAN 2 MILLIAMPS CURRENT LEAKAGE @ 6000 VOLTS AC.
2.5 DEGREE OF PROTECTION: IP67 (MATED CONDITION)
2.6 DEGREE OF POLLUTION: 3 PER UL840
2.7 OVERVOLTAGE CATEGORY: III PER UL840
2.8 MATING CYCLE DURABILITY: >500 CYCLES
2.9 RoHS COMPLIANT

3. ALL DIMENSIONS ARE FOR REFERENCE USE ONLY.

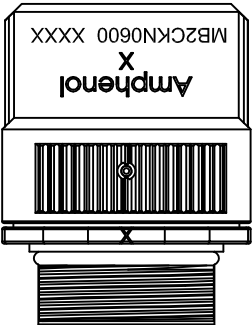
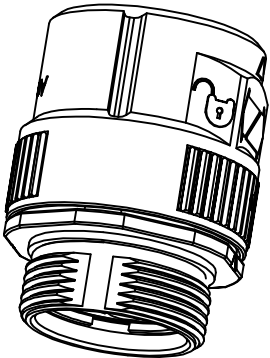

QUANTITY	SEE PART NUMBER CHART	PART NUMBER	DESCRIPTION	ITEM
MATERIALS LIST				
UNLESS OTHERWISE SPECIFIED 1) All dimensions are in millimeters. 2) Tolerances are as follows: 1 Pt. DEC .40 .30 Fractions .1 .104 3 Pt. DEC .40 .08 Angles .1° 3) Note reference =		SIGNATURES	DATE	
		DRAWN: Hm	Dec.02.2015	
		CHECKED:		
		ENGINEER:		
		APPROVAL:		
MATERIAL SPECIFICATIONS:		CUSTOMER:	M23B, PLUG, STR.6POS,CHECKMATE	
PROCESS SPECIFICATIONS:		THIS DRAWING IS SUBMITTED FOR INFORMATION ONLY. DESIGN FEATURES, SPECIFICATIONS AND PERFORMANCE DATA ARE THE PROPERTY OF AMPHENOL CORPORATION. NO PROFITS OF REPRODUCTION ARE LIKELY. ALL MANUFACTURING VARIATIONS.	SIZE: B	TYPE: C-
NEXT ASSY:		SCALE: NONE	DWG NO: MB2CKN0600	REVISION: B3

Amphenol

Shie Systems - www.amphenol-shie.com
44724 Morley Drive
Clinton Township, MI 48036

TITLE:

M23B, PLUG, STR.6POS,CHECKMATE

DWG NO:

MB2CKN0600

REV: B3

SH: 1

OF: 1

Mouser Electronics

Authorized Distributor

Click to View Pricing, Inventory, Delivery & Lifecycle Information:

[Amphenol:](#)

[MB2CKN0600](#)