

PC board drilling dimensions (after plating)

(thickness ≤ 3.20±0.30mm)

Pitch 2.76(shell 25-37)
pitch 2.74(shell 09-15)

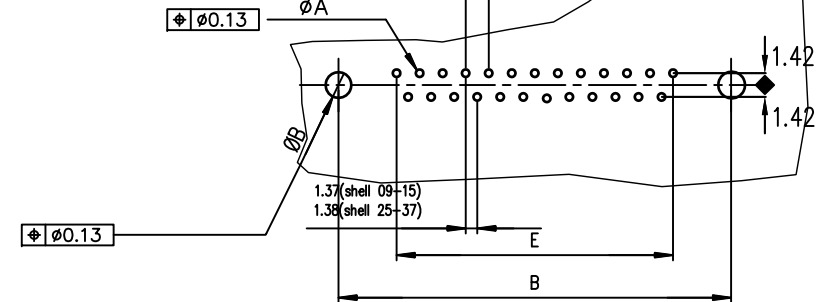

ROHS PART NUMBER

SHELL	A±0.38	B±0.12	C±0.10	D±0.25	E±0.07	200 Matings	500 Matings
09	30.81	24.99	16.96	16.21	10.96	D09S91C4GX00LF	D09S91C6GX00LF
15	39.14	33.32	25.18	24.54	19.18	D15S91C4GX00LF	D15S91C6GX00LF
25	53.03	47.04	39.12	38.25	33.12	D25S91C4GX00LF	D25S91C6GX00LF
37	69.32	63.50	55.68	54.71	49.68	D37S91C4GX00LF	D37S91C6GX00LF

GENERAL CHARACTERISTICS AND ROHS INFORMATIONS:
SEE DRAWING C01-8646-0001

mat'l. code				surface ISO 1302 ✓	tolerance ISO 406 ISO 1101	projection mm	product family D-SUB
ltr	ecn no	dr	date	tolerances unless otherwise specified		scale 2:1	title
K	ELX-I-21654	AB	2015-10-26	angles	linear		FEMALE DELTA-D
L	ELX-I-24020	AAB	2016-06-06	0°±2°	linear		STRAIGHT PRESS FIT
				dr	PESSON 1993-03-18	Amphenol FCi	dwg no
				engr	MITHUN PAUL 2016-06-06		sheet 1 of 1
				chr	ATHUL A.B 2016-06-06		size
				appd	BIJU K PAUL 2016-06-06		A3
sheet index	revision	L					type
	sheet	1					Product Customer Drawing

Mouser Electronics

Authorized Distributor

Click to View Pricing, Inventory, Delivery & Lifecycle Information:

[Amphenol:](#)

[D15S91C6GX00LF](#) [D25S91C6GX00LF](#) [D37S91C6GX00LF](#)