

LEAD FREE PART NUMBER

SHELL	A±0.38	B±0.12	C±0.10	D±0.25	G±0.25	E±0.07	PART NUMBER
09	30.81	24.99	16.96	16.79	5.90	10.96	D09P13A*PV00LF
15	39.14	33.32	25.18	25.12	5.90	19.18	D15P13A*PV00LF
25	53.03	47.04	39.12	38.84	5.70	33.12	D25P13A*PV00LF
37	69.32	63.50	55.68	55.30	5.70	49.68	D37P13A*PV00LF

REQUIREMENTS

Technical characteristics:

Shell: steel tin/Zinc Cr3 plated
 Insulators: self-extinguishing thermoplastic, ULclass94V0
 Contacts size 20: brass, gold on mating end, bright tin on termination end over nickel on entire contact
 Cycles :500 for plating 6
 Cycles :200 for plating 4
 Srewlock: brass, tin plated

Electrical characteristics:

max. current rating: 5A
 Test voltage: 1000V
 Rated voltage: 300V
 Contact resistance: ≤15mΩ
 Shell resistance: ≤5mΩ
 Insulation resistance: ≥5000MΩ

Climatic characteristics:

Operating temperature range: -55°C +125°C

Dimensions:

in accordance with MIL-C-24308

Plating: 4 --> Flash Au
 Plating: 6 --> 0.76μ Au

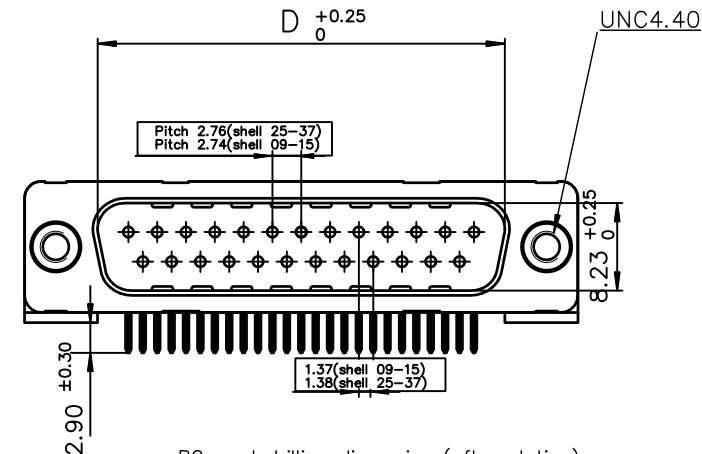
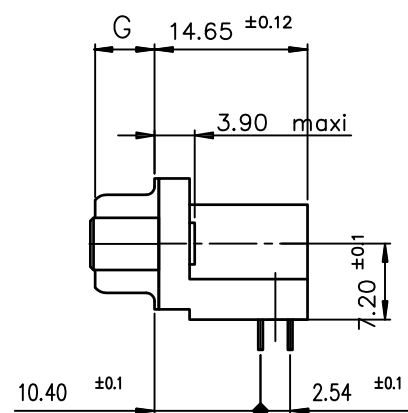

PC card drilling dimensions(after plating)
 (thickness 1.60±0.20mm)

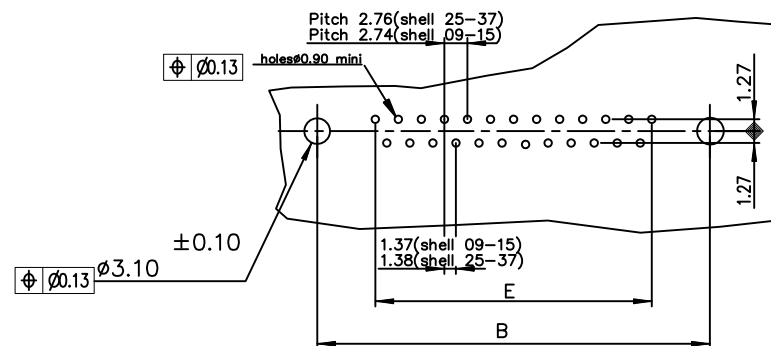

For RoHS Details, Refer Drawing Number C01-8646-0000

mat'l. code				surface			tolerance			projection		product family	
-				ISO 1302			ISO 406			ISO 1101		D-SUB	
Ltr				ecn no			dr			date		title	
D				ELX-I-21807			AB			2015-08-31		DELTA-D MALE RIGHT ANGLE WITH FEMALE SCREW	
												dwg no	
												sheet 1 of 1	
												size	
												A3	
												type	
												Product Customer Drawing	
sheet				revision			D						
index				sheet			1						

Mouser Electronics

Authorized Distributor

Click to View Pricing, Inventory, Delivery & Lifecycle Information:

[Amphenol:](#)

[D15P13A6PV00LF](#) [D37P13A4PV00LF](#)