

PC card drilling dimensions(after plating)
(thickness 1.60 \pm 0.20mm)

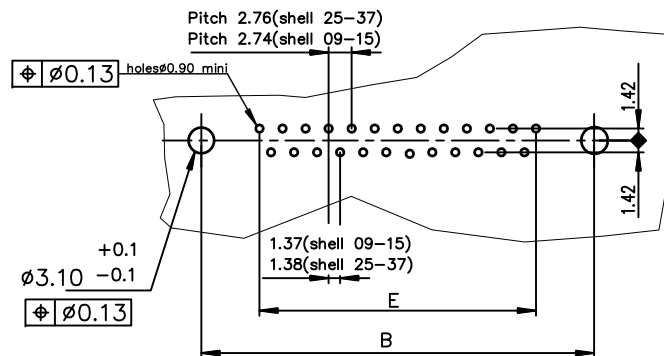

GENERAL CHARACTERISTICS : SEE DRAWING C01-8646-0000

LEAD FREE PART NUMBER

SHELL	A ± 0.38	B ± 0.12	C ± 0.10	D ± 0.25	E ± 0.07	G ± 0.25	PART NUMBER	PART NUMBER
09	30.81	24.99	16.96	16.79	10.96	5.90	D09P33E4U*00LF	D09P33E6U*00LF
15	39.14	33.32	25.18	25.12	19.18	5.90	D15P33E4U*00LF	D15P33E6U*00LF
25	53.03	47.04	39.12	38.84	33.12	5.70	D25P33E4U*00LF	D25P33E6U*00LF
37	69.32	63.50	55.68	55.30	49.68	5.70	D37P33E4U*00LF	D37P33E6U*00LF

200 Mating 500 Mating

X--> ϕT = UNC 4-40
L--> ϕT = M3

mat'l. code				surface	tolerance	projection	product family	
-				ISO 1302	ISO 406 ISO 1101		D-SUB	
ltr	ecn no	dr	date	tolerances unless otherwise specified		MM	title	
D	ELX-I-21045	AB	2015/06/04	angles	linear		MALE DELTA-D RIGHT ANGLE	
				0 \pm 2'	.000 \pm 0.1		WITH NUT & METAL PLATE	
				dr	JOHN SLEEBA 2003/12/27	FCI	dwg no	sheet 1 of 1
				enr	ALIAS BABU 2015/06/04		C01-8646-0851	
				chr	MITHUN PAUL 2015/06/04		A3	
				appd	BIJU K PAUL 2015/06/04		type Product Customer Drawing	
sheet index	revision	D						
	sheet	1						

Mouser Electronics

Authorized Distributor

Click to View Pricing, Inventory, Delivery & Lifecycle Information:

[FCI / Amphenol:](#)

[D09P33E6UX00LF](#)