

A

B

C

D

1

213

4

;

6

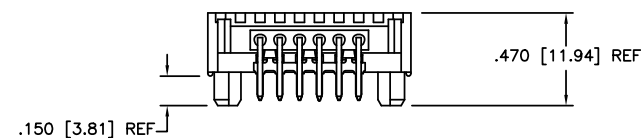
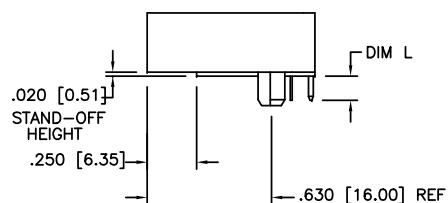
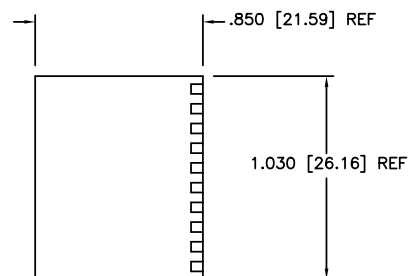

mat'l. code				surface ISO 1302 ✓		tolerance ISO 406 ISO 1101		projection 		product family LATCH-N-LOK						
ltr		ecn nodr		date		tolerances unless otherwise specified						title				
J	BLX-N-008454		ZK	11/29/11		angles		linea		XXXX±.01/0.X±0.3 XXXX±.005/0.XXX±0.13 XXXX±.0020/0.XXXX±0.05		INCH/MM		1X6 LNL RIGHT ANGLE HEADER ASSEMBLY		
D	M04-0230		MHT	12/8/04		0°±2'				scale 1:1						
E	M05-0052		ERE	03/19/05		dr	J. LINN		7/17/90				dwg no		sheet 1 of 2	size
F	M06-0285		AGS	7/28/06		engr	D. HORCHLER		7/17/90				78304		A3	
G	M06-0365		AGS	9/20/06		chr	D. HORCHLER		7/17/90							
H	M09-0048		MHT	3/12/09		appd	D. HORCHLER		7/17/90							
sheet		revision		J J								type		Product	Customer	Drawing
index		sheet		1 2												

78304-XXXXLF

LEAD FREE OPTION ⑥ ⑦

COLOR ④		
1	70343 -LT- GRAY	OBS
2	80166 OFF WHITE	
3	70634 -DK- GRAY	OBS
4	701 BLACK	
5	70541 -SLATE- GRAY	OBS
7	70455 SILVER GRAY	
8	80189 -PEARL- WHITE	OBS
9	70419 PEBBLE GRAY	

PLATING ③		
0	30u" MIN OVER 50u"MIN Ni	
3	30u" MIN OVER 50u"MIN Ni	
5	50u" MIN OVER 50u"MIN Ni	

PIN LENGTH	
	DIM L
0	.150/3.18
1	.110/2.79

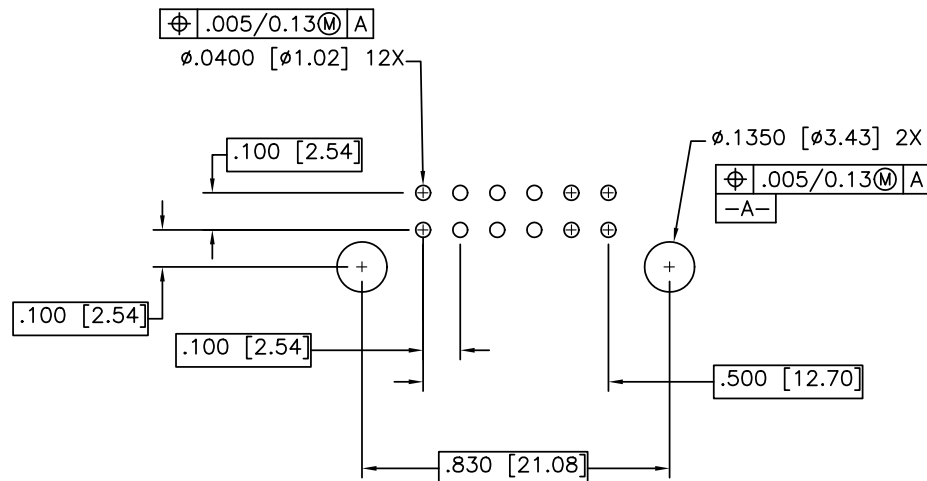

RECOMMENDED PCB LAYOUT

NOTES:

- HEADER SHROUD MATERIAL: HIG TEMPERATURE THERMOPLASTIC, UL-94-0 RATED.
- GROUND CONTACT  
MATERIAL: COPPER ALLOY  
PLATING: 100-160u"/2.54-4.06 TIN.
- ③. SIGNAL CONTACT  
MATERIAL: COPPER ALLOY  
PLATING: PERFORMANCE PLATING WILL BE EITHER GOLD OR GXT  
ON CONTACT AREA OR TAIL, OPTIONALLY (78-295u") TIN ON TAIL.
- ④. NUMBERS SHOWN ARE FOR G.E. LEXAN AND  
ARE FOR REFERENCE ONLY
- THIS ASSEMBLY U.L. APPROVED PER FILE E66906 VOL. 1,  
SEC. 84 AND CSA APPROVED PER MASTER FILE LR 46923.
- ⑥. ADD LF SUFFIX AT THE END OF PART NUMBER FOR LEAD FREE OPTION.
- THE HOUSING WILL WITHSTAND EXPOSURE TO 260°C PEAK TEMPERATURE  
FOR 15 SECONDS IN A WAVE SOLDER APPLICATION WITH A 1.5mm  
MINIMUM THICK CIRCUIT BOARD. SEE APPLICATION NOTES/PROCEDURES  
IF THEY ARE AVAILABLE.
- THIS PRODUCT MEETS EUROPEAN UNION DIRECTIVES AND OTHER  
COUNTRY REGULATION AS DESCRIBED IN GS-22-008.
- PRODUCT SPEC: GS-12-003

mat'l. code	surface ISO 1302 ✓	tolerance ISO 406 ISO 1101	projection INCH/MM	product family LATCH-N-LOK
ltr ecn nodr date	tolerances unless otherwise specified			title
J	angles 0°±2'	linea XXX±.01/0.X±0.3 XXX±.005/0.XX±0.13 XXXX±.0020/0.XXX±0.05	scale 2:1	1X6 LNL RIGHT ANGLE HEADER ASSEMBLY
dr	J. LINN	7/17/90	FCI	dwg no sheet 2 of 2 size
engr	D. HORCHLER	7/17/90		78304 A3
chr	D. HORCHLER	7/17/90		
app	D. HORCHLER	7/17/90		type Product Customer Drawing
sheet index	revision sheet			

# Mouser Electronics

Authorized Distributor

Click to View Pricing, Inventory, Delivery & Lifecycle Information:

[FCI / Amphenol:](#)

[78304-002](#) [78304-007](#) [78304-009](#) [78304-107](#) [78304-102LF](#)