

DIMENSIONS

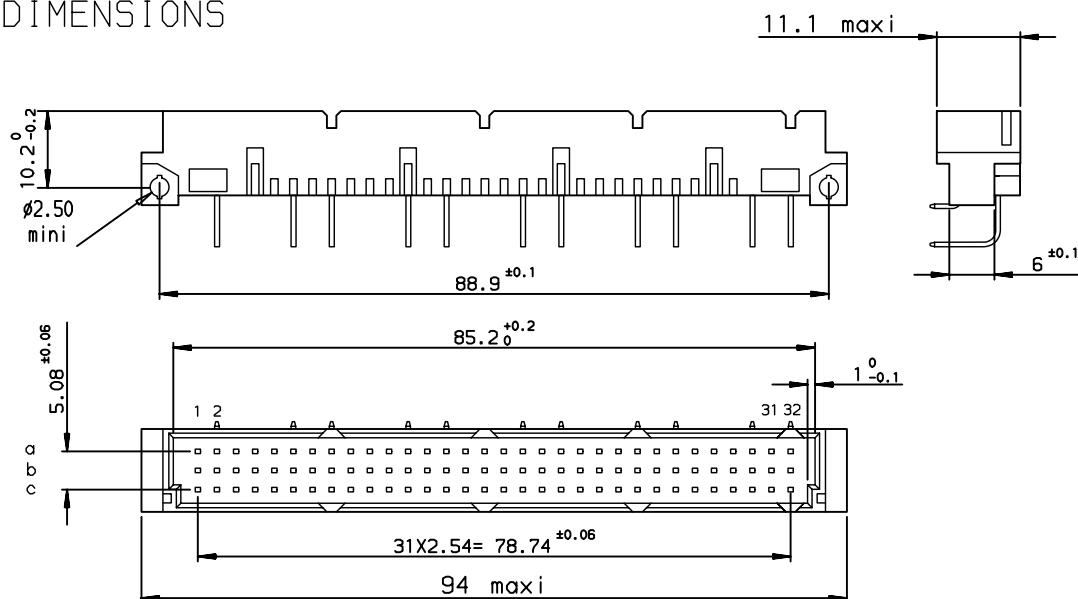

TIN LEAD PART NUMBER

PART NUMBER

86094227113750324E1

LEAD FREE PART NUMBER

PART NUMBER

86094227113750DKLF

TERMINATION

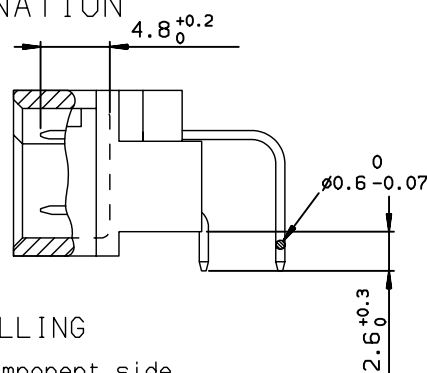

SPECIFICATION 324 or DKLF =

contacts in position :

row : a-c cavity : 2-6-8-12-14-18-20-24-26-30-32

GENERAL CHARACTERISTICS AND ROHS INFORMATIONS:

SEE DRAWING C-8609-0000A

PCB DRILLING

component side

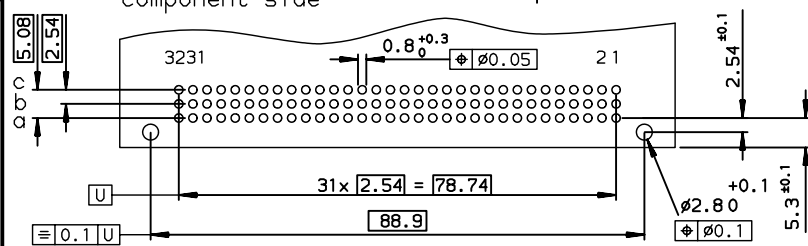

rev	ecn no	dr	date
A	-	-	1997/09/26
B	LS06-0208	LGO	2006/12/16
C	LS07-0025	HLE	2007/01/26
-	-	-	-
-	-	-	-
-	-	-	-

www.fciconnect.com			surface ISO 1302	tolerance std ISO 406 ISO 1101	projection A3	mm
			TOLERANCES UNLESS OTHERWISE SPECIFIED			
Dr	ROUILLARD	1997/09/26	ANGULAR	0.X	±0.1	size
Eng	ROUILLARD	1997/09/26	LINEAR	0.XX	±0.1	A3
Chr	P.LEGARE	1997/09/26		0.XXX	±0.1	Scale 1.5
Appr	P.LEGARE	1997/09/26	Product family			ECN
			DIN STD			LS07-0025
			Spec ref			-
FCJ			title			Rev.
			STANDARD MALE 3 ROW			C
			22 CONTACTS			
			catalog no			
			See table			
			CUSTOMER			sheet 1 of 1

Mouser Electronics

Authorized Distributor

Click to View Pricing, Inventory, Delivery & Lifecycle Information:

[FCI / Amphenol:](#)

[86094227113750DKLF](#)