

Part No. & Date code Printing

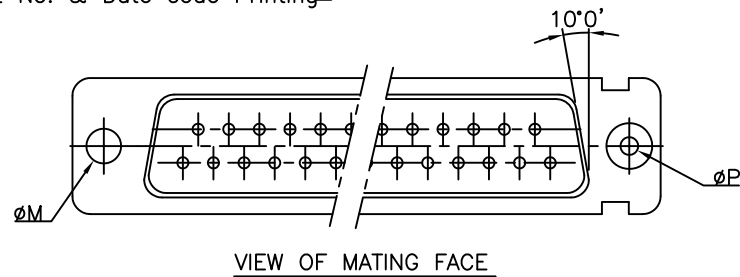

ORDERING INFORMATION

SERIES	D B P V 25 P 0 64 C T X XXX LF	LEAD FREE
SHELL SIZE E,A,B,C,D		APPLICABLE ONLY FOR DP SERIES
CHARECTERISATION M-DM SERIES P-DP SERIES		SPECIAL CODE
OPTIONS BLANK-STANDARD F-FLOAT MOUNTING (Only for DM) L-CLINCH NUT (M3) O-CLINCH NUT (UNC) V-FEM. SCREW LOCK HEX. (UNC) (Only for DP) N-THR FEM. SCREW LOCK M3		DIMPLES - OPTIONAL X-ON MALE DP CONNECTORS ONLY
NO.OF CONTACTS 09,15,25,37,50		SHELL PLATING BLANK-ZINC for DP/CADMIUM for DM T-STD (Only for DP). TIN over Cu or Zinc Cr 3
CONTACTS P - PIN S - SOCKET		OPTIONS BLANK-STANDARD H-SHIELDING TERMINATION FINGERS (Only for DP) N- OBLIGATORY FOR DM
TERMINATION TYPE O-SOLDER BUCKET		CONTACT PLATING 32 - 1.27µ Au (Code 32 APPLICABLE FOR DM SERIES ONLY)

"This LF product meets European Union Directives and other country regulations as described in GS-22-008"

Packaging as per GS-14-920

WITH SHIELDING TERMINATION FINGERS

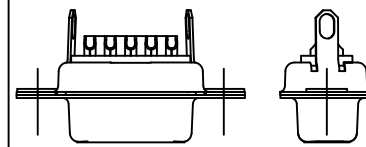

OPTION: H

MALE LEVER LOCK

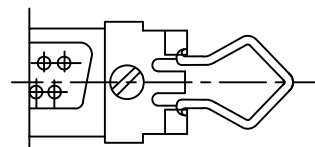
ORD CODE 8630-3427(EABC)
" 8630-3428(D)

FEMALE LEVER LOCK

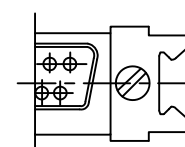
ORD CODE 8630-3425(EABC)
" 8630-3426(D)

FEMALE SCREW LOCK

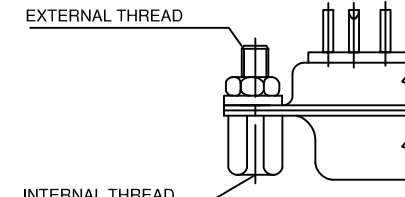

8630-01	M3	M3
8630-01A	M3	4-40 UNC 2
8630-01B	4-40 UNC 2A	4-40 UNC 2B
ORD-CODE	EXTERNAL THREAD	INTERNAL THREAD

FEMALE SCREW LOCK EXTEND TYPE

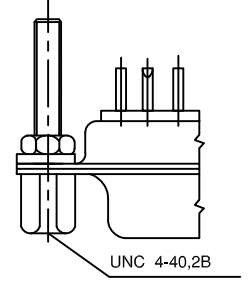

ORD CODE 8630-01-061

TECHNICAL SPECIFICATIONS

SHELLS	: TIN/CADMIUM/ZINC PLATED STEEL
INSULATOR MATERIAL	: SELF EXTINGUISHING THERMOPLASTIC- TO UL CLASS 94 V0 HOUSING WILL WITHSTAND EXPOSURE TO 260-265°C IF USE PROTECTIVE ADHESIVE (type Kapton or Teflon) OR PROTECTIVE METALLIC DEVICE
CONTACT DIA ON ACTIVE AREA:	Ø1 MM.
CONTACTS MATERIAL	: COPPER ALLOY
CONTACT PLATING	: GXT / GOLD OVER NICKEL
OPERATING TEMPERATURE	: -55°C +125°C
OPERATING CURRENT	: 7.5 A PER CONTACT
CONTACT RESISTANCE	: ≤7.3 mΩ
INSULATION RESISTANCE	: ≥5000 MΩ
MAXIMUM VOLTAGE	: 1000 V.r.m.s
MECHANICAL ENDURANCE	: 500 MATINGS FOR CODE 65 : 200 MATINGS FOR CODE 64
DAMP HEAT	: 56 DAYS FOR CODE 65 : 21 DAYS FOR CODE 64

mat'l. code SEE NOTE 4				surface ISO 1302 ✓	tolerance ISO 406 ISO 1101	projection MM	product family D-SUB			
ltr	ecn no	dr	date	tolerances unless otherwise specified		MM	title D-SUB S/B CONNECTOR (DP & DM SERIES WITH ASSEMBLY OPTIONS)			
G	i06-074	GVJ	2006-06-08	angles	linear					
H	I08-0047	MRA	2008-03-25							
J	I09-0078	MRA	2009-05-15							
K	I09-0111	MRA	2009-06-23	dr	Mini K Vandanaath	1999-03-20	FCI	dwg no		sheet 1 of 1
L	I09-0288	MRA	2009-12-23	enr	George V Joseph	1999-03-20		C-DSUB-0068		size A3
M	I11-0003	MRA	2011-01-06	chr	Abhilash M R	2009-05-15				
				appd	Sudhir Varma	2009-05-15		type		Product Customer Drawing
sheet index		revision sheet	M 1							

Mouser Electronics

Authorized Distributor

Click to View Pricing, Inventory, Delivery & Lifecycle Information:

FCI / Amphenol:

[DAP15S064TLF](#) [DEP09P065TXLF](#) [DEP09S064TLF](#) [DAP15P064TXLF](#) [DAP15P065TXLF](#) [DAP15S065TLF](#)
[DBP25P065TXLF](#) [DBP25S064TLF](#) [DBP25S065TLF](#) [DCP37P064TXLF](#) [DCP37P065TXLF](#) [DCP37S064TLF](#)
[DCP37S065TLF](#) [DDP50P064TXLF](#) [DDP50P065TXLF](#) [DEP09P064TXLF](#) [DEP09S065TLF](#) [DBPV25S064TLF](#)
[DBP25P064TXLF](#) [DDP50S064TLF](#) [DAPL15S065TLF](#) [DAP15S065HTLF](#) [DBM25S032N](#) [DEPV09P065TXLF](#)
[DEM09S032N](#) [DEMF09S032N](#) [DDM50S032N](#) [DEPO09P065TXLF](#) [DDP50S065TLF](#) [DCMF37S032N](#)
[DDMF50S032N](#) [DAMF15S032N](#)