

# DIMENSIONS

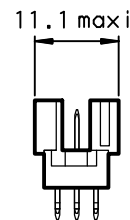

# TERMINATION

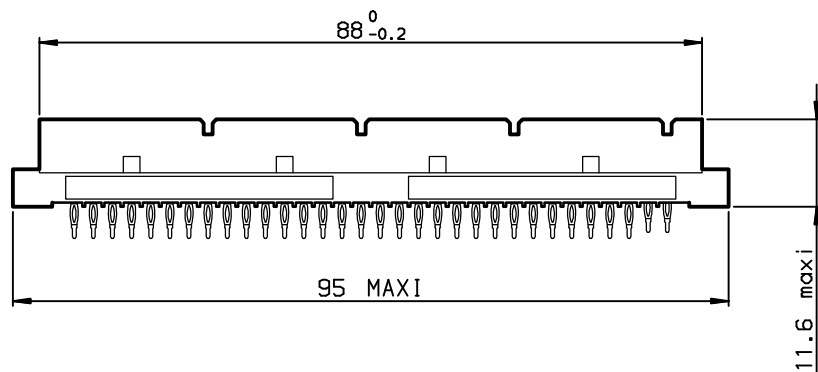
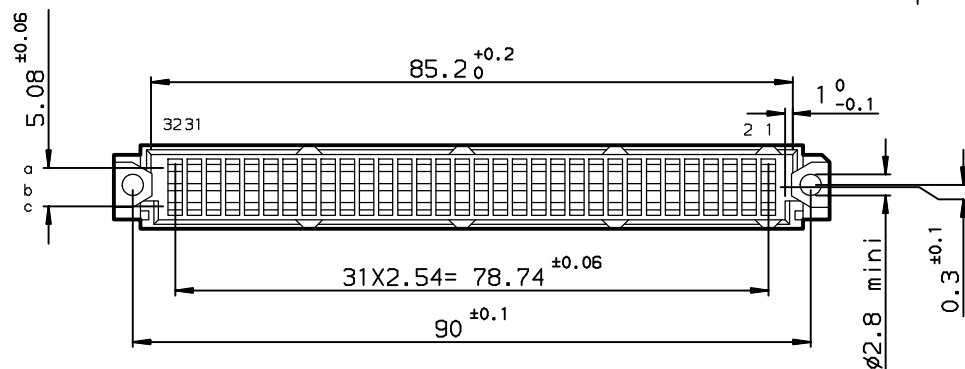
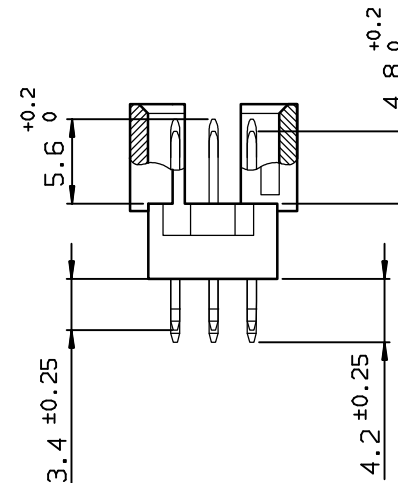

## P.C. CARD DRILLING (Component side view)

See drawing ref. C-8609-0000

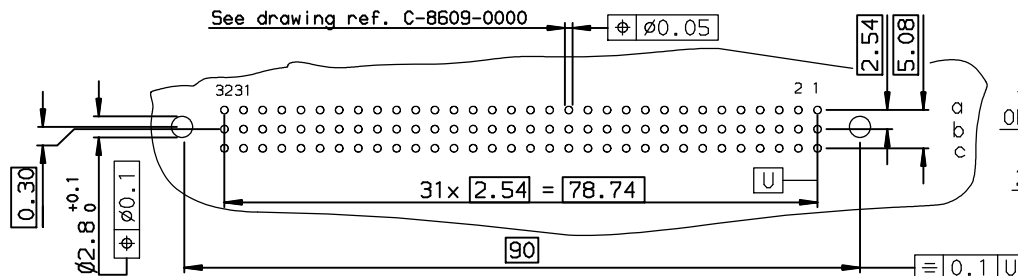

TIN LEAD PART NUMBER

PART NUMBER

86093967894755875E1

LEAD FREE PART NUMBER

PART NUMBER

86093967894755CALF

SPECIFICATION 875 = No standard mounting length in row a-b-c cavities 1 and 2 :  
OR SPECIFICATION CA = 6 contacts more inserted in housing = termination 3.4 mm  
and mating length 5.6 mm

25% rebroye maxi

European Views

GENERAL CHARACTERISTICS AND ROHS INFORMATIONS:

SEE DRAWING C-8609-0000C

rev	ecn no	dr	date
C	-	-	2005/01/06
D	LS05-004	JTA	2005/02/26
E	LS06-0095	LGO	2006/06/28
-	-	-	-
-	-	-	-
-	-	-	-
-	-	-	-

www.fciconnect.com			surface ISO 1302	tolerance std ISO 406 ISO 1101	projection mm	size A3		Scale 1.5
TOLERANCES UNLESS OTHERWISE SPECIFIED			ANGULAR	LINEAR	0.X ±0.1	ECN		LS06-0095
Dr ROUILLARD			0.XX ±0.1	0.XXX ±0.1	0.XX ±0.1	Spec ref		-
Eng TARON			Product family		DIN 8609		Rev.	
Chr LEGARE			title		C-8609-1117		E	
Appr LEGARE			96 CONTACTS		C-8609-1117		E	
FCI			catalog no		CUSTOMER		sheet 1 of 1	

# Mouser Electronics

Authorized Distributor

Click to View Pricing, Inventory, Delivery & Lifecycle Information:

[FCI / Amphenol:](#)  
[86093967894755CALF](#)