

10069525 -

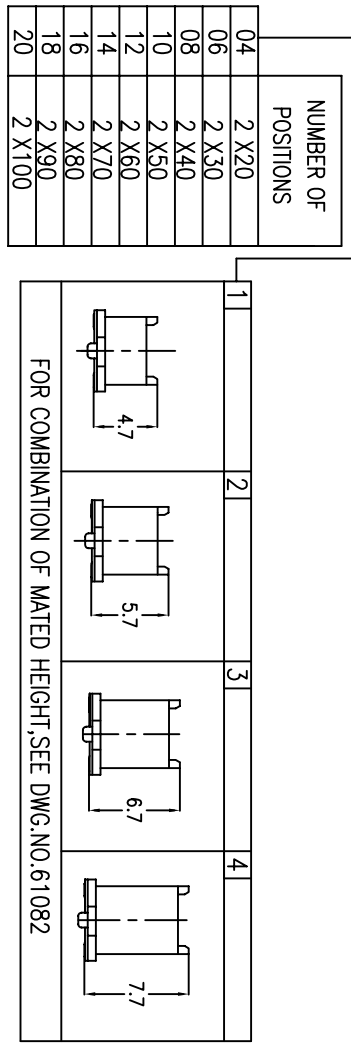

PACKAGING	
0	TUBE WITHOUT CAP
2	TAPE & REEL WITH CAP
9	TUBE WITH CAP

POLARIZATION PEG		HOLD DOWN	
0	YES		NO
2	NO		NO

PLATING ON CONTACT AREA.		PLATING ON SOLDER TAIL	
0	GOLD 0.2 um MIN. / TIN LEAD SOLDER	EMPTY	EMPTY
1	PALLADIUM-NICKEL 0.76 umMIN. WITH GOLD FLASH (0.1 um MIN.) / TIN LEAD SOLDER	EMPTY	EMPTY
4	GOLD 0.2 um MIN. / MATT PURE TIN ON SOLDER TAIL (LEAD FREE PLATING)	LF (note 6&8.)	LF (note 6.)
5	GOLD 0.38 um / MATT PURE TIN ON SOLDER TAIL (LEAD FREE PLATING)	LF (note 6.)	LF (note 6.)
6	PALLADIUM-NICKEL 0.76 umMIN. WITH GOLD FLASH (0.1 um MIN.) / MATT PURE TIN ON SOLDER TAIL (LEAD FREE PLATING)	LF (note 6&8.)	LF (note 6.)

- NOTES:
- MATERIAL:
HOUSING: G.F.LCP UL94V-0
TERMINAL: BRASS
 - PLATING:
AS TABLE SHOW.
 - SEE GS-12-148 FOR PRODUCT SPECIFICATION.
 - SEE GS-14-551 AND GS-14-816 FOR PACKAGING SPECIFICATION.
 - PACKING OPTION 3: "CUSTOMER-SPECIFIC; LIMITED TO CERTAIN SIZES" PACKING OPTION 2: NOT ALL SIZES AVAILABLE; CHECK WITH FACTORY"
 - THIS PRODUCT MEETS EUROPEAN UNION DIRECTIVES AND OTHER COUNTRY REGULATIONS AS DESCRIBED IN GS-22-008
 - THE HOUSING WILL WITHSTAND EXPOSURE TO 260°C PEAK TEMPERATURE FOR 10 SECONDS IN A CONVECTION, INFRA-RED OR VAPOR PHASE REFLOW OVEN.
 - PLATING OPTION '4' IS LEADFREE ALTERNATIVE FOR OPTION '0', AND OPTION '6' IS LEADFREE ALTERNATIVE FOR OPTION '1'.

- THIS PARTNUMBER IS ONLY CATER FOR SPECIAL CUSTOMER REQUIREMENTS OF COPLANARITY OF 0.1 FOR ALL POSITIONS.
- A Δ SYMBOL WILL BE NEXT TO ANY DIMENSION, VIEW, OR NOTE WHICH HAS BEEN MODIFIED WITH THE CURRENT DRAWING REVISION.

mat'l. code		surface		tolerance		projection		product family	
ltr	ecrn no	dr	date	ASMEY14.5	ASME Y14.5	mm	mm	title	sheet no
A	S06-0286	MCH	2006-08-25	angles	.XX±0.20			0.8mm BOARD TO BOARD	sheet 1 of 6
B	S06-0316	MCH	2006-08-25	°±2'	.XXX±0.15			PLUG ASS'y	A4
C	S09-0216	MCH	2009-06-26	°±2'	.XXX±0.10				
D	S10-0089	MCH	2010-03-26	dr	M.CHEONG	2006-08-25	scale 3:1		
				enjr	M.CHEONG	2006-08-25			
				chr	M.CHEONG	2010-03-26			
				pppd	JOEY NG	2010-03-26			
Sheet	revision	D	B	B	B	B	B		
Index	sheet	1	2	3	4	5	6		



PRODUCT NO.	NUMBER OF POSITIONS	DIMENSION		
		A	B	C
10059525-041***	2 X20	15.2	21.8	20.2
10059525-061***	2 X30	23.2	29.8	28.2
10059525-081***	2 X40	31.2	37.8	36.2
10059525-101***	2 X50	39.2	45.8	44.2
10059525-121***	2 X60	47.2	53.8	52.2
10059525-141***	2 X70	55.2	61.8	60.2
10059525-161***	2 X80	63.2	69.8	68.2
10059525-181***	2 X90	71.2	77.8	76.2
10059525-201***	2 X100	79.2	85.8	84.2

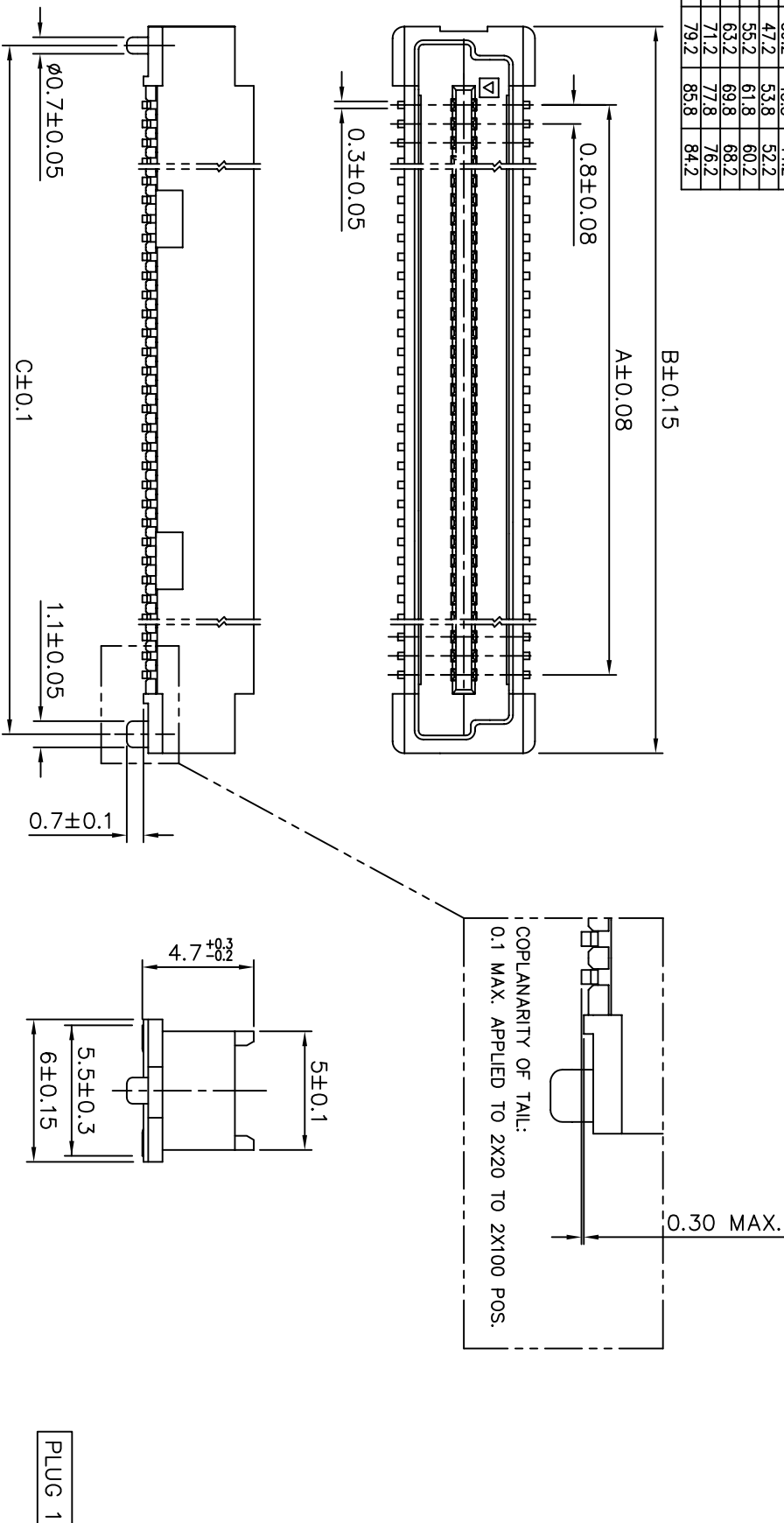

PLUG 1

mat'l. code		surface		tolerance		projection		product family	
ltr	ecrn no	dr	date	ASME Y14.5	ASME Y14.5	MM	FCI	BERGSTAK	title
A	S06-0286 MCH	2006-08-25	2006-08-25	ASME Y14.5	ASME Y14.5	MM	FCI	BERGSTAK	0.8mm BOARD TO BOARD PLUG ASS'Y
B	S06-0316 MCH	2006-08-25	2006-08-25	ASME Y14.5	ASME Y14.5	MM	FCI	BERGSTAK	0.8mm BOARD TO BOARD PLUG ASS'Y
sheet index		revision	sheet	scale 3:1		dwg no		sheet 2 of 6	size
-		-	-	3:1		10069525		A4	A4
-		-	-	3:1		CUSTOMER Drawing			

PRODUCT NO.	NUMBER OF POSITIONS	DIMENSION		
		A	B	C
10069525-042***	2 X20	15.2	21.8	20.2
10069525-062***	2 X30	23.2	29.8	28.2
10069525-082***	2 X40	31.2	37.8	36.2
10069525-102***	2 X50	39.2	45.8	44.2
10069525-122***	2 X60	47.2	53.8	52.2
10069525-142***	2 X70	55.2	61.8	60.2
10069525-162***	2 X80	63.2	69.8	68.2
10069525-182***	2 X90	71.2	77.8	76.2
10069525-202***	2 X100	79.2	85.8	84.2

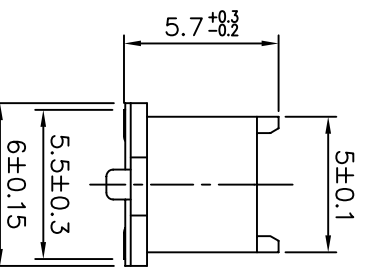
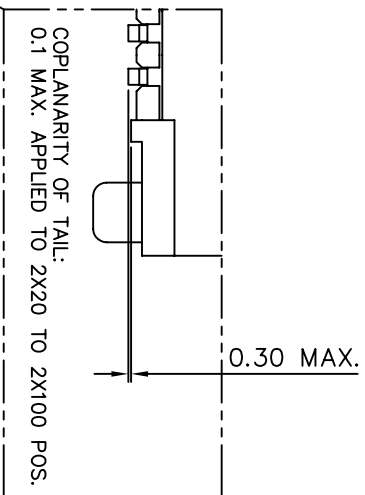
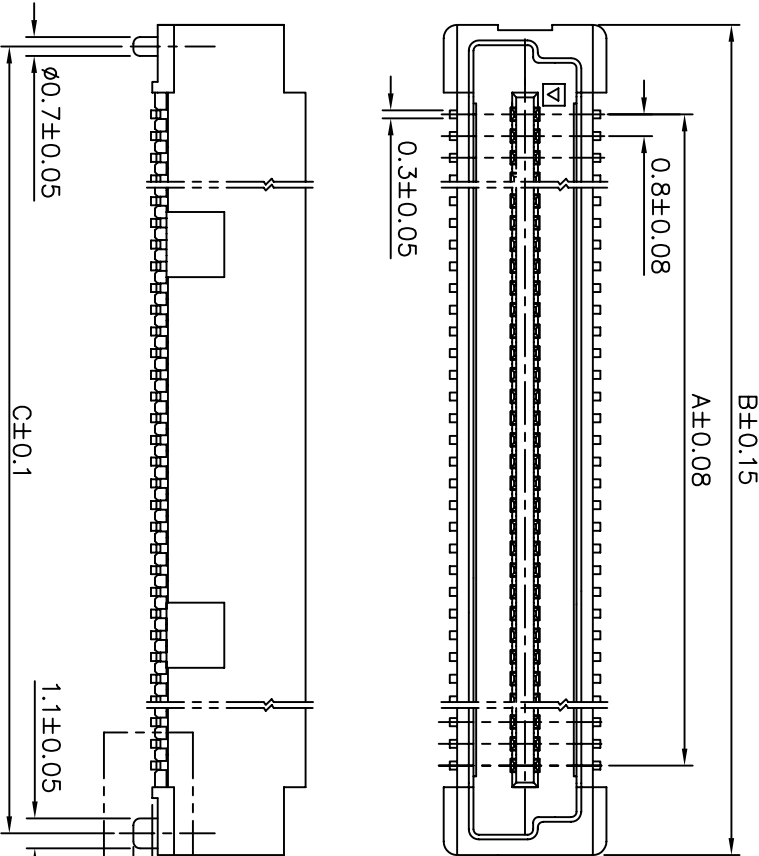

PLUG 2

mat'l. code		surface		tolerance		projection		product family	
ltr	ecrn no	dr	date	ASMEY14.5	ASME Y14.5	MM	FCI	BERGSTAK	title
A	S06-0286	MCH	2006-08-25	angles	.XX±0.20	MM	FCI	BERGSTAK	0.8mm BOARD TO BOARD
B	S06-0316	MCH	2006-08-25	0°±2'	.XX±0.15	MM	FCI	BERGSTAK	PLUG ASS'Y
					.XXX±0.10	scale 3:1			
				dr	M.CHEONG	2006-08-25			
				enjr	M.CHEONG	2006-08-25			
				chr	M.CHEONG	2006-08-25			
				appd	JOEY NG	2006-08-25			
sheet	revision								dwg no
index	sheet								10069525
									sheet 3 of 6
									A4
									CUSTOMER Drawing



PRODUCT NO.	NUMBER OF POSITIONS	DIMENSION		
		A	B	C
10069525-043***	2 X20	15.2	21.8	20.2
10069525-063***	2 X30	23.2	29.8	28.2
10069525-083***	2 X40	31.2	37.8	36.2
10069525-103***	2 X50	39.2	45.8	44.2
10069525-123***	2 X60	47.2	53.8	52.2
10069625-143***	2 X70	55.2	61.8	60.2
10069525-163***	2 X80	63.2	69.8	68.2
10069525-183***	2 X90	71.2	77.8	76.2
10069525-203***	2 X100	79.2	85.8	84.2

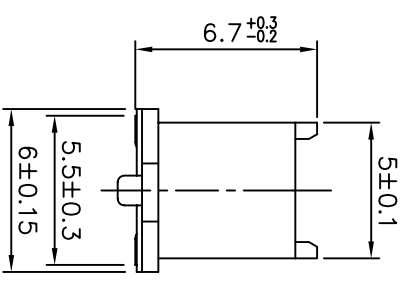
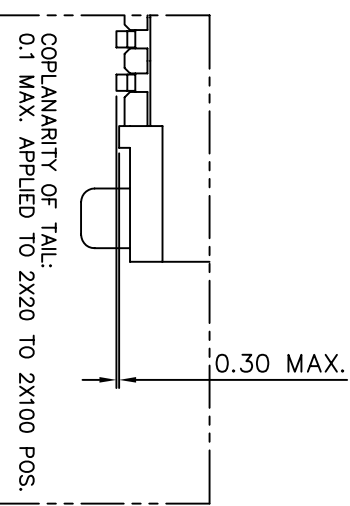
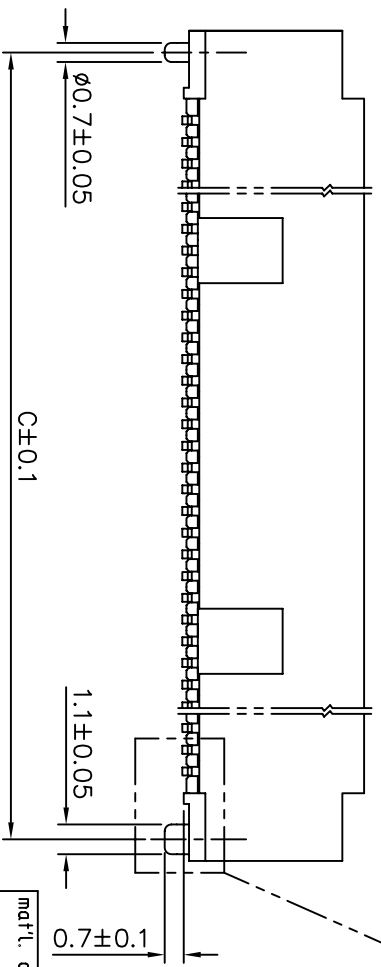
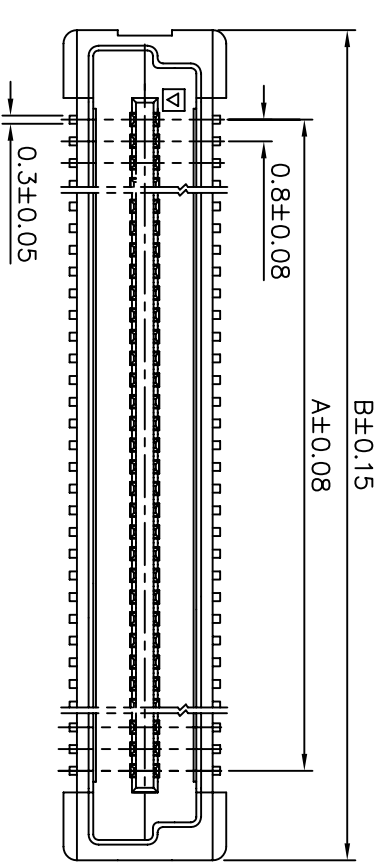

PLUG 3

ltr	ecm no	dr	date	surface	tol	tol unless otherwise specified	projection	product family	title
A	S06-0286	MCH	2006-08-25	ASMEY14.5	ASME Y14.5		MM	BERGSTAK	0.8mm BOARD TO BOARD
B	S06-0316	MCH	2006-08-25				scale 3:1		PLUG ASS'y
mat'l. code		-		ASMEY14.5		ASME Y14.5		-	
sheet index		revision		sheet		sheet		sheet	



PRODUCT NO.	NUMBER OF POSITIONS	DIMENSION		
		A	B	C
10069525-044***	2 X20	15.2	21.8	20.2
10069525-064***	2 X30	23.2	29.8	28.2
10069525-084***	2 X40	31.2	37.8	36.2
10069525-104***	2 X50	39.2	45.8	44.2
10069525-124***	2 X60	47.2	53.8	52.2
10069525-144***	2 X70	55.2	61.8	60.2
10069525-164***	2 X80	63.2	69.8	68.2
10069525-184***	2 X90	71.2	77.8	76.2
10069525-204***	2 X100	79.2	85.8	84.2

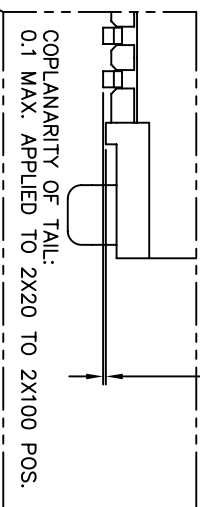
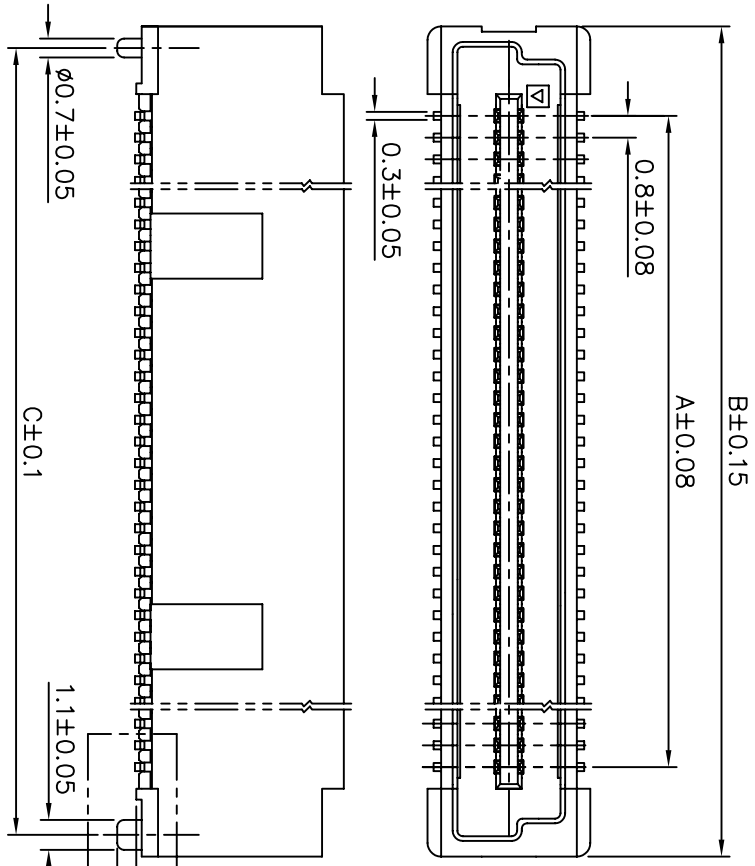

PLUG 4

form: AdmmXlc 1 2 3 4 5

mat'l. code		surface		tolerance		projection		product family	
ltr	ecrn no	dr	date	ASMEY14.5	ASME Y14.5	MM	FCI	BERGSTAK	title
A	S06-0286	MCH	2006-08-25	angles	.XX±0.20	MM	FCI	BERGSTAK	0.8mm BOARD TO BOARD
B	S06-0316	MCH	2006-08-25	∠±2°	.XXX±0.10	MM	FCI	BERGSTAK	PLUG ASS'y
-	-	-	-	dr	M.CHEONG	2006-08-25	FCI	BERGSTAK	sheet 5 of 6
-	-	-	-	enjr	M.CHEONG	2006-08-25	FCI	BERGSTAK	size A4
-	-	-	-	chr	M.CHEONG	2006-08-25	FCI	BERGSTAK	type CUSTOMER Drawing
-	-	-	-	appd	JOEY NG	2006-08-25	FCI	BERGSTAK	
sheet	revision	sheet	sheet						

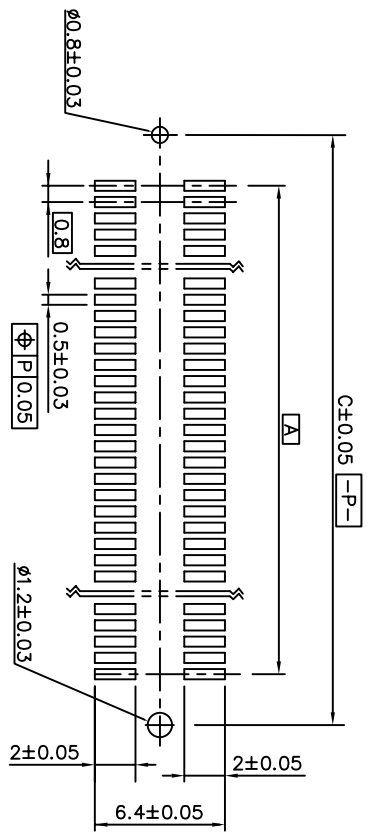

RECOMMENDED PCB LAYOUT WITH PEG
FOR NO. OF POS. 2X20, 2X30, 2X40, 2X50, 2X60

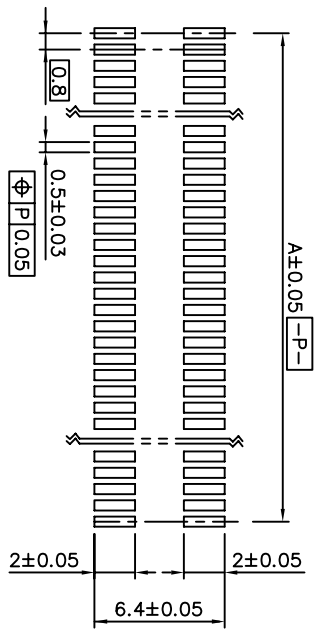

RECOMMENDED PCB LAYOUT WITHOUT PEG AND HOLLOWDOWN
FOR NO. OF POS. 2X20, 2X30, 2X40, 2X50, 2X60

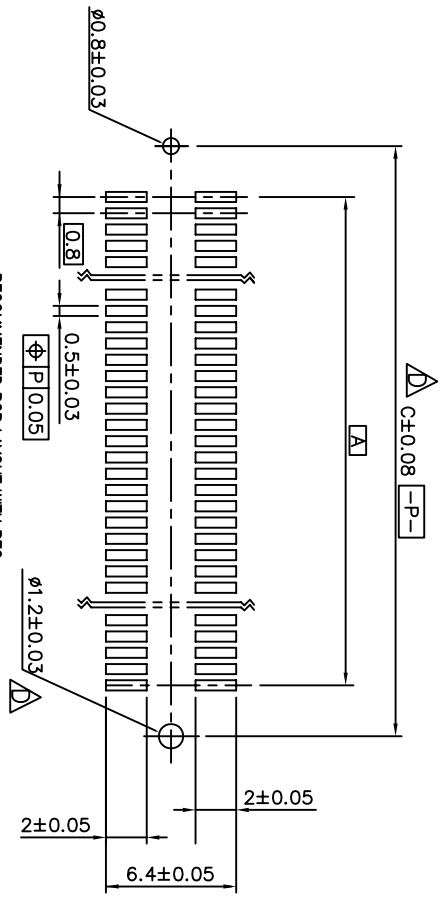

RECOMMENDED PCB LAYOUT WITH PEG
FOR NO. OF POS. 2X70, 2X80, 2X90, 2X100

FOR PLUG 1/2/3/4

mat'l. code	surface	tolerance	projection	product family
	ASMEY14.5Y	ASME Y14.5		BERGSTAK
itr	ecrn no	dr	date	title
A	S06-0286	MCH	2006-08-25	0.8mm BOARD TO BOARD
B	S10-0086	MCH	2010-03-26	PLUG ASS'y
				scale 3:1
				MM
				dwg no
				10069525
				sheet 6 of 6
				size
				A4
				type
				CUSTOMER Drawing
Sheet	revision			
index	sheet			

Mouser Electronics

Authorized Distributor

Click to View Pricing, Inventory, Delivery & Lifecycle Information:

[FCI / Amphenol:](#)

[10069525-084002](#) [10069525-121002](#) [10069525-041402LF](#) [10069525-044002](#) [10069525-104109](#) [10069525-164602LF](#) [10069525-041409LF](#) [10069525-204402LF](#) [10069525-204602LF](#) [10069525-124402LF](#) [10069525-104402LF](#) [10069525-202609LF](#) [10069525-164402LF](#) [10069525-163502LF](#) [10069525-201400LF](#) [10069525-162502LF](#) [10069525-183402LF](#) [10069525-201402LF](#) [10069525-142602LF](#) [10069525-123402LF](#) [10069525-163402LF](#) [10069525-143402LF](#) [10069525-141402LF](#) [10069525-121402LF](#) [10069525-202102](#) [10069525-162402LF](#) [10069525-161402LF](#)