

REV.	DATE	DESCRIPTION
A	06/05/03	UPDATE DRAWING FORMAT

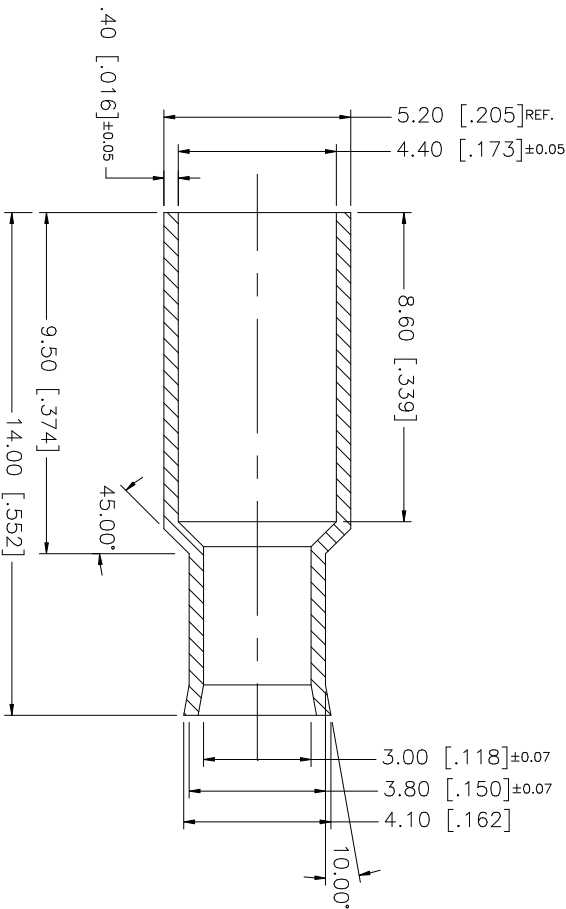

REMARK:
 ROCKWELL HARDNESS OF
 55 MAX. ON 15-T SCALE
 (HEAT TREAT FOR 45 MIN.
 AT 1100°F BEFORE PLATING)

					UNLESS OTHERWISE SPECIFIED DIMENSIONS ARE IN MILLIMETERS. DIMENSIONS IN () ARE IN INCHES AND FOR CUSTOMER REFERENCE ONLY.	APPROVALS	DATE	Amphenol Connex									
8						DRAWN	G.R.S.		06/05/03								
7						UNLESS OTHERWISE SPECIFIED TOLERANCES FOR MILLIMETERS ARE:											
6						0.5 - 8mm ± 0.20mm											
5						8 - 30mm ± 0.40mm											
4					30 - 120mm ± 0.50mm	CHECKED		PART DESCRIPTION FERRULE-174									
3					UNLESS OTHERWISE SPECIFIED TOLERANCES FOR INCHES ARE:												
2					.020 - .315 = ± 0.007"												
1	FERRULE	BRASS	SILVER	1	.315 - 1.180 = ± 0.015"	ISSUED		PART NO. FERRULE-174									
					1.180 - 4.724 = ± 0.020"	SHEET	1 OF 1										
DESCRIPTION					MATERIAL	FINISH	QTY	DO NOT SCALE DRAWING	CAD FILE C:/MISC/FERRULE-174.DWG	DWG. NO.	FERRULE-174.DWG	REV.	A	SIZE	A	SCALE	NA

Amphenol Connex

Mouser Electronics

Authorized Distributor

Click to View Pricing, Inventory, Delivery & Lifecycle Information:

[Amphenol:](#)

[FERRULE-174](#) [FERRULE-316DB](#) [FERRULE-174NEX](#)