

# ELFF SERIES PART NUMBERING SCHEME

REV	ECN	APPD
-	3600	JC 12/11/98
A	4686	IQ 1/2/02
B	4792	IQ 3/11/02
C	4821	IQ 4/9/02
D	5742	2N 12/28/05

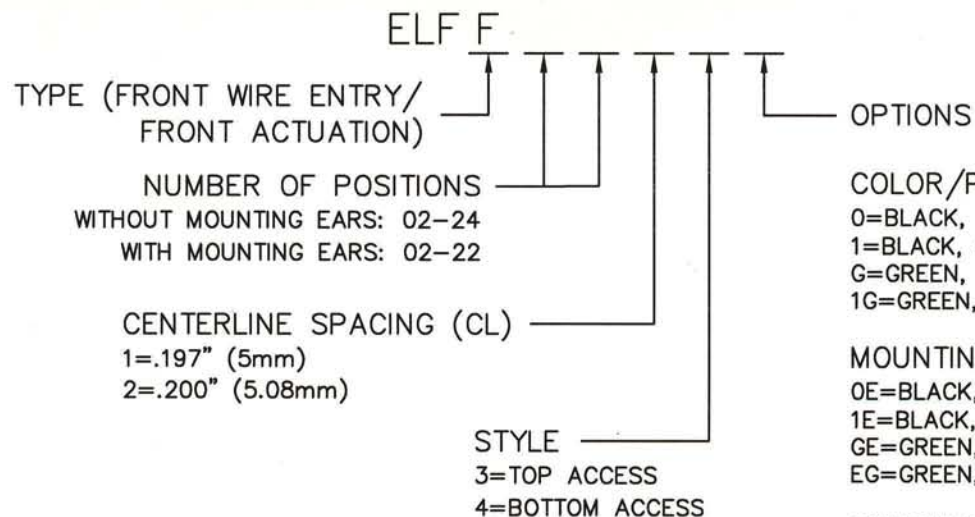

COLOR/PLATING  
0=BLACK, TIN (STANDARD)  
1=BLACK, SELECTIVE GOLD  
G=GREEN, TIN  
1G=GREEN, SEL. GOLD

MOUNTING EARS  
0E=BLACK, TIN  
1E=BLACK, SEL. GOLD  
GE=GREEN, TIN  
EG=GREEN, SEL. GOLD

CONSULT PCD FOR PART NO. AND  
AVAILABILITY OF FOLLOWING OPTIONS:

- \* CUSTOM COLORS
- \* CUSTOM MARKING
- \* CUSTOM KEYING
- \* SELECTIVE CONTACT LOADING



RATINGS

CURRENT - 15A  
VOLTAGE - 300V  
U.L. FILE NO. E83421



RATINGS

CURRENT - 15A  
VOLTAGE - 300V  
CSA FILE NO. LR69703

DIN VDE 0627:1986  
DIN VDE 0110-1:1989  
EN 60947-1:1991  
EN 60947-7-1:1992

CURRENT - 15A  
VOLTAGE - 300V  
TUV FILE NO. 20396

## INSTALLATION RECOMMENDATIONS:

WIRE RANGE: AWG #14-26, STRANDED OR SOLID;  
AWG #12 STRANDED  
WIRE STRIP LENGTH: AWG #14-26: .310" (7.87mm)  
AWG #12: .490" (12.45mm)  
TIGHTENING TORQUE: 7 LB-IN.

## MATERIALS:

HOUSING: PPO, UL 94 V-0  
CONTACT: COPPER ALLOY, OPTIONAL FINISH  
SCREW: STEEL, NICKEL FINISH  
WIRE CLAMP: COPPER ALLOY, NICKEL FINISH

MAX OPERATING TEMPERATURE:  
105°C

## DIMENSIONS

ANSI Y14.5M  
UNITS: INCHES  
ACAD FILE

## TOLERANCES

.XX ±.01  
.XXX ±.005  
ANGLES ±2°

## PROJECTION



## Amphenol Pcd SPECIFICATION DRAWING

ENGR

A. PATRIE 12/4/98

CHKD

APPD

J. CAHALY 12/11/98

## TITLE

ELFF SERIES  
PLUGGABLE TERMINAL BLOCK  
FRONT / FRONT

ORIGINAL  
STAMPED  
IN RED

THIS DOCUMENT CONTAINS  
PROPRIETARY INFORMATION WHICH  
IS THE CONFIDENTIAL PROPERTY  
OF AMPHENOL PCD INC. PEABODY, MA

SIZE

A

DWG NO.

ELFF02130

REV

D

CODE: 58982

SCALE: NONE

SHEET 1 OF 2

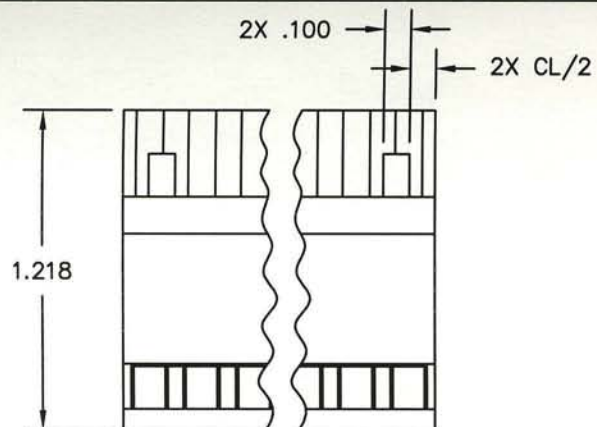

WITHOUT MOUNTING EARS

L=NUM OF POS X CL SPACING

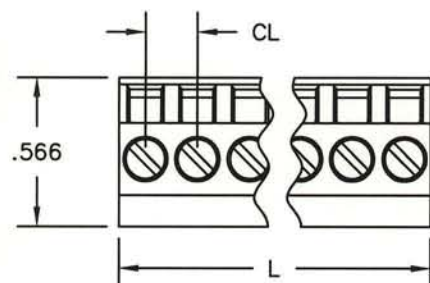

TOP ACCESS

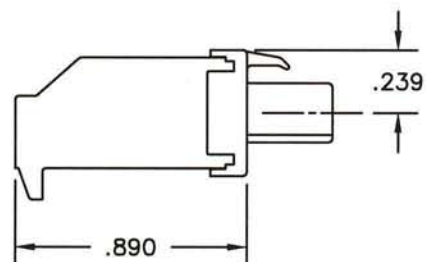

BOTTOM ACCESS

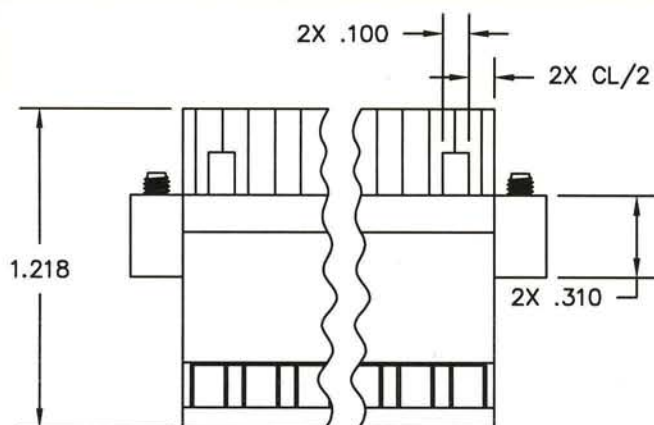
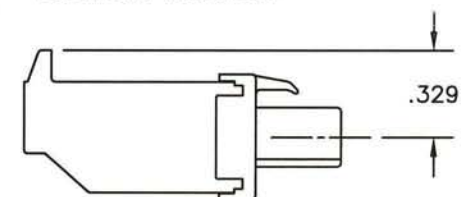

WITH MOUNTING EARS

L=NUM OF POS X CL SPACING

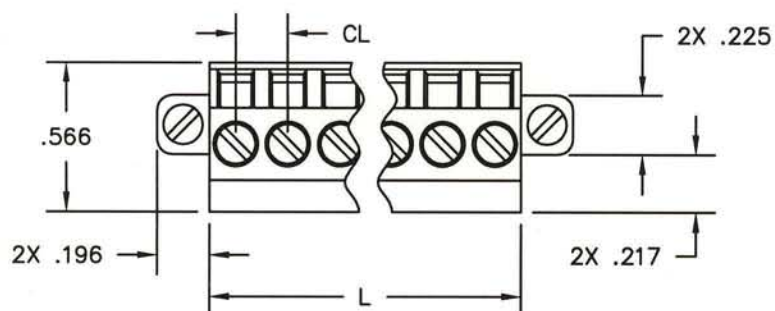

TOP ACCESS

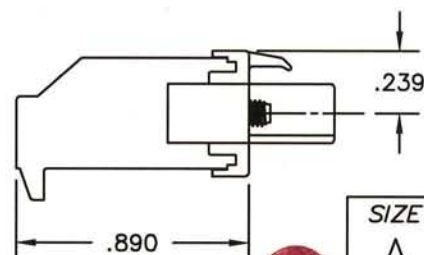

BOTTOM ACCESS

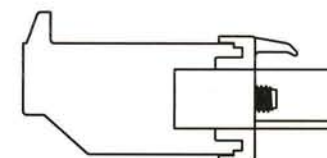

SIZE	DWG NO.	REV
A	ELFF02130	D
CODE: 58982	SCALE: NONE	SHEET 2 OF 2

# Mouser Electronics

Authorized Distributor

Click to View Pricing, Inventory, Delivery & Lifecycle Information:

[Amphenol:](#)

[ELFF03240](#) [ELFF10240E](#)