

CORE OUT

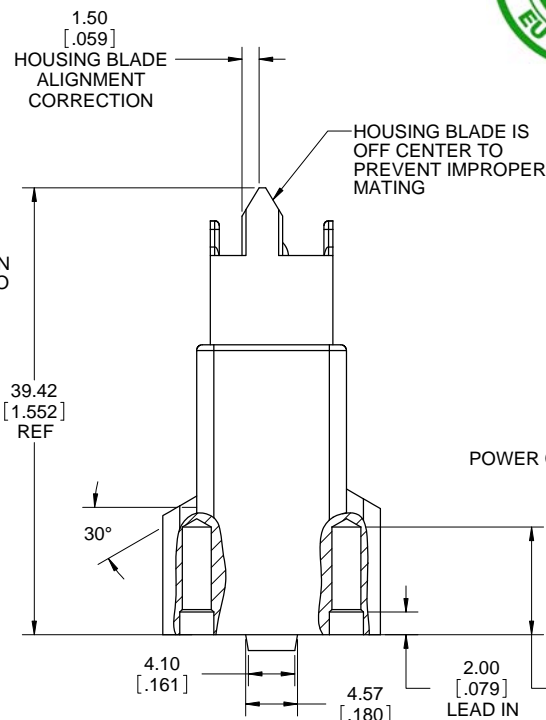

PIN HOUSING

POWER CONTACTS

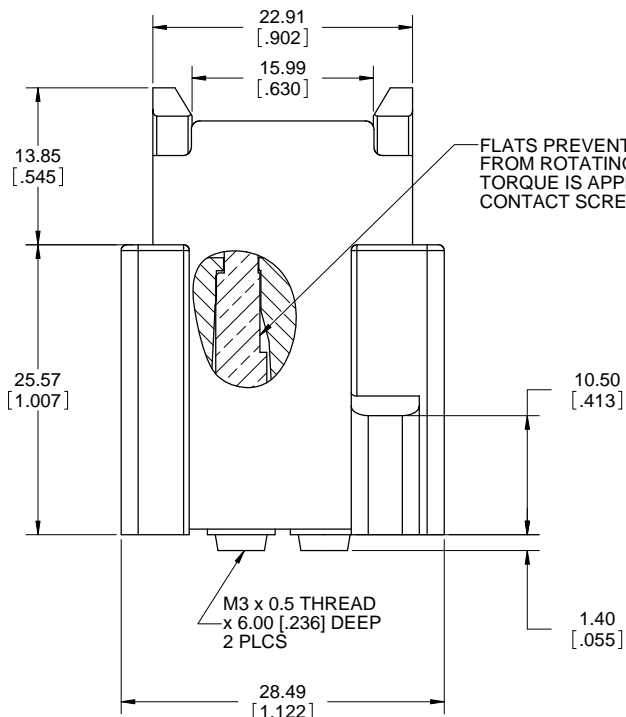
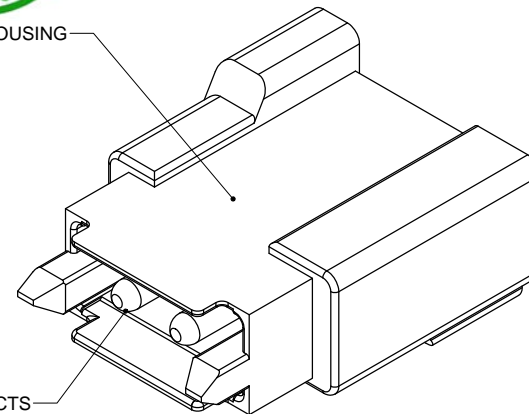

P/N: DWR-T200P-V23X-93

9.50 [.374]
MOUNTING HOLES
FOR THREAD
FORMING SCREW
2 PLCS

NOTES:

- MATERIALS: ALL MATERIALS ARE RoHS COMPLIANT PER EU DIRECTIVE 2002/95/EC AND AMENDMENTS.
 - HOUSING: HIGH TEMPERATURE RESISTANT NYLON, UL FLAMMABILITY RATING 94V-0, COLOUR BLACK
 - POWER CONTACTS: COPPER ALLOY. SEE NOTE 2 FOR PLATING.
- PLATING:
 - FOR P/N DWR-T200P-V233-93, POWER CONTACTS PLATED WITH 0.76µm (30µ") GOLD OVER 1.27µm (50µ") NICKEL
 - FOR P/N DWR-T200P-V236-93, POWER CONTACTS PLATED WITH 5.08µm (200µ") SILVER OVER 1.00µm (39µ") NICKEL
- WHEN MATING WITH SOCKET CONNECTOR P/N DWR-T200S-V23X-91 OR DWR-T200S-V23X-92, THE INSERTION FORCE REQUIRED WILL BE 5 KG MAX. THE WITHDRAWAL FORCE REQUIRED FOR SEPARATION WILL BE 0.7 KG MIN, 3 KG MAX. THE ORDER OF MECHANICAL AND ELECTRICAL ENGAGEMENT IS A) HOUSING BLADES, B) HOUSING SHROUD AND C) POWER CONTACTS.
- THREADED TERMINATION AND BLIND MOUNTING HOLES DESIGNED FOR ASSEMBLY ONTO 1.57mm [.062"] THICK PCB;
0.56 N.m (5 in.lbs) MAXIMUM TORQUE TO BE APPLIED TO CONTACT SCREWS,
1.47 N.m (13 in.lbs) MAXIMUM TORQUE TO BE APPLIED TO THREAD FORMING SCREWS.
- ELECTRICAL CHARACTERISTICS
- CURRENT RATING: 40A PER CONTACT
- OPERATING TEMPERATURE: -55C TO +105C
- DIELECTRIC WITHSTANDING VOLTAGE: 1500VDC
- INSULATION RESISTANCE: 5000 MEGAOHMS
- UL FILE NUMBER: E64911

MOUNTING HOLES STAGGERED
TO PREVENT BACKPLANE
ASSEMBLY ERRORS AND
PROVIDE CLEARANCE FOR
SCREW HEADS

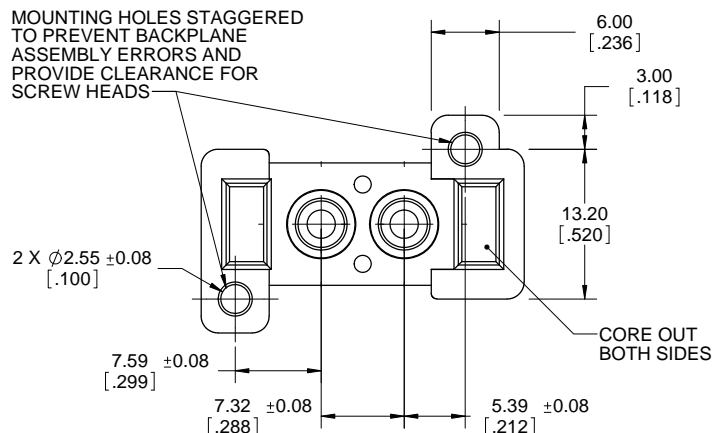

THIS DOCUMENT CONTAINS PROPRIETARY INFORMATION AND SUCH INFORMATION MAY NOT BE DISCLOSED TO OTHERS FOR ANY PURPOSE OR USED FOR MANUFACTURING PURPOSES WITHOUT WRITTEN PERMISSION FROM AMPHENOL CANADA CORP.

UNLESS SPECIFIED OTHERWISE	DRAWN	S.CAELERS	NOV17/10
PRIMARY UNITS MILLIMETERS	CHECKED		
SECONDARY INCHES	M.E. APP'D		
REFERENCE IN PARENTHESES	Q.A. APP'D		
GENERAL TOLERANCES	DWG APPR.		
1 DECIMAL PLACE	ENG. REL. NO.	EAR 13802	
2 DECIMAL PLACES ±0.100	REF.		
3 DECIMAL PLACES	THIRD ANGLE PROJECTION		
ANGULAR DEGREES	DO NOT SCALE DRAWING		

Amphenol Canada Corp.

DWR SERIES SLIM DRAWER, 2 POWER
EXTENDED PIN CONNECTOR, SIZE 10
CONTACTS, SPECIAL .288" PITCH,
THREADED TERMINATION, RoHS COMPLIANT

DWG. NO.	P-DWR-T200P-V23X-93	REV	J
CODE ID NO.	03554	DWG SIZE:	X
SCALE:	2:1	SHEET 1 OF 2	

Mouser Electronics

Authorized Distributor

Click to View Pricing, Inventory, Delivery & Lifecycle Information:

[Amphenol:](#)

[DWR-T200P-V236-93](#)