

REV.	ECN NO.	DATE	SIGN	DESCRIPTION
B	LEN-870145	2008/07/25	Yuri	Update Drawing

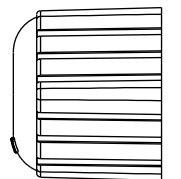

7

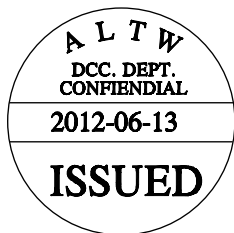
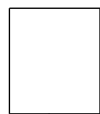

6

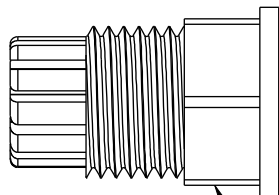

5



4

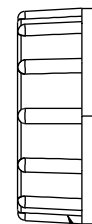

3

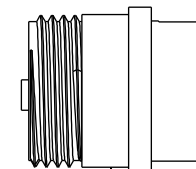

2



1

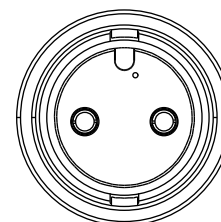
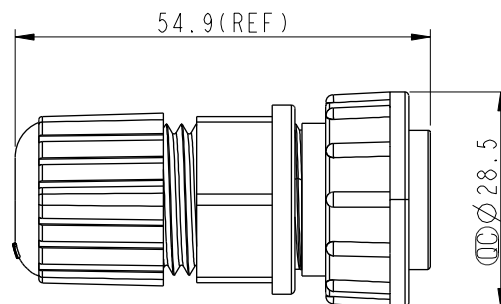
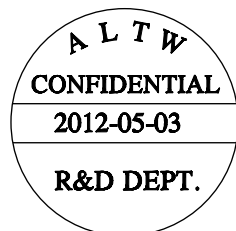

Conn.

Notes:

- * \varnothing Important Dimension To Check.
- * Waterproof Rate: IP67
- * Housing: Black, Nylon+GF
- * Pin: Copper Alloy, Gold Plated
- * Nut: Black, Nylon+GF
- * Δ Gasket: Black, Silicone
- * Ring: Black, EPDM
- * Clamp Ring: Black, Nylon
- * Δ Seals: Black, EPDM
- * Sealing Nut: Black, Nylon
- * Seal For Cable OD: \varnothing 5.5mm~10.8mm
- * One Set Unassembled In One PE Bag

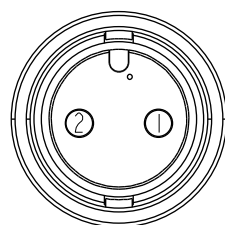
Pin Assignments
Front View

UNIT:mm	
TOLERANCE	
.X	± 0.25
.XX	± 0.1
.XXX	± 0.05
ANGLES	$\pm 1^\circ$

TITLE Large Assy Lock 2Pin F Conn F Pin			
SCALE 1:1	SIZE A4	SHEET 1 OF 1	
REV. B	WC-REV. A.2	\varnothing : Inspection item	

Amphenol LTW
安費諾亮泰企業股份有限公司

ITEM NO DC-02BFFA-LL7001	DRAWN BY SamChang	DATE 2012-05-03
DWG NO DC-02BFFA-LL7001	CHECKED BY Jeffrey	DATE 2012-06-13
CUSTOMER ALTW	APPROVED BY Lion	DATE 2012-06-13

Mouser Electronics

Authorized Distributor

Click to View Pricing, Inventory, Delivery & Lifecycle Information:

[Amphenol:](#)

[DC-02BFFA-LL7001](#)