

used for:	
-----------	--

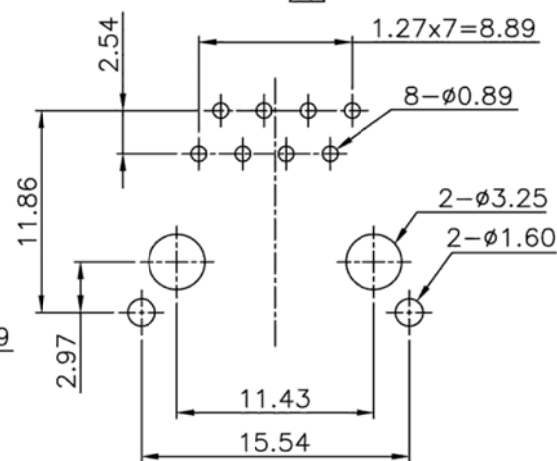
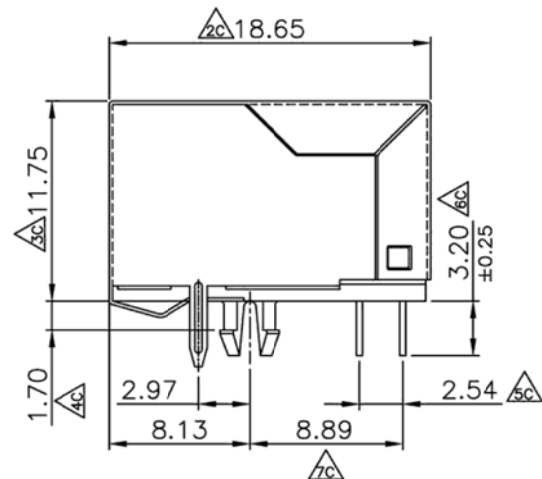
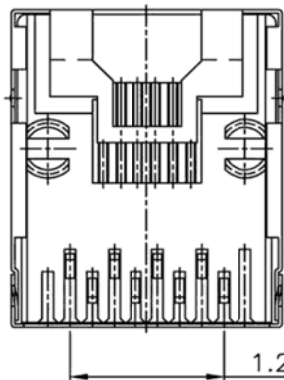
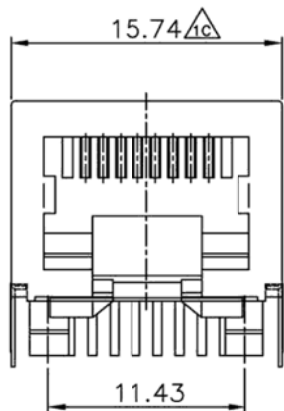

PCB LAYOUT/TOP VIEW

NOTES:

MATERIAL:

SHIELDED: 0.2mm THICKNESS COPPER ALLOY WITH NICKEL PLATED.

HOUSING: PBT+30%GLASS-FIBER UL-94V-0 STANDARD COLOR (BLACK).

INSERT: PBT+30%GLASS-FIBER UL-94V-0,COLOR BLACK.

CONTACT: 0.30mm THICKNESS PHOSPHOR BRONZE,
GOLD PLATING OVER NICKEL IN CONTACT AREA.

TIN PLATING OVER NICKEL IN SOLDER AREA.

Gold Plating: Selective Gold Plating.

**Directive 2002/95/EC
„RoHS“
Compliant**

THIS DRAWING MAY NOT BE COPIED OR REPRODUCED
IN ANY WAY, AND MAY NOT BE PASSED ON TO A THIRD
PARTY WITHOUT WRITTEN PERMISSION.
OWNERSHIP AND COPYRIGHT OF CONEC CORPORATION
DO NOT ALTER CAD DRAWING BY HAND

CONEC CORPORATION
Brampton, Ontario

tolerance unless otherwise specified	Decimal: .XX Angles: .XXX
--	------------------------------



Dim. in mm

scale:

material: SEE NOTES

title:	Modular Jack 8P8C Side Entry Shielded Type
--------	---

drawing no.:	AutoCAD 2004
--------------	--------------

C0502R05A

part no.:	33TS3004S-88B
-----------	---------------

DIN
A3
sheet
1/1



Mouser Electronics

Authorized Distributor

Click to View Pricing, Inventory, Delivery & Lifecycle Information:

[Amphenol:](#)

[33TS3004S-88B](#)