

1. MATERIALS AND FINISHES:  
BODY - BRASS, GOLD PLATING, .000030 INCH [0.0008 MM] THICK OVER COPPER  
CONTACT - BERYLLIUM COPPER, GOLD PLATING, .000030 INCH [0.0008 MM] THICK OVER COPPER  
INSULATOR - PEEK OR LCP, NATURAL

A. IMPEDANCE: 50 OHM  
B. FREQUENCY RANGE: DC - 12 GHz  
C. VSWR(RETURN LOSS): 1.10 (26 dB), MAX. DC-6GHz  
1.20 (21 dB), MAX. 6-12GHz  
D. DIELECTRIC WITHSTANDING VOLTAGE: 500 VRMS. MIN.

A. DURABILITY: 1000 CYCLES MIN.  
B. ENGAGEMENT FORCE: 2 LB [9 N] MAX  
C. DISENGAGEMENT FORCE: 0.5 LB [2 N] MIN  
D. INNER CONTACT RETENTION FORCE: 1.5 LB [7 N] MIN  
E. TEMPERATURE RANGE: -65° C TO 165° C  
F. INSULATOR MATERIAL RATED TO UL94 V-0

A. TRAY PACK  
B. MARKING: AMPHENOL, SMP-MSSB-PCR, DATE CODE

REV	DESCRIPTION	DATE	ECO	APPR
A	RELEASE TO MFG	9/12/05	45722	MY
C	ADDED UL RATING FOR INSULATOR MATERIAL	28-Jul-11	48667	SH
D	OPTIMIZED INSULATOR RETENTION, TRAY PACK WAS SINGLE PACK/RD-DM17051701K2	22-May-17	03722	SS

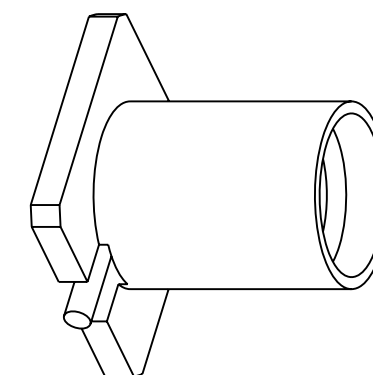

Technical drawing of a cross-section of a mechanical part, labeled "UNPLATED AREA". The drawing shows a square base with a large circular hole in the center. The hole has a diameter of 4.39 [0.173]. The square base has a total width of 6.6 [0.260]. The height of the square base is 3.3 [0.130]. The distance from the top edge of the square to the center of the hole is 2.35 [0.093]. The distance from the bottom edge of the square to the center of the hole is 1.5 [0.059]. The distance from the center of the hole to the bottom edge of the square is 0.99 [0.039]. The distance from the center of the hole to the right edge of the square is 2.01 [0.079]. The drawing is labeled "UNPLATED AREA" with a leader line pointing to the cross-hatched area.

1.26  
[.050]

2.79  
[.110]

5.3  
[.209]

5.99  
[.236]

Ø 4.14  
[.163]

INTERFACE PER  
MIL-STD-348  
SERIES SMP

SECTION B-B

**CUSTOMER OUTLINE DRAWING**  
ALL OTHER SHEETS ARE FOR INTERNAL USE ONLY

UNLESS OTHERWISE SPECIFIED, DIMENSIONS ARE IN METRIC AND TOLERANCES ARE: <0.5mm      0.5 - 6mm      6 - 30mm      30 - 120mm      ANGLES ± 0.05mm      ±0.1mm      ±0.2mm      ± 0.3mm      ±1°	MATERIAL	DRAWN K. SONG	DATE 22-May-17	TITLE ASSEMBLY, PC BOARD, REAR MOUNT SMOOTH BORE	Amphenol RF  www.amphenolrf.com		
NOTICE - These drawings, specifications, or other data (1) are, and remain the property of Amphenol corp. (2) must be returned upon request; and (3) are confidential and not to be disclosed to any person other than those to whom they are given by Amphenol Corp. the furnishing of these drawings, specifications, or other data by Amphenol Corp., or to any other person to anyone for any purpose is not to be regarded by implication or otherwise in any manner licensing, granting rights to permitting such holder or any other person to manufacture, use or sell any product, process or design, patented or otherwise, that may in any way be related to or disclosed by said drawings, specifications, or other data.		ENGINEER OWEN BARTHELMES	DATE 25-Apr-01				
		REFERENCE GEN# ASSYM2.SMP EAR# 283 615X-1690-100 CONFIGURATION LEVEL:	APPROVED S. HSIEH			DATE 22-May-17	SCALE: 12.0:1.0 SHEET    2 OF 2
		FINISH	CAD FILE			DWG SIZE B	REV D
					DRAWING NO. SMP-MSSB-PCR		
					ITEM NO. SMP-MSSB-PCR		
					PART NO. SMP-MSSB-PCR		

# Mouser Electronics

Authorized Distributor

Click to View Pricing, Inventory, Delivery & Lifecycle Information:

[Amphenol:](#)

[SMP-MSSB-PCR](#)