

1. MATERIALS AND FINISHES:
FERRULE - COPPER, GOLD PLATING
RETAINING RING, COVER, HOUSING & BODY - BeCu, GOLD PLATING
CONTACT PIN - BeCu, GOLD PLATING
INSULATOR - PTFE, NATURAL
SPACER - ULTEM, NATURAL

3. ELECTRICAL:
A. IMPEDANCE: 50 OHMS
B. FREQUENCY RANGE: DC - 12 GHz
C. VSWR: -20 dB MIN @ DC - 4 GHz
 -18 dB MIN @ 4 - 12 GHz

4. PACKAGING:
A. QUANTITY: SINGLE PACK
B. MARKING: BAG TO BE MARKED
"AMPHENOL RF, SMP-FR-C08-NM AND DATE CODE"
C. CAP, REAR INSULATOR, SPACER AND FERRULE ARE PACKAGED LOOSE

5
[.197] REF

4.39
[.173] REF

SOLDER MUST NOT PROTRUDE ABOVE CONTACT END SURFACE (SEE NOTE 2D)

0.89
[.035] REF

1.91
[.075] REF

— INTERFACE PER
MIL-STD-348
SERIES: SMP JACK

NOTICE: These drawings, specifications, or other data (1) are, and remain the property of Amphenol corp (2) must be returned upon request; and (3) are confidential and not to be disclosed to any person other than those to whom they are given by Amphenol Corp. The furnishing of these drawings, specifications, or other data by Amphenol Corp., or to any other person to anyone for any purpose is not to be regarded by implication or otherwise in any manner licensing, granting rights to permitting such holder or any other person to manufacture, use or sell any product, process or design, patented or otherwise, that may in any way be related to or disclosed by said drawings, specifications, or other data.

THIRD ANGLE PROJ.		REFERENCE SMP-FR-C08-2	EAR# 8889
-------------------	---	---------------------------	--------------

UNLESS OTHERWISE SPECIFIED
DIMENSIONS ARE METRIC [INCHES] AND TOLERANCES ARE:

<0.5mm = ±0.05mm	[<0.020 = ±0.002]
0.5 - 6mm = ±0.1mm	[0.020 - 0.236 = ±0.004]
>6.00 - 30mm = ±0.2mm	[0.236 - 1.181 = ±0.008]
>30.00 - 120mm = ±0.3mm	[1.181 - 4.725 = ±0.012]

ANGLES = $\pm 1^\circ$

MATERIAL		
ENGR.1 S.VO	ENGR.2 JACK LIANG	DATE 01-OCT-20

TITLE	
SMP R/A JACK FOR RG-316 CABLE, NON-MAGNETIC	
SHEET NO. 2 OF 2	SCALE: 8.0:1.0

Amphenol RF		
SIZE B	DRAWING NO.	SMP-FR-C08-NM
	ITEM NO.	SMP-FR-C08-NM
	PART NO.	SMP-FR-C08-NM
		REV A

REVISIONS				
REV	DESCRIPTION	DATE	ECN	BY
A	RELEASE TO MFG.	12-AUG-22	16294	SH

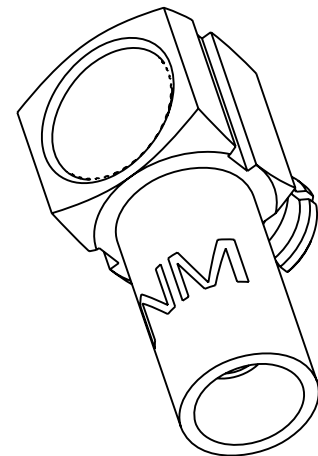
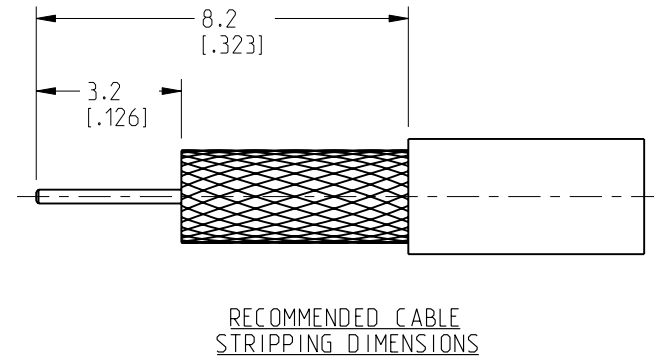
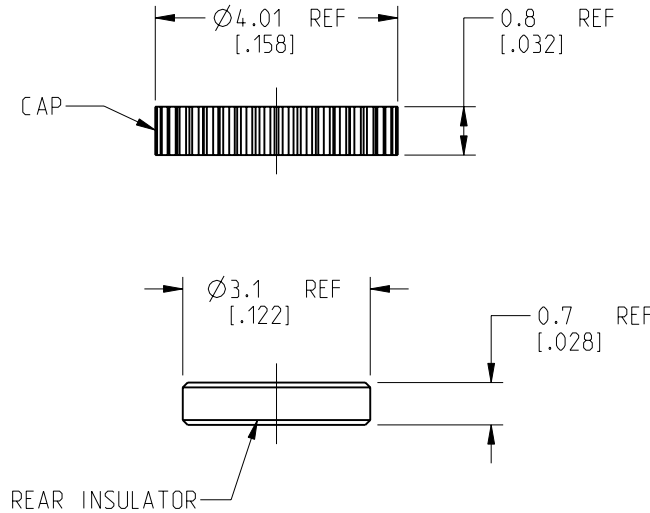

SCALE 5.000

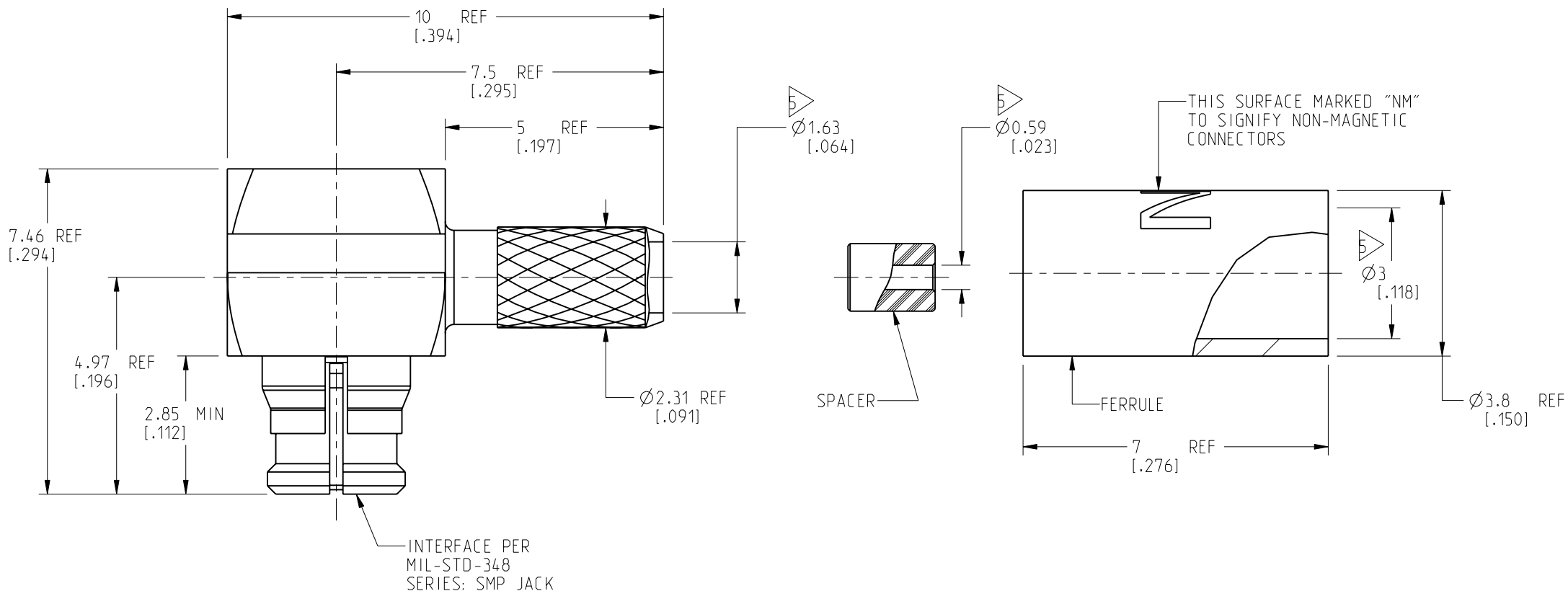

CUSTOMER OUTLINE DRAWING

ALL OTHER SHEETS ARE FOR INTERNAL USE ONLY

Mouser Electronics

Authorized Distributor

Click to View Pricing, Inventory, Delivery & Lifecycle Information:

[Amphenol:](#)

[SMP-FR-C08-NM](#)