

NOTES:

1. MATERIALS AND FINISHES:
BODY & WASHER - BRASS, SILVER PLATING
CONTACT - PHOSPHOR BRONZE, GOLD PLATING
INSULATOR - PTFE, NATURAL

5. CABLE ASSEMBLY INSTRUCTIONS:

A. TRIM CABLE AS SHOWN.
B. SLIDE FERRULE ONTO THE CABLE.

THIRD ANGLE PROJ. 

REVISIONS				
REV	DESCRIPTION	DATE	ECO	APPR
--	RELEASE TO MFG.	--	--	--
L	REDRAWN IN PRO-E, WASHER UPDATED	26-Oct-16	2244	KR

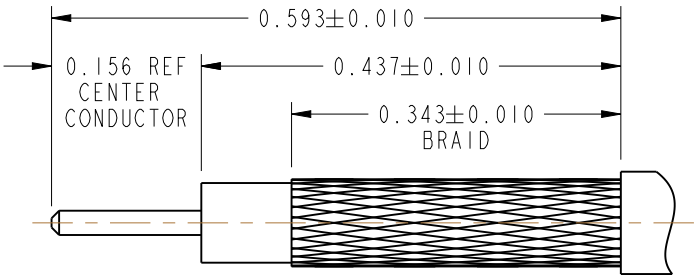
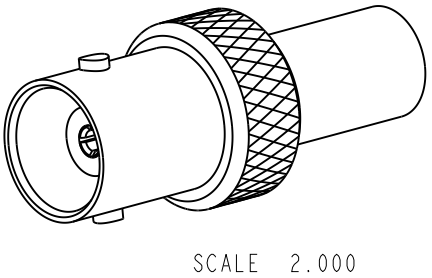

RECOMMENDED CABLE STRIPPING DIMENSIONS

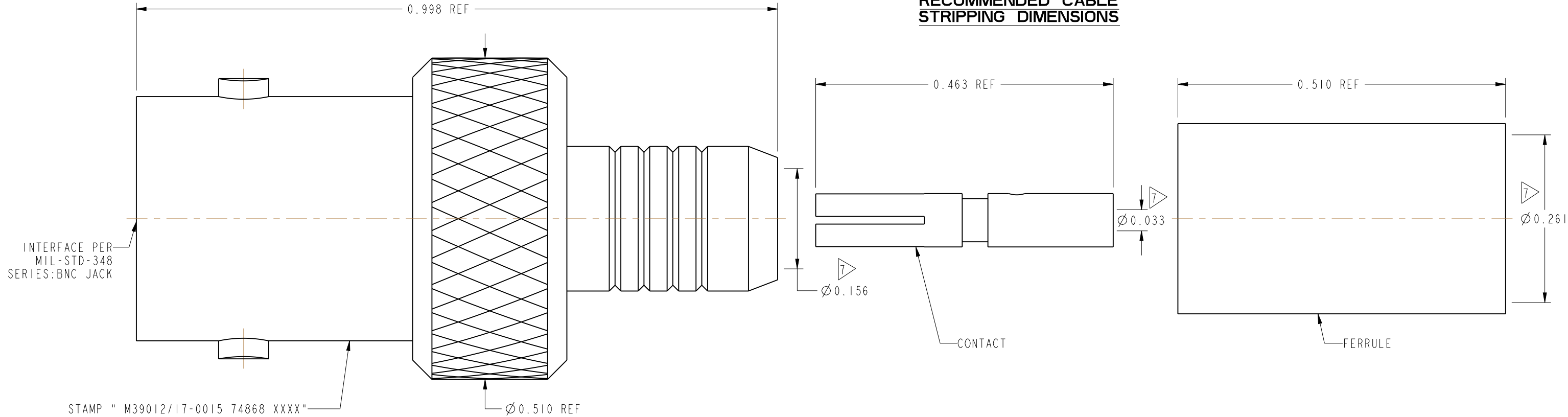

MIL-C-39012 INSPECTION

CUSTOMER OUTLINE DRAWING

ALL OTHER SHEETS ARE FOR INTERNAL USE ONLY

UNLESS OTHERWISE SPECIFIED, DIMENSIONS ARE IN INCHES AND TOLERANCES ARE: 2 PLACE DECIMAL 3 PLACE DECIMAL ANGLES ±.015 (0,381 mm) ±.005 (0,127 mm) ± 1° NOTICE - These drawings, specifications, or other data (1) are, and remain the property of Amphenol corp. (2) must be returned upon request; and (3) are confidential and not to be disclosed to any person other than those to whom they are given by Amphenol Corp. the furnishing of these drawings, specifications, or other data by Amphenol Corp., or to any other person to anyone for any purpose is not to be regarded by implication or otherwise in any manner licensing, granting rights to permitting such holder or any other person to manufacture, use or sell any product, process or design, patented or otherwise, that may in any way be related to or disclosed by said drawings, specifications, or other data.	MATERIAL	DRAWN	DATE	TITLE		Amphenol RF www.amphenolrf.com	
	SEE NOTES	KARTHIK R	21-Jan-14				
		ENGINEER	DATE	BNC STR JACK MIL-CRIMP (CATEGORY 'C') FOR RG 59/U, 62/U, 140/U & 210/U CABLES			
		D.ROYCE	06-Oct-89				
		REFERENCE	APPROVED	DATE	SCALE: 6.6:1.0		SHEET 2 OF 2
MIL-C-39012/17-0015 & EPA 802206-51	K.CAPOZZI	26-Oct-16					
CONFIGURATION LEVEL: In Work	CAD FILE	DWG SIZE		REV			
FINISH						B	
						PART NO.31-4328	
						ITEM NO.	
						DRAWING NO.	

Mouser Electronics

Authorized Distributor

Click to View Pricing, Inventory, Delivery & Lifecycle Information:

[Amphenol:](#)

[031-4328](#)